

WEBB ROAD

WATERFRONT ADDITION

WATERFRONT ADDITION

WATERFRONT PARKWAY

UNPLATTED

AREA 'C' MATCHLINE
AREA 'B'

SITE ELECTRICAL NOTES:

1. CONTRACTOR IS RESPONSIBLE FOR COORDINATING ALL UTILITY SERVICES. FAILURE TO DO SO WILL NOT RESULT IN ANY EXTRA FINANCIAL COMPENSATION FROM THE OWNER. CONTRACTOR SHALL HAVE ALL UTILITY SERVICE REQUIRED EXPENSES IN THE BASE BID.
2. NOT USED
3. MIN. CONDUCTOR SIZE #10. MIN. CONDUIT SIZE 1"
4. THE CONTRACTOR SHALL COORDINATE POLE BASE INSTALLATION WITH ALL UTILITIES IN THE AREA. COORDINATE TRENCHING WITH MKEC ENGINEERING CONSULTANTS, INC. LANDSCAPE ARCHITECT TO AVOID TREE SPADE INTERFERENCE. SEE DETAIL 1 ON SHEET 2 OF 5.
5. CUTTING OF PAVEMENT OR CONCRETE IS NOT ALLOWED. DIRECTIONAL BORE AS REQUIRED. REQUIRED BORING SHALL BE SUBSIDIARY TO TRENCHING.
6. EXISTING TREES ARE AN IMPORTANT ASSET TO THIS DEVELOPMENT. CONTRACTOR SHALL NOT TRENCH UNDER TREE DRILLINES. COORDINATE CONFLICTS W/ OWNER'S REPRESENTATIVE.
7. NOTE LOCATION OF CONDUIT BEHIND AND ALONG CURB.
8. DEVELOPER TO PROVIDE LIGHT FIXTURES, POLES AND ANCHOR BOLTS. COORDINATE WITH DEVELOPER. CONTRACTOR TO MAKE ALL CONNECTIONS AND INSTALLATIONS PER MANUFACTURER'S RECOMMENDATIONS.

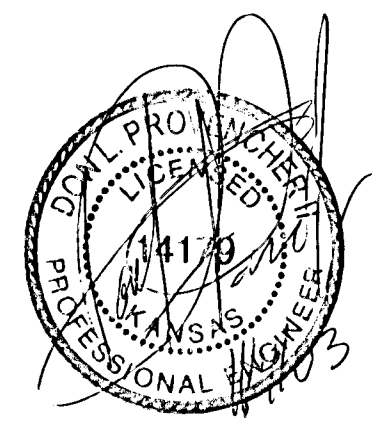
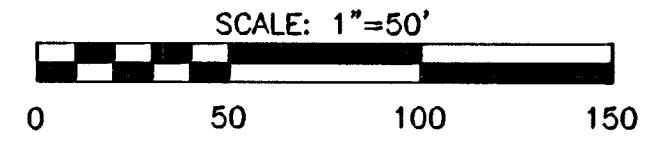
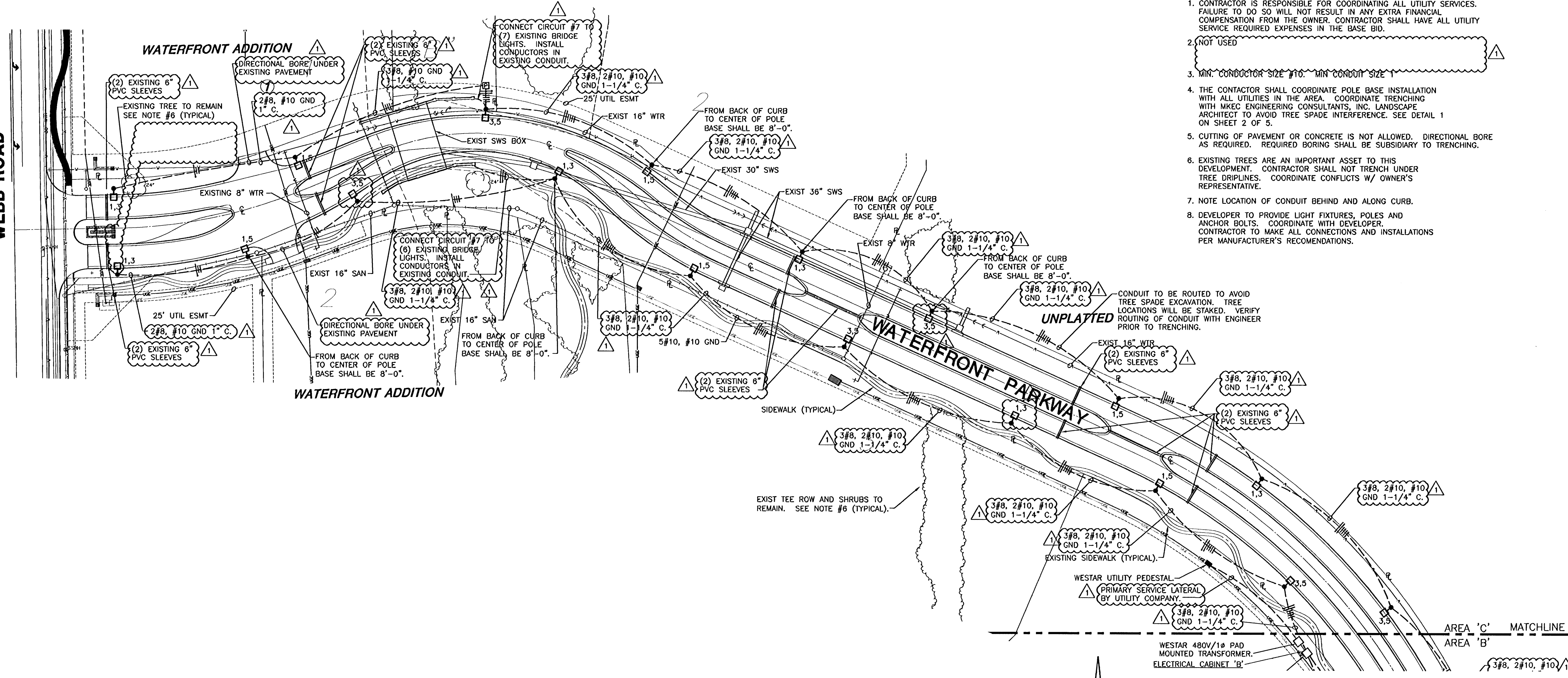

MKEC ENGINEERING CONSULTANTS
411 N. WEBB ROAD
WICHITA, KS. 67206
316 - 884 - 9400

THE WATERFRONT ROADWAY LIGHTING
PROJECT NAME

SITE LIGHTING PLAN AREA 'C'
SHEET TITLE

DESIGN BY: JAF	DRAWN BY: JAF	CHECKED BY: DLP
DATE: AUGUST 2003	JOB NO.: 02014	SHEET/OF: 4/5