

File: L:\2023\F02-2301675 - Wichita Downtown Park Restrooms\CAD\_BIM\_Sheets\A. Price Woodard\WDRA\_CU101-UTILITY PLAN.dwg Last Save: 5/20/2024 3:03 PM Last saved by: BD Thomas  
 Last plotted by: Thomas, Brent D. Plot Style: AEC\_B&W.ctb Plot Scale: 1:1 Plot Date: 9/9/2024 5:37 PM Plotter used: DWG To PDF.pc3

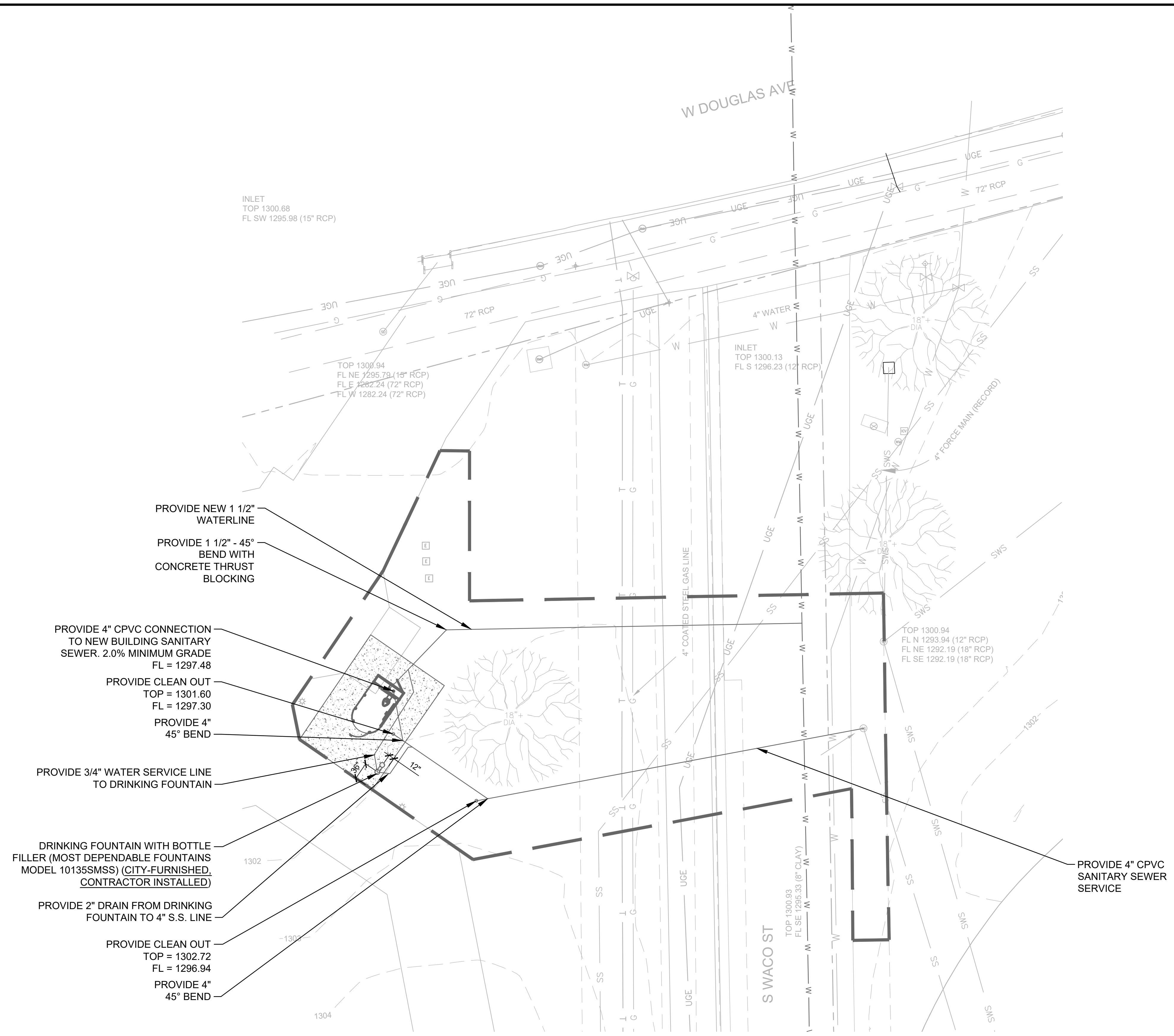

**1** UTILITY PLAN  
 SCALE: 1" = 10'

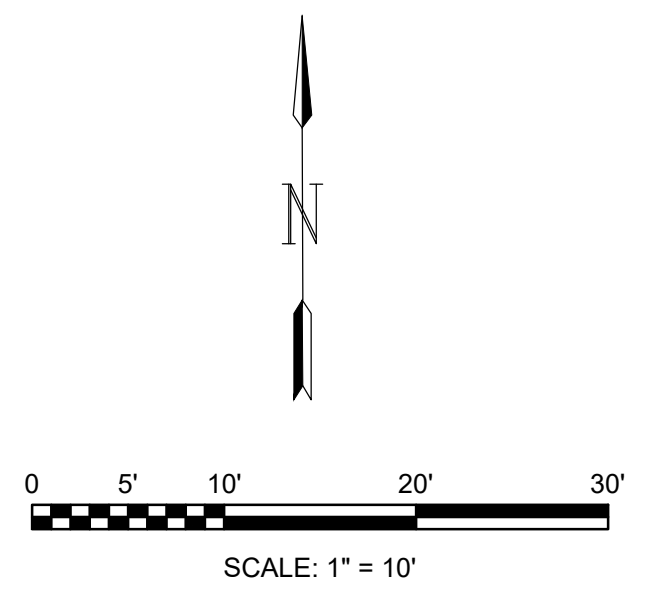

© 2023 GARVER, LLC  
 THIS DOCUMENT, ALONG WITH THE IDEAS AND DESIGNS CONVEYED HEREIN, SHALL BE CONSIDERED INSTRUMENTS OF PROFESSIONAL SERVICE AND ARE PROPERTY OF GARVER, LLC. ANY USE, REPRODUCTION, OR DISTRIBUTION OF THIS DOCUMENT, ALONG WITH THE IDEAS AND DESIGN CONTAINED HEREIN, IS PROHIBITED UNLESS AUTHORIZED IN WRITING BY GARVER, LLC OR EXPLICITLY ALLOWED IN THE GOVERNING PROFESSIONAL SERVICES AGREEMENT FOR THIS WORK.

1995 Midfield Road  
 Wichita, KS 67209  
 (316) 264-8008



REV.	DATE	DESCRIPTION	BY

**CITY OF WICHITA**  
 DEPT. OF PARKS AND RECREATION  
 WICHITA, KS 67202

2024 PARK FACILITY  
 ENHANCEMENTS-  
 A. PRICE WOODARD  
 RESTROOMS PROJECT

UTILITY PLAN

JOB NO.: F02-2301675  
 DATE: FEB. 2024  
 DESIGNED BY: SRS  
 DRAWN BY: CJW

BAR IS ONE INCH ON ORIGINAL DRAWING  
 IF NOT ONE INCH ON THIS SHEET, ADJUST SCALES ACCORDINGLY.

DRAWING NUMBER  
**CU101**

SHEET NUMBER  
**8**