

BENCHMARK:
 BM #2 - Chiseled "+" Located in the Northeast Corner of the Intersection of Wabash and 1st Street North, 30.0' East and 34.8' North of the Centerline of Both. Elev. = 1295.76 (MSL)

SCALE: 1" = 20'

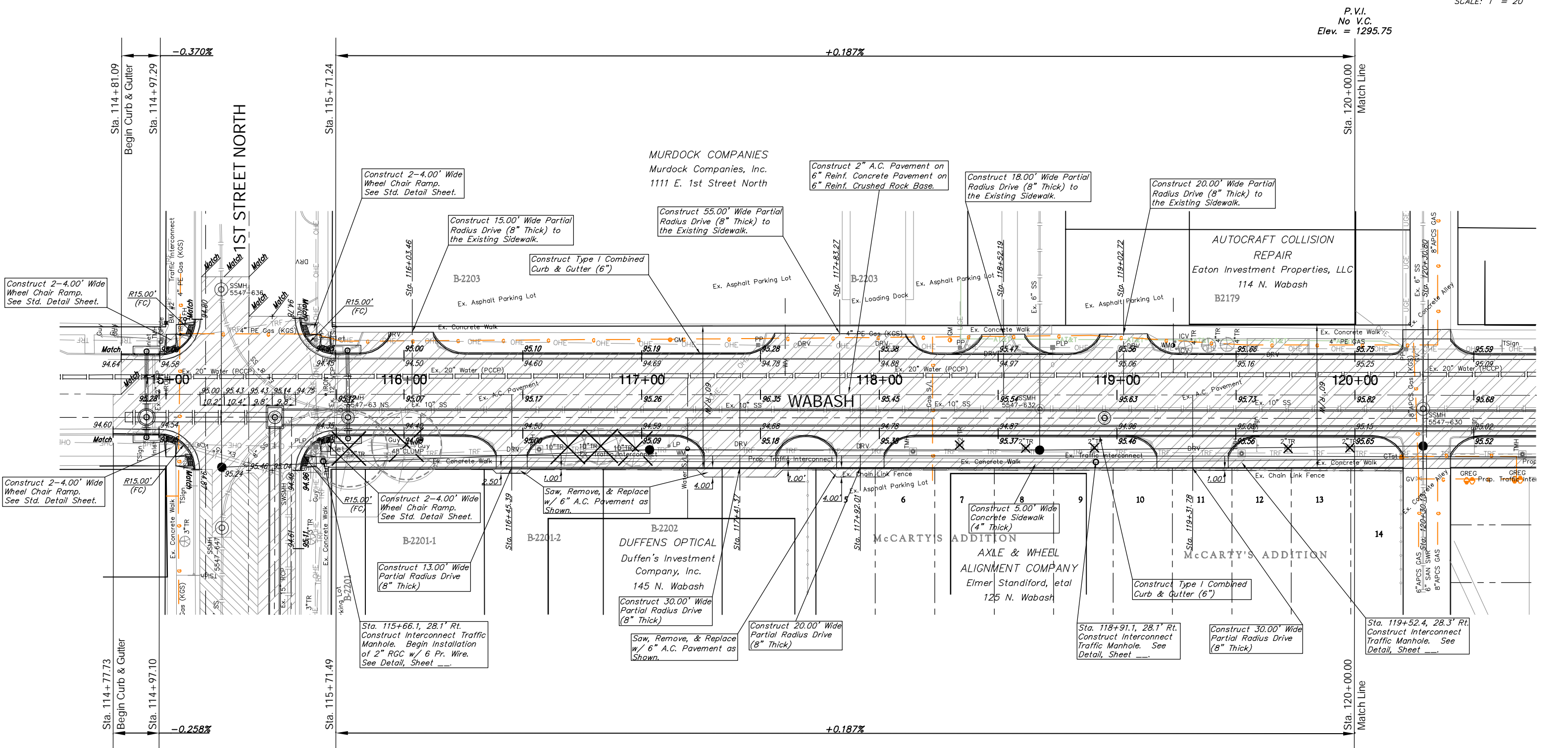

Construct 2-4.00' Wide Wheel Chair Ramp. See Std. Detail Sheet.

Construct 2-4.00' Wide Wheel Chair Ramp. See Std. Detail Sheet.

Construct 2-4.00' Wide Wheel Chair Ramp. See Std. Detail Sheet.

Construct 15.00' Wide Partial Radius Drive (8" Thick) to the Existing Sidewalk.

Construct 55.00' Wide Partial Radius Drive (8" Thick) to the Existing Sidewalk.

Construct 2" A.C. Pavement on 6" Reinf. Concrete Pavement on 6" Reinf. Crushed Rock Base.

Construct 18.00' Wide Partial Radius Drive (8" Thick) to the Existing Sidewalk.

Construct 20.00' Wide Partial Radius Drive (8" Thick) to the Existing Sidewalk.

Construct 2-4.00' Wide Wheel Chair Ramp. See Std. Detail Sheet.

Construct 13.00' Wide Partial Radius Drive (8" Thick)

Saw, Remove, & Replace w/ 6" A.C. Pavement as Shown.

Construct 30.00' Wide Partial Radius Drive (8" Thick)

Construct 20.00' Wide Partial Radius Drive (8" Thick)

Construct 5.00' Wide Concrete Sidewalk (4" Thick)

Construct Type I Combined Curb & Gutter (6")

Construct 30.00' Wide Partial Radius Drive (8" Thick)

Construct Interconnect Traffic Manhole. See Detail, Sheet ...

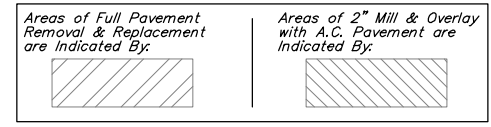

The Contractor shall install a 2" RGC Interconnect along Wabash from 1st Street North to Douglas. See the Marking & Signing Detail Sheet for more information. Cost of the material and installation to be INCIDENTAL to the Bid Item "Traffic Signal Interconnect".

Note:
 Trees/Shrubs to be removed are marked thus:

Drawing File: E:\eng\Old Town Drainage\Land\dtg\OTD Base.dwg (PAV03)
 Design: TPV/KK
 Date: SS/TPV
 Approved: TPV
 Project No. 05-05-E258 CITY OF WICHITA, KANSAS

WABASH PAVING PLAN
 DOUGLAS AVENUE DRAINAGE OUTFALL PROJECT

Baughman Company, P.A.
 315 Ellis St. Wichita, KS 67211 P 316-262-7271 F 316-262-0149
 ENGINEERING | SURVEYING | PLANNING | LANDSCAPE ARCHITECTURE