

BENCHMARK:
 BM #6 - City of Wichita Disc Located on the Northwest Corner
 of the Traffic Signal Base in the Southwest Corner of
 the Intersection of Douglas and Hydraulic.
 Elev. = 1296.32 (MSL)

SCALE: 1" = 20'

SCALE: 1" = 20'

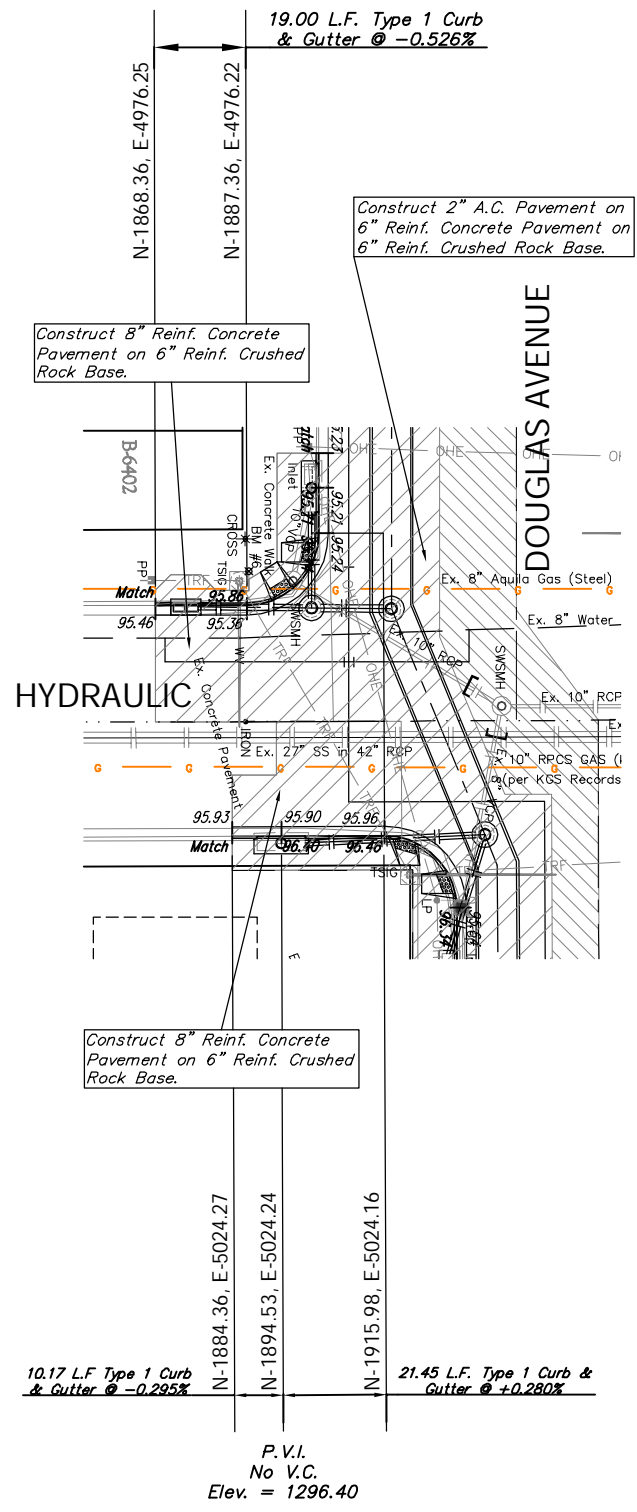
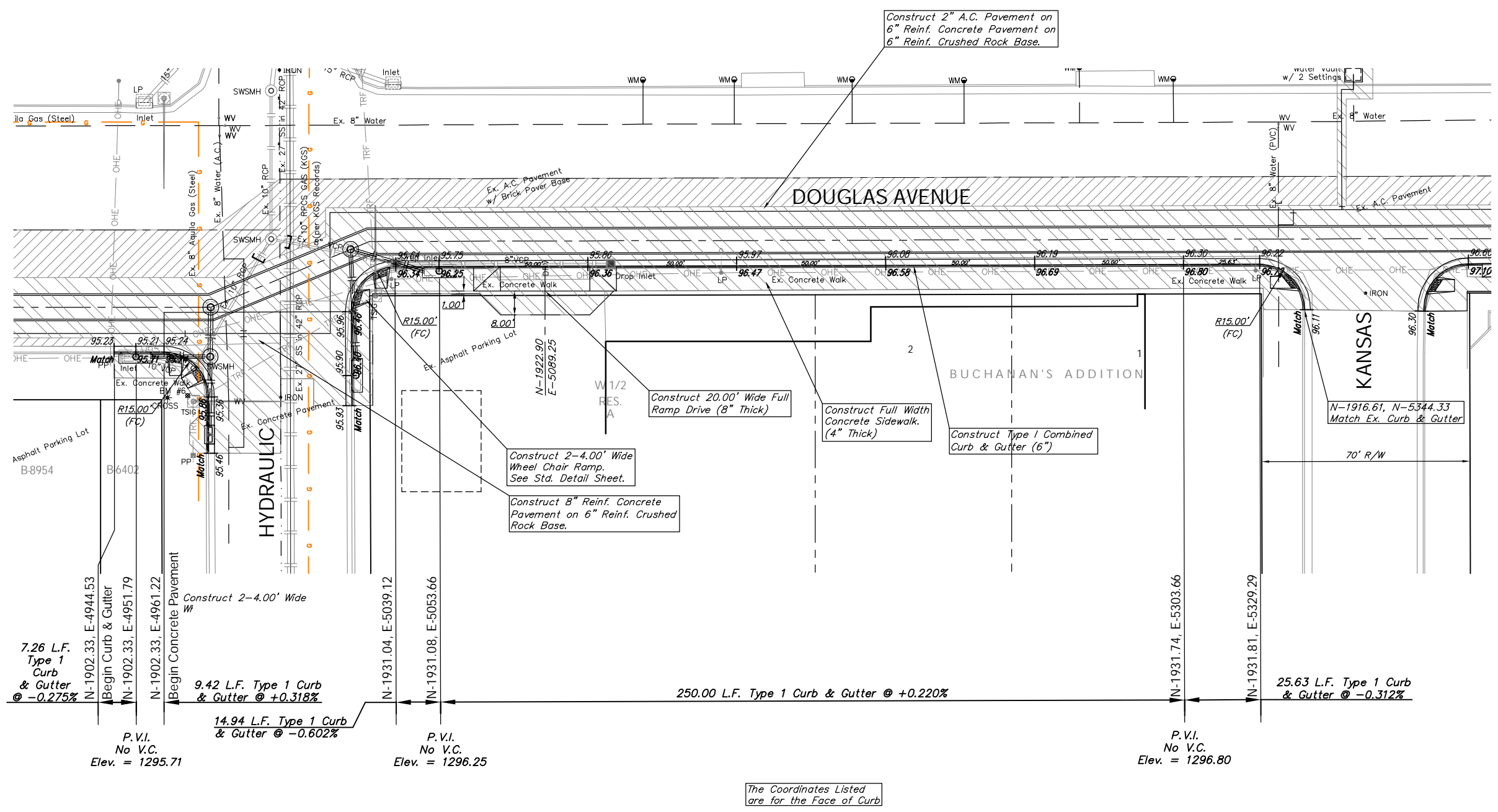

The Coordinates Listed are for the Face of Curb

Areas of 2" Mill & Overlay with A.C. Pavement are by

Drawing File: E:\eng\Old Town Drainage\Land\dtg\OTD Base.dwg (Par05)
 Design: TPV
 Date: SS/TPV
 Approved: TPV
 1 NOTED

Project No. 05-05-E258 CITY OF WICHITA, KANSAS
DOUGLAS AVENUE PAVING PLAN
 HYDRAULIC TO KANSAS
 DOUGLAS AVENUE DRAINAGE OUTFALL PROJECT

Baughman Company, P.A.
 315 Ellis St. Wichita, KS 67211 P 316-262-7271 F 316-262-0149
 ENGINEERING | SURVEYING | PLANNING | LANDSCAPE ARCHITECTURE

July 2007
 SHEET
 53
 OF
 87