

WOODLAWN

STRAITFORD

ARMOUR

6418 E.  
12th St.

12TH

MH # 5948-387  
Approx depth = 10.2 ft

Point Repair:  
Remove and replace 53 lf of 8" pipe from  
MH 5948-386 to 53 lf northwest of said manhole.  
(includes one tap replacement)

WHITFIELD

MH # 5948-386  
Replace Manhole Frame & Cover  
Approx depth = 8.6 ft

6613 E.  
11th St.

11TH

MH # 5948-379

MH # 5948-380  
Replace Manhole Frame & Cover  
(see note on tv log)  
Approx depth = 11.6 ft

10TH

MAGILL

**SITE 4**  
Map 1 of 2

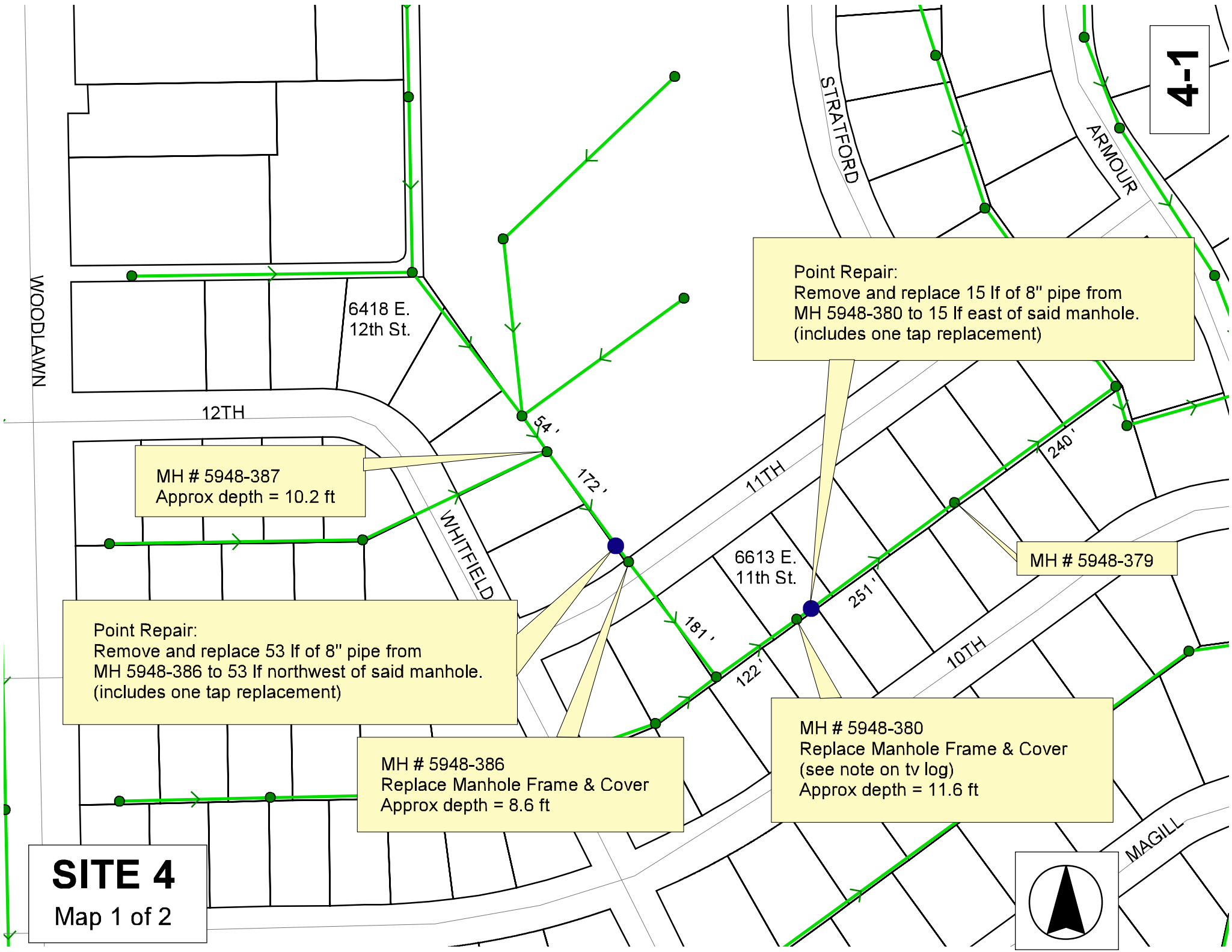
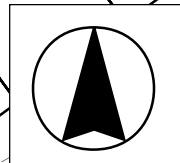

4-2

NOTE: The easement has a lot of large trees. Contractors should review the Site prior to bidding. (easement is 16' wide, centered on the property line)

MH # 5948-374  
Replace Manhole Frame & Cover  
Approx depth = 7.2 ft

Remove and Replace 240 lf of 8" Pipe

MH # 5948-379  
Replace Manhole Frame & Cover  
Approx depth = 7.5 ft

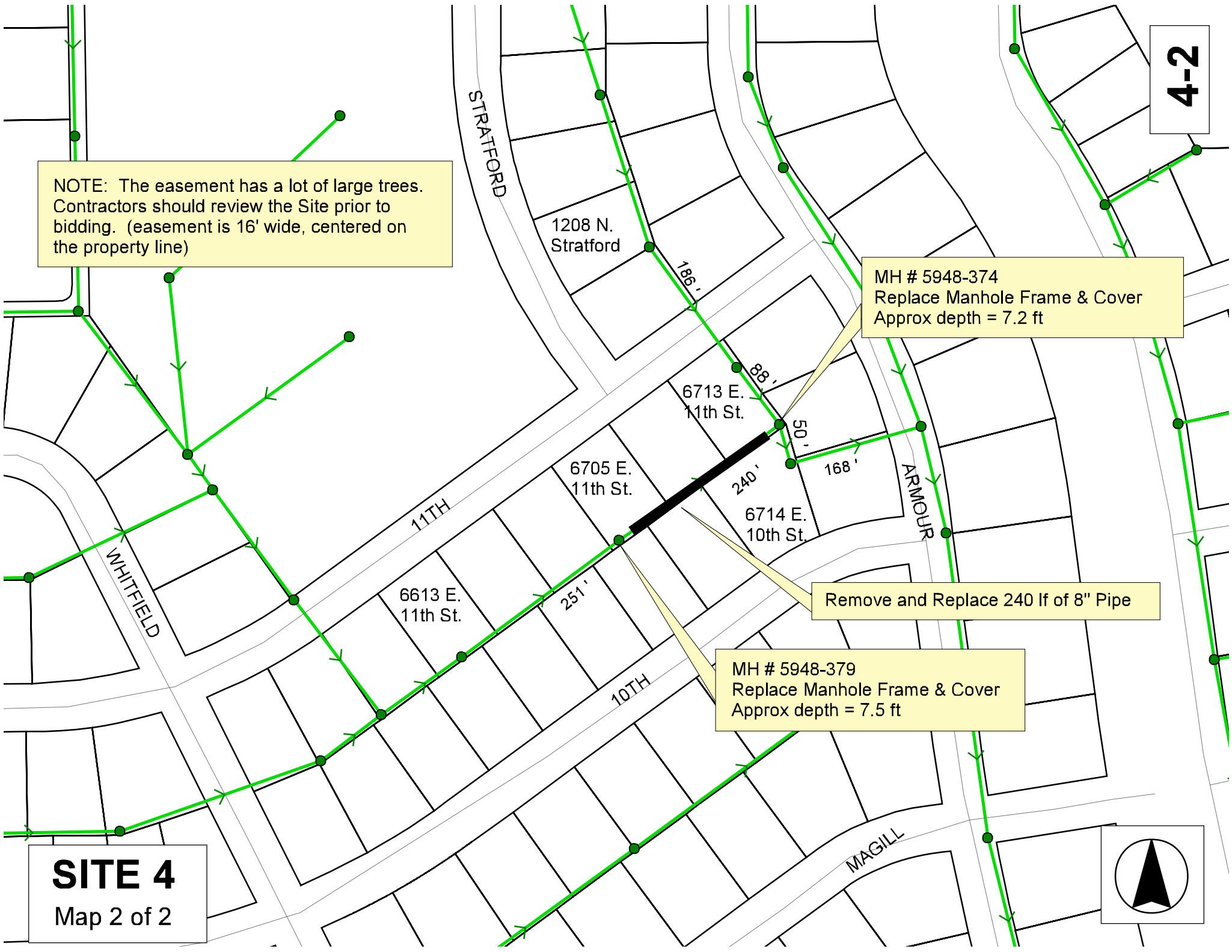

**SITE 4**  
Map 2 of 2

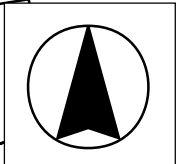



# Television Inspection Master Report

5/11/2007  
10:14 AM

US Structure: 5948-387      1206 N WHITFIELD ST      Date Insp: 8/7/2006      Basin: E03B  
DS Structure: 5948-386      1202 N WHITFIELD ST      Dir Televised: Upstream To Downstream

## Pipe Information

Shape: Round      Length Status:      Project No.: J-033  
Dia/Ht Width: 8      0      Material: VCP      Index:  
Length: 171.3      Slope: 0.199      Surface:

## Inspection Information

Crew: 694      Percent Full:      Tape ID: DVD #0181  
Weather: Cloudy      Purpose: TV Existing Line      Counter Start:  
Normal Flow

Obs. #	VTR Counter	Distance	Location	Description	Rating	Obsrvd (gpm)	Est. (gpm)	Ratings Struct	Clean	Remain (gpm)
1		0.0	US Manhole	5948-387	1		0.000	0	0	0.000
2		8.2	Start	Sag begins	3		0.000	5	0	0.000
4		27.1	Lower Right	Broken Pipe	4		0.000	0	0	0.000
PIECES MISSING										
3		27.2	End	Sag Ends	1		0.000	1	0	0.000
5		50.6	Start	Sag begins	2		0.000	2	0	0.000
6		51.6	Lower Left	Grease	3		0.000	0	5	0.000
7		59.0	End	Sag ends	1		0.000	1	0	0.000
8		65.3	West	Wye Service	3		0.000	0	0	0.000
OFFSET FIRST JOINT INSIDE CONNECTION      1206 NORTH WHITFIELD										
9		77.8	Start	Sag begins	3		0.000	5	0	0.000
10		103.0	Upper Left	Grease	3		0.000	0	5	0.000
11		115.6	End	Sag ends	1		0.000	1	0	0.000
<b>POINT REPAIR:</b>										
12		139.8	Upper Left	Grease	4		0.000	0	10	0.000
13		147.6	Upper Left	Grease	3		0.000	0	5	0.000
14		150.5	Start	Sag begins	3		0.000	5	0	0.000
15		153.6	West	Wye Service	3		0.000	0	0	0.000
GREASE AROUND CONNECTION      1202 NORTH WHITFIELD (located within the sag area)										
16		155.1	Camera Lens Submerged		4		0.000	10	0	0.000
17		166.3	Camera Lens Emerged		2		0.000	2	0	0.000
Camera is pushing up a lot of silt from inside the sag area										
18		169.9	Crown	Crack-Horizontal	3		0.000	0	0	0.000
19		170.9	Upper Left	Broken Pipe	3		0.000	0	0	0.000
20		171.4	End	Sag ends	2		0.000	2	0	0.000
Grade is good at the manhole										
21		172.4	DS Manhole	5948-386	1		0.000	0	0	0.000

**Replace the pipe from 119' to the downstream manhole to correct the grade. (other sags noted are not that bad)**

Pipe is located on the west side of the school parking lot, in the grass.  
Easement has 2 trees over the pipe and a fence that crosses the repair area.

4-4

# Television Inspection Master Report

5/11/2007  
10:14 AM

US Structure: 5948-380                      6613 E 11TH ST                      Date Insp: 12/2/2005                      Basin: E03B  
 DS Structure: 5948-379                      6705 E 11TH ST                      Dir Televised: Upstream To Downstream

## Pipe Information

Shape: Round                      Length Status:                      Project No.: I-171  
 Dia/Ht Width: 8                      0                      Material: VCP                      Index:  
 Length: 251.2                      Slope: 0.195                      Surface:

## Inspection Information

Crew: 690                      Percent Full:                      Tape ID: V-4946  
 Weather: Sunny                      Purpose: TV Existing Line                      Counter Start:

Obs. #	VTR Counter	Distance	Location	Description	Rating	Obsrvd (gpm)	Est. (gpm)	Ratings Struct	Clean	Remain (gpm)
1	33:07	0.0	US Manhole	5948-380	1		0.000	0	0	0.000
<b>NOTE: This manhole has been raised once before and the stack is very tall. Contractor will need to reconstruct the top 1/2 of the manhole to bring it into city spec</b>										
2	34:01	4.0	Sag begins North	Break-In Conn	1		0.001	0	0	0.001
<b>6613 E 11TH ST N CONNECTION NEEDS REPAIR (broken pipe &amp; roots)</b>										
3	35:01	7.8	Quad 2 / L-Rt	Sag / Submerged	4		0.000	10	0	0.000
4	35:21	14.5	Quad 2 / L-Rt	Sag / Emerged	1		0.000	1	0	0.000
<b>POINT REPAIR: REPLACE THE UPSTREAM 15 LF OF PIPE, INCLUDING 1 TAP</b>										
5	36:41	38.7	South	Break-In Conn	1		0.001	0	0	0.001
<b>6618 E 10TH ST N</b>										
6	37:05	46.7	South	Wye Service / Sealed Off	1		0.000	0	0	0.000
7	37:17	48.9	North	Wye Service / Sealed Off	1		0.000	0	0	0.000
8	37:20	48.9	Quad 2 / L-Rt	Sag begins	4		0.000	10	0	0.000
9	37:29	51.6	Quad 2 / L-Rt	Sag ends	1		0.000	1	0	0.000
10	38:24	61.1	North	Break-In Conn	1		0.001	0	0	0.001
<b>6617 E 11TH ST N</b>										
11	39:04	78.8	Quad 2 / L-Rt	Sag (at camera level)	3		0.000	5	0	0.000
12	39:19	83.0	Quad 2 / L-Rt	Sag ends	1		0.000	1	0	0.000
13	41:30	146.8	South	Wye Service / Sealed Off	1		0.000	0	0	0.000
14	41:46	148.0	North	Wye Service / Sealed Off	1		0.000	0	0	0.000
15	42:46	164.0	South	Break-In Conn	1		0.001	0	0	0.001
<b>6702 E 10TH ST N</b>										
16	43:11	173.5	Quad 2 / L-Rt	Sag (at camera level)	4		0.000	10	0	0.000
17	43:34	182.6	Quad 2 / L-Rt	Sag ends	1		0.000	1	0	0.000
18	44:44	203.9	North	Break-In Conn	1		0.001	0	0	0.001
<b>6701 E 11TH ST N</b>										
19	44:56	206.1	Quad 2 / L-Rt	Sag begins	4		0.000	10	0	0.000
20	45:04	207.3	Quad 2 / L-Rt	Sag ends	1		0.000	1	0	0.000
21	45:25	214.3	South	Wye Service / Sealed Off	1		0.000	0	0	0.000
22	47:13	247.6	DS Manhole	5948-379	1		0.000	0	0	0.000

4-5

# Television Inspection Master Report

5/11/2007  
10:14 AM

US Structure: 5948-379      6705 E 11TH ST      Date Insp: 12/2/2005      Basin: E03B  
DS Structure: 5948-374      6713 E 11TH ST      Dir Televised: Upstream To Downstream

## Pipe Information

Project No.: I-171      Material: VCP      Length: 240.2      Dia/Ht: 8

## Inspection Information

Crew: 690      Percent Full:      Tape ID: V-4946  
Weather: Sunny      Purpose: TV Existing Line      Counter Start:

Obs. #	VTR Counter	Distance	Location	Description	Rating	Obsrvd (gpm)	Est. (gpm)	Ratings		
								Struct	Clean	Remain (gpm)
1	47:13	0.0	US Manhole	5948-379	1	0.000	0	0	0.000	
2	47:25	0.0	Quad 3 / L-Lt	Crack-Horizontal	3	0.004	5	0	0.004	
3	47:53	4.8	Sag	Submerged	4	0.000	10	0	0.000	
4	48:13	12.5	Quad 3 / L-Lt	Crack-Horizontal	2	0.002	2	0	0.002	
5	48:24	12.8	Sag	Emerged & Submerged again	4	0.000	10	0	0.000	
6	49:07	32.0	Sag	Emerged	1	0.000	1	0	0.000	
7	49:30	41.4	Sag	Submerged	4	0.000	10	0	0.000	
8	50:04	56.2	Sag	Emerged	1	0.000	1	0	0.000	
9	50:37	69.0	Quad 3 / L-Lt	Crack-Horizontal	3	0.004	5	0	0.004	
10	51:11	85.2	Sag	Submerged	4	0.000	10	0	0.000	
11	51:42	94.9	Sag	Emerged	2	0.000	2	0	0.000	
12	51:42	94.9	Quad 3 / L-Lt	Crack-Horizontal	3	0.004	5	0	0.004	
13	51:58	97.5	South	Wye Service / Sealed Off	1	0.000	0	0	0.000	
14	52:12	100.8	North	Wye Service / Sealed Off	1	0.000	0	0	0.000	
15	52:57	102.7	South	Break-In Conn	1	0.001	0	0	0.001	
6706 E 10TH ST N										
16	53:20	109.2	Sag	Submerged	4	0.000	10	0	0.000	
17	54:06	112.7	North	Break-In Conn	1	0.001	0	0	0.001	
6705 E 11TH ST N / located in the sag area										
18	54:46	125.4	Sag	Emerged	1	0.000	1	0	0.000	
19	54:46	125.4	Quad 3 / L-Lt	Crack-Horizontal	3	0.004	5	0	0.004	
20	55:33	130.0	South	Break-In Conn	2	0.002	0	0	0.002	
6710 E 10TH ST N										
21	55:44	132.0	Sag	Submerged	4	0.000	10	0	0.000	
22	56:19	148.3	Sag	Emerged	2	0.000	2	0	0.000	
24	56:55	160.2	Quad 3 / L-Lt	Crack-Horizontal	3	0.004	5	0	0.004	
25	57:05	162.3		Cracks	1	0.000	1	0	0.000	
26	57:22	166.6	Sag	Submerged	4	0.000	10	0	0.000	
27	57:53	177.7	Sag	Emerged	1	0.000	1	0	0.000	
28	58:37	194.0	South	Wye Service / Sealed Off	1	0.000	0	0	0.000	
29	58:44	194.6	Sag	Submerged	5	0.000	25	0	0.000	
30	59:17	196.7	North	Wye Service	2	0.000	0	0	0.000	
6709 E 11 TH ST N / located in the sag / grease buildup										
31	59:56	206.6	Sag	Emerged	1	0.000	1	0	0.000	
		207.0	Joint	Offset Joint / fairly bad offset						
32	1:00:14	213.3	Sag	Submerged	4	0.000	10	0	0.000	
33	1:01:00	230.0	Sag	Emerged	1	0.000	1	0	0.000	
34	1:01:00	230.0	Quad 1 / U-Rt	Crack-Radial	3	0.004	5	0	0.004	
35	1:01:28	234.5	DS Manhole	5948-374	1	0.000	0	0	0.000	

LINE IN VERY POOR CONDITION, LINE HAS LOTS OF SAGS AND CRACKS.

NOTE: Easement has lots of trees over the sewer line. Contractors should review the Site prior to bidding. Pipe is like a "roller-coaster" and cannot be replaced by trenchless method. Sags are causing stoppage problems.

**4-6**