

FHWA REGION NO.	STATE	PROJECT NO.	FISCAL YEAR	SHEET NO.	TOTAL SHEETS
7	KANSAS	87TE-0158-01	2001	20	26

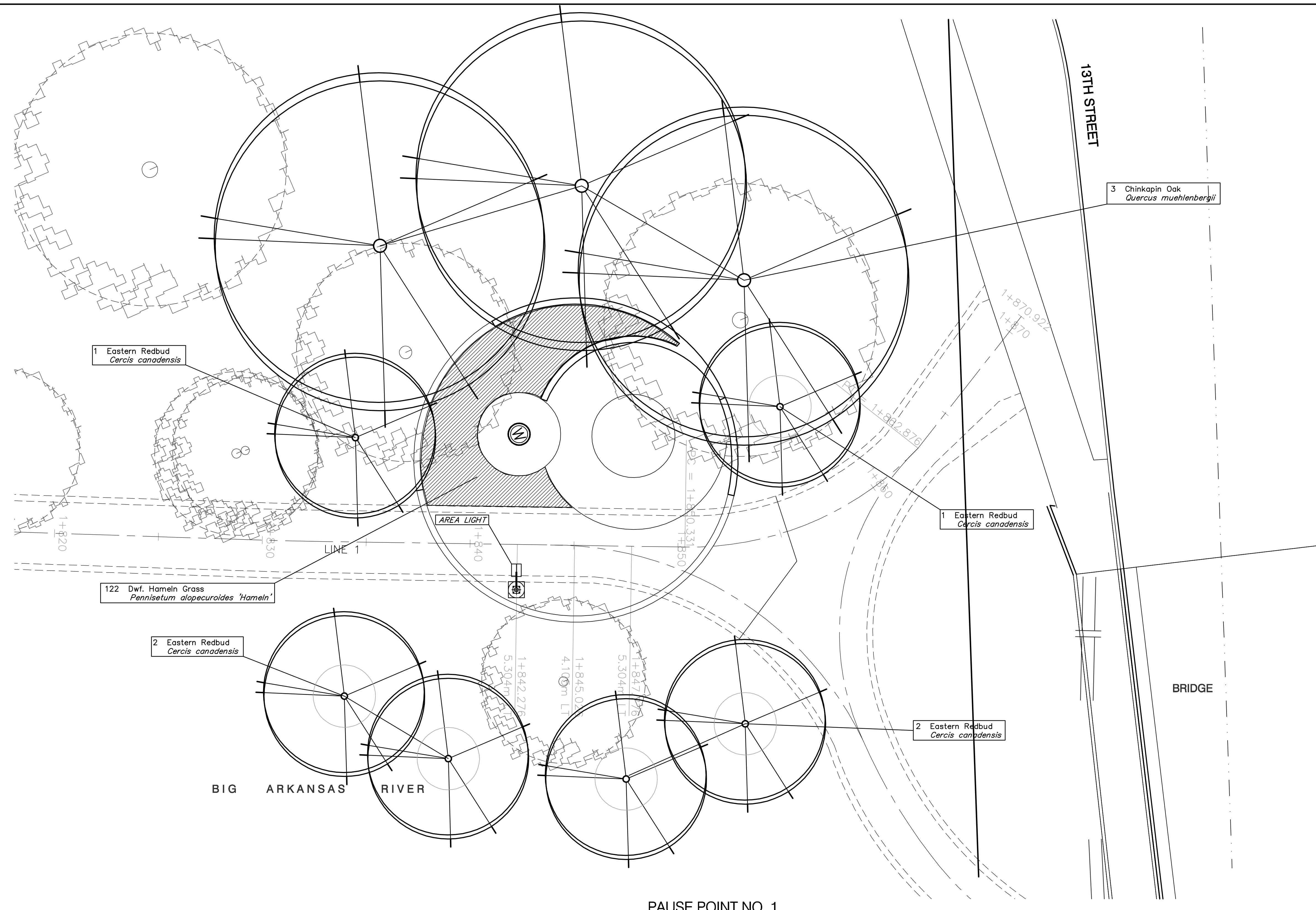
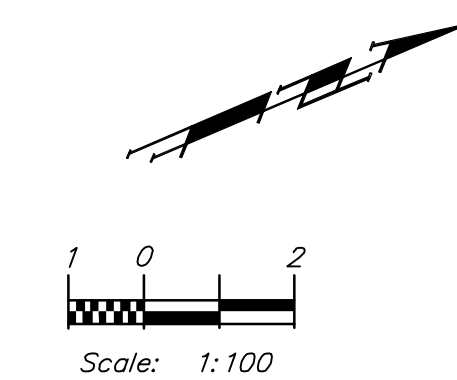

PAUSE POINT NO. 1

SUMMARY OF PLANTING QUANTITIES (THIS SHEET)

QTY.	BOTANICAL NAME	COMMON NAME	SIZE	CONDITION	REMARKS
6	<i>Cercis canadensis</i>	Eastern Redbud	40mm (1-1/2")	B & B	Single Stem
3	<i>Quercus muhlenbergii</i>	Chinkapin Oak	80mm (3")	B & B	Single Stem
122	<i>Pennisetum alopecuroides 'Hameln'</i>	Dwarf Hameln Grass	4 Litre (1 gal.)	Container	Healthy & Full

Landscape Contractor to Install Hardwood Mulch at a minimum Depth of 3"

PROJECT NUMBER 87 TE - 0158 - 01		SHEET NAME 20 Lsape01		ENGINEERING DIRECTORY Arkriver/Nov 06 Revisions	
DESIGN STAFF	DRAWN STAFF	APPROVED	DATE NOV 06	SCALE 1:100 SI	BAUGHMAN NO 99 12.E575

CAPITAL IMPROVEMENT PROJECT  
**LANDSCAPING PLANS**  
 PAUSE POINT 1, PATH NO. 1  
 CENTRAL TO 13th ST ALONG McLEAN BLVD

**Baughman Company, P.A.**  
 315 Ellis St. Wichita, KS 67211 P 316-262-7271 F 316-262-0149  
**Baughman** ENGINEERING | SURVEYING | PLANNING | LANDSCAPE ARCHITECTURE

