

FHWA REGION NO.	STATE	PROJECT NO.	FISCAL YEAR	SHEET NO.	TOTAL SHEETS
7	KANSAS	87-TE-0158-01	2001	4	26

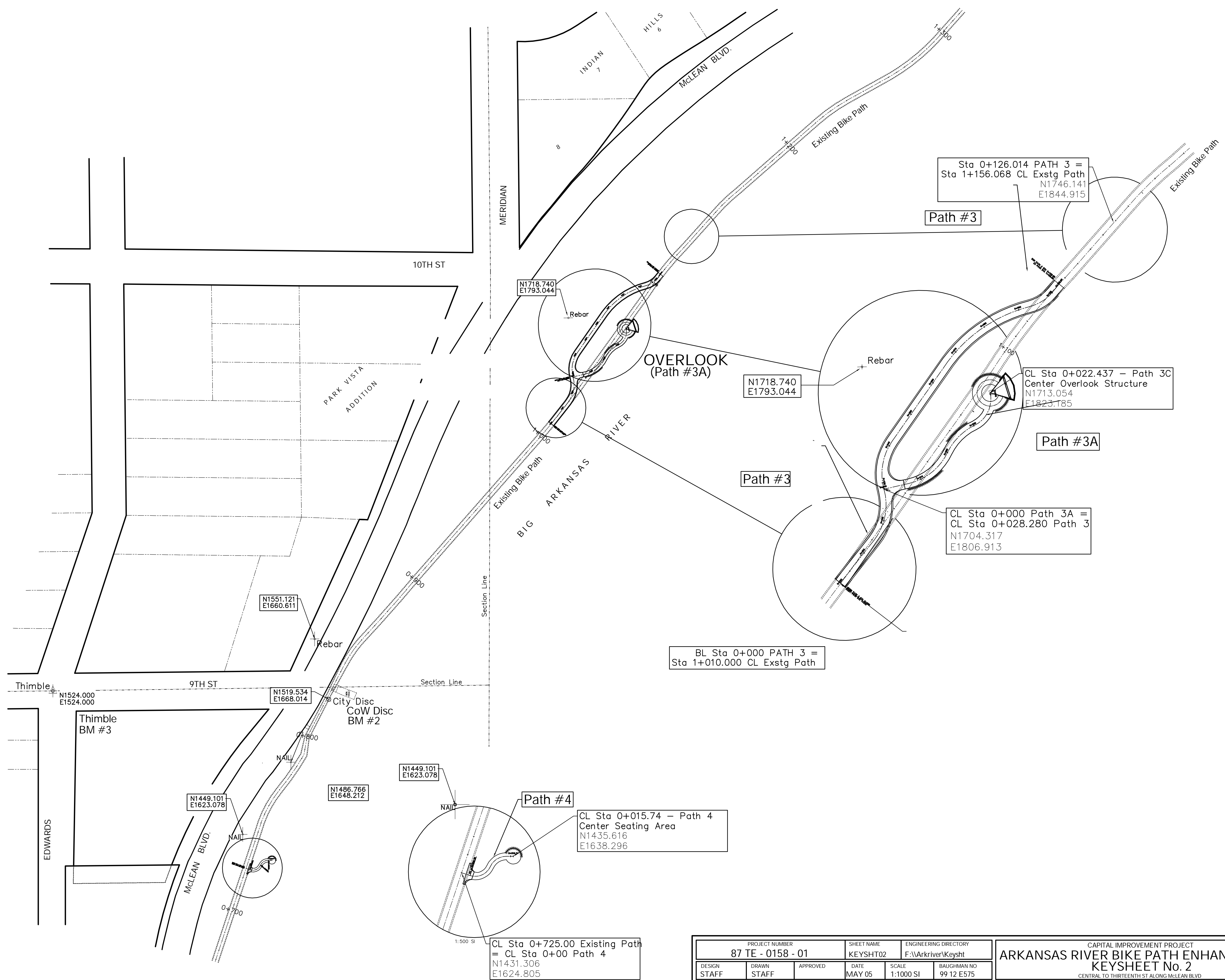
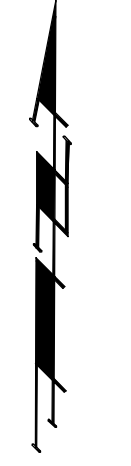
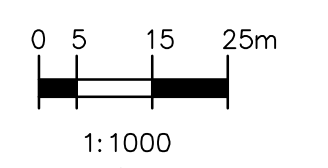

**BENCHMARKS:**

- BM #1 Iron @ 2.136m E and 5.105m S Thimble in NW Cor SEC 19, TWP 27 N, R 1 E. (Centerline of both Meridian and Central)  
Elevation = 397.371 S.I. Units  
Elevation = 1303.71 MSL Datum
- BM #2 City of Wichita Benchmark Disc  
City Disc Located in SW corner of concrete vault for water crossing east side McLean Blvd 3.507m (11.5') east of back of curb, in line with High Edge south side of 9th Street extended.  
Elevation = 397.538 S.I. Units  
Elevation = 1304.27 MSL Datum
- BM #3 THIMBLE (CL Intersection Edwards @ 9th St)  
NW COR, SEC. 19  
TWP-27N, R-1E  
Elevation = 397.569 S.I. Units  
Elevation = 1304.36 MSL Datum
- BM #4 3/4" Iron Pipe SW Cor Lot 10  
Indian Hills Addition (Block Corner)  
(Minisa @ McLean Blvd)  
Elevation = 397.379 S.I. Units  
Elevation = 1303.74 MSL Datum
- BM #5 USGS Standard Disc, stamped TT29 WB1939,  
3.05m (10') south of sidewalk and 7.62m (25') east of southeast end of Big Arkansas River bridge handrail Amidon @ 13th Street  
Elevation = 399.974 S.I. Units  
Elevation = 1312.25 MSL Datum

100% METRIC

PROJECT NUMBER 87 TE - 0158 - 01		SHEET NAME KEYSHT02		ENGINEERING DIRECTORY F:\Arkriver\Keysh		CAPITAL IMPROVEMENT PROJECT <b>ARKANSAS RIVER BIKE PATH ENHANCEMENT</b> KEYSHEET No. 2 CENTRAL TO THIRTEENTH ST ALONG MCLEAN BLVD		<b>Baughman Company, P.A.</b> 315 Ellis St. Wichita, KS 67211 P 316-262-7271 F 316-262-0149 Baughman ENGINEERING   SURVEYING   PLANNING   LANDSCAPE ARCHITECTURE		SHEET 4 OF 26	
DESIGN STAFF	DRAWN STAFF	APPROVED	DATE MAY 05	SCALE 1:1000 SI	BAUGHMAN NO 99 12 E575						

CL Sta 0+725.00 Existing Path  
= CL Sta 0+00 Path 4  
N1431.306  
E1624.805