

FHWA REGION NO.	STATE	PROJECT NO.	FISCAL YEAR	SHEET NO.	TOTAL SHEETS
7	KANSAS	87TE-0158-01	2001	6	26

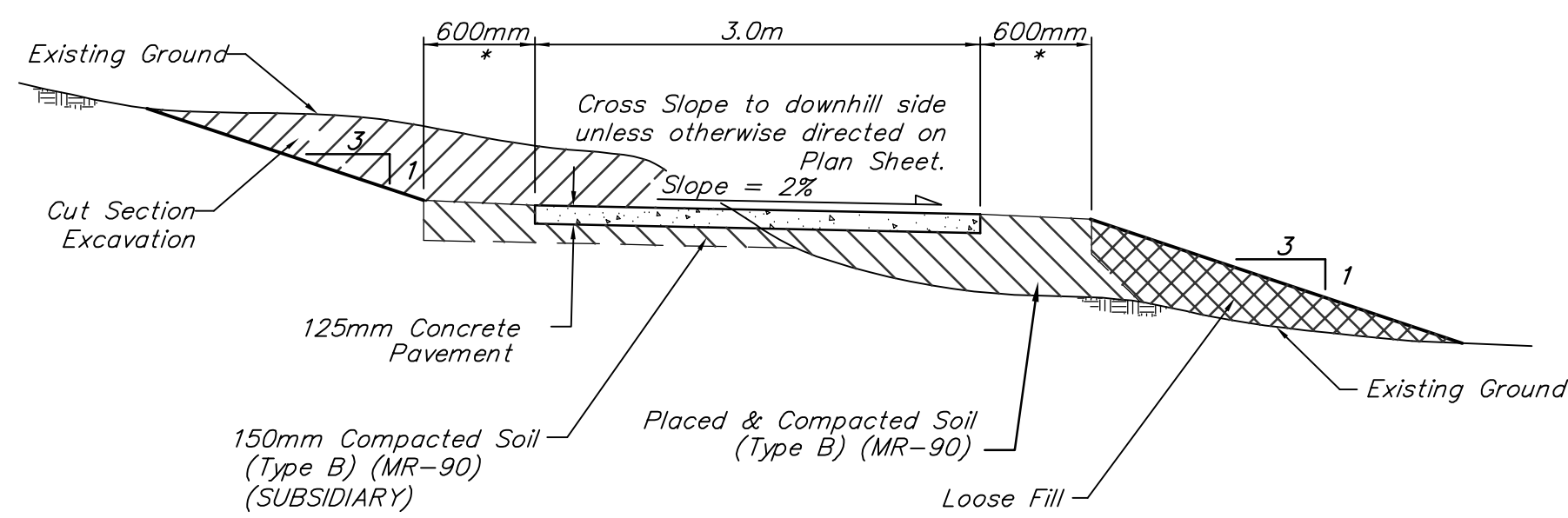

* 600mm Clear Shoulders should be maintained on both sides of 3.0m Path unless otherwise directed on plans.

TYPICAL BIKE PATH SECTION IN CUT & FILL
NO SCALE

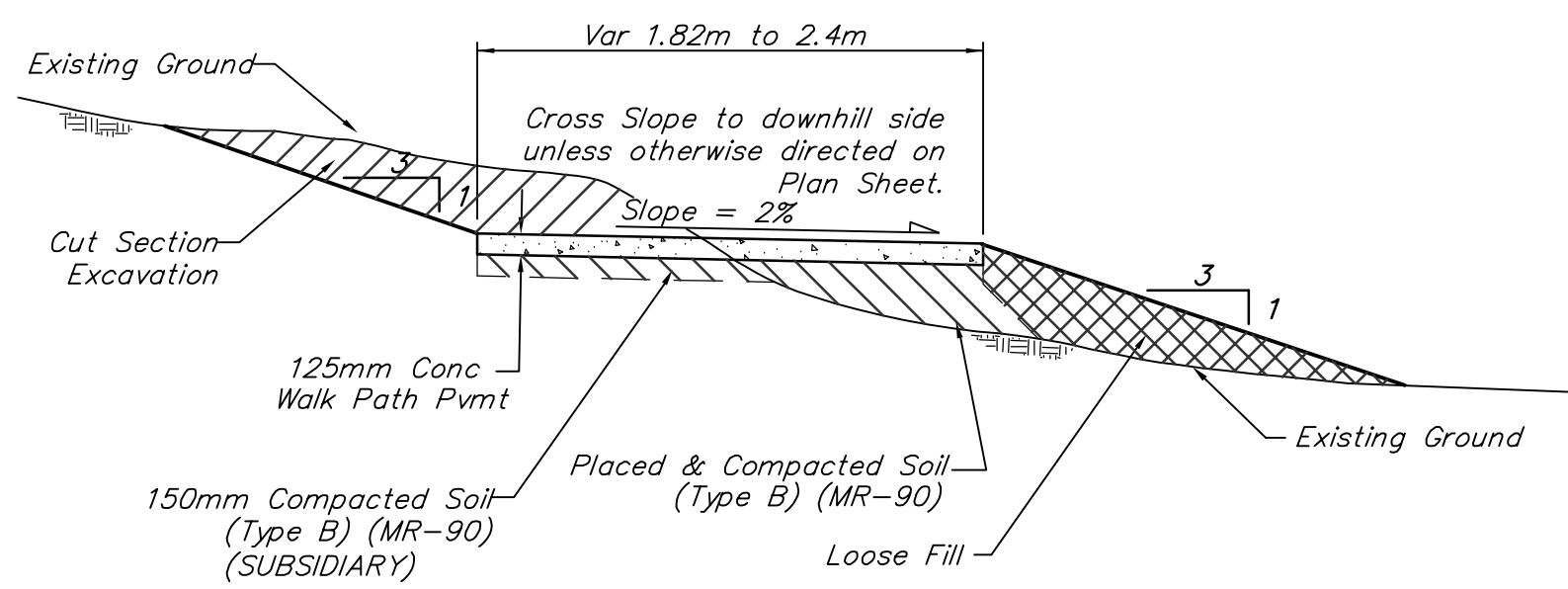

TYPICAL WALK PATH SECTION IN CUT & FILL
NO SCALE

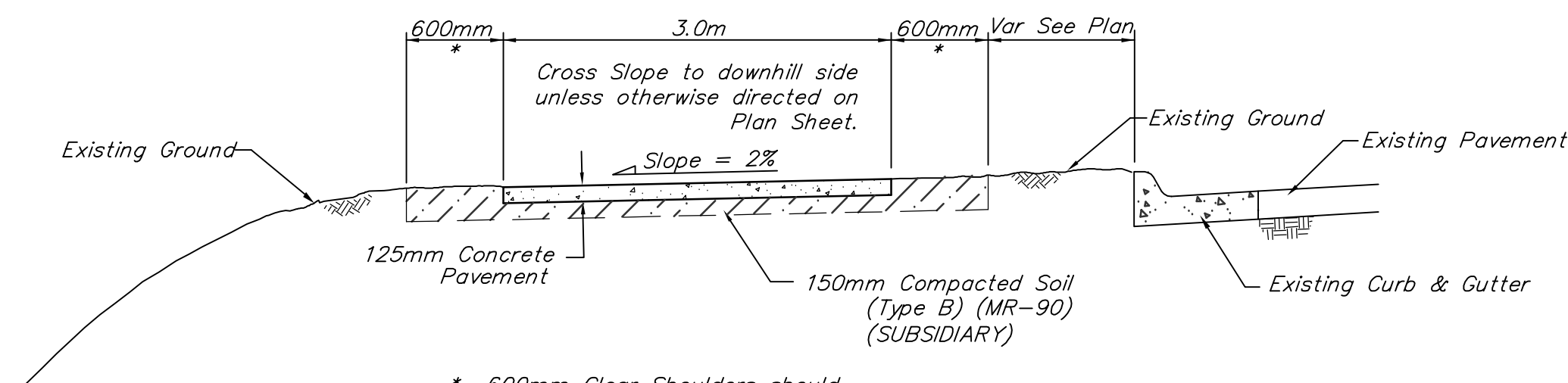

* 600mm Clear Shoulders should be maintained on both sides of 3.0m Path unless otherwise directed on plans.

BIKE PATH SECTION ADJACENT TO ROADWAY
NO SCALE

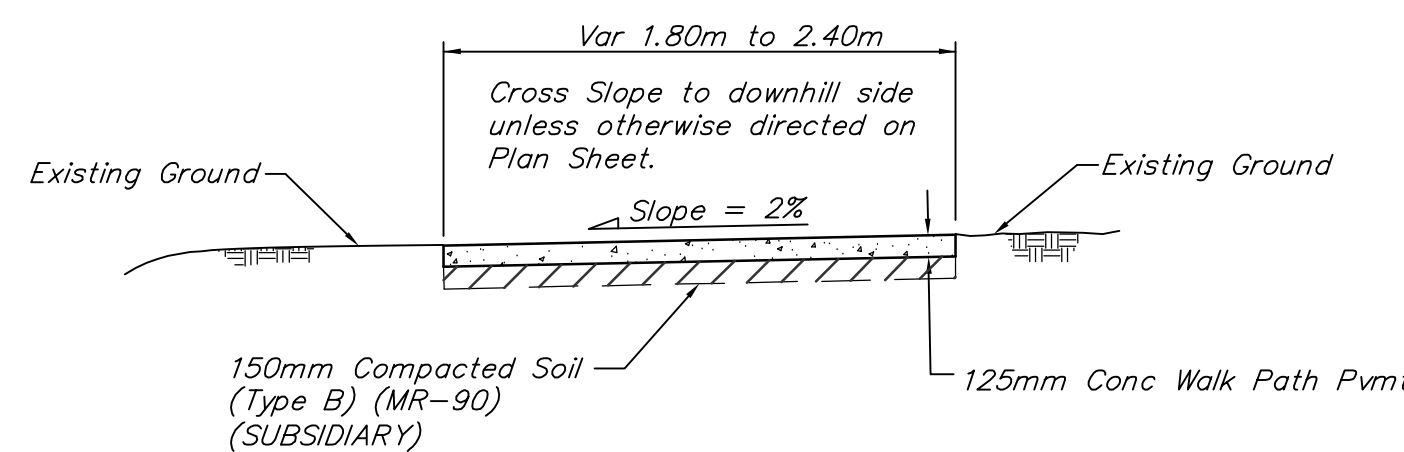

TYPICAL WALK PATH SECTION
NO SCALE

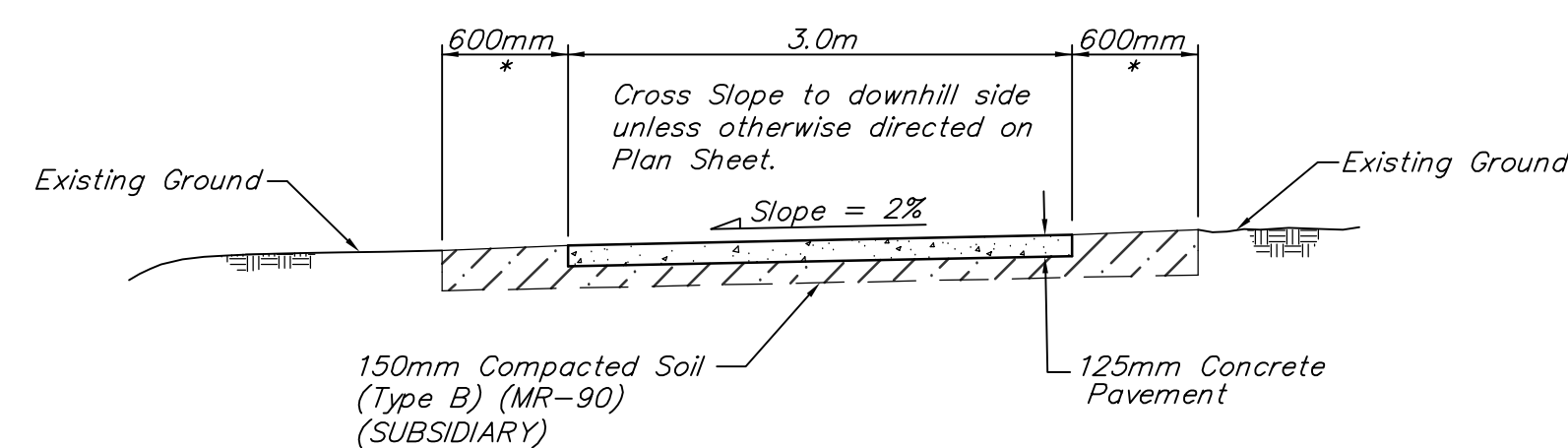

* 600mm Clear Shoulders should be maintained on both sides of 3.0m Path unless otherwise directed on plans.

TYPICAL BIKE PATH SECTION
NO SCALE

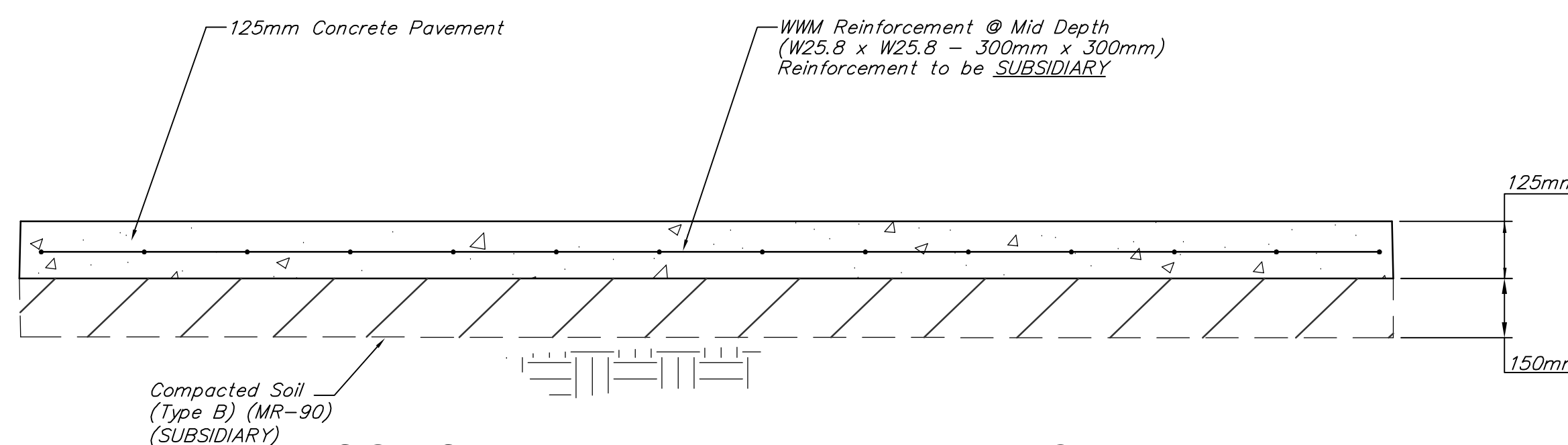

CONCRETE PAVEMENT DETAILS
NO SCALE



PROJECT NUMBER 87 TE - 0158 - 01		SHEET NAME 06_miscdtls		ENGINEERING DIRECTORY Arkriver/Nov 06 Revisions	
DESIGN STAFF	DRAWN STAFF	APPROVED	DATE NOV 06	SCALE NONE	BAUGHMAN NO 99-12-E575

CAPITAL IMPROVEMENT PROJECT
ARKANSAS RIVER BIKE PATH ENHANCEMENT
MISCELLANEOUS DETAILS/TYPICAL SECTIONS
CENTRAL TO THIRTEENTH ST ALONG MCLEAN BLVD

Baughman Company, P.A.
315 Ellis St. Wichita, KS 67211 P 316-262-7271 F 316-262-0149
Baughman ENGINEERING | SURVEYING | PLANNING | LANDSCAPE ARCHITECTURE

SHEET
6
OF
26