

BENCHMARK:
 BM #1: HOOVER AND 45TH ST NORTH
 - COW BENCHMARK AT NE CORNER OF
 INTERSECTION, 10.20' SSE OF PP,
 58.80' ESE OF PP ON NW CORNER,
 85.50' NE OF GAS LINE MARKER,
 59.00' NORTH OF GAS LINE MARKER,
 28.50' EAST OF CENTERLINE, 14.50'
 NORTH OF CENTERLINE.
 ELEV. = 1335.29 (NGVD 29)

BM #2: Small RR spike in 3rd PP west
 of Hoover St. on the north side of
 45th St. N.
 Elev. = 1337.68

BM #3: Small RR spike in 2nd PP east
 of NW corner of SEC. 27, TWP. 26-S,
 R-1-W. (North side of 45th St. N.,
 west of Hoover St.)
 Elev. = 1339.57

BM #4: 60d nail in PP at the SE
 corner of exception on west side of
 Hoover St. south of 45th St. N.
 Elev. = 1335.26

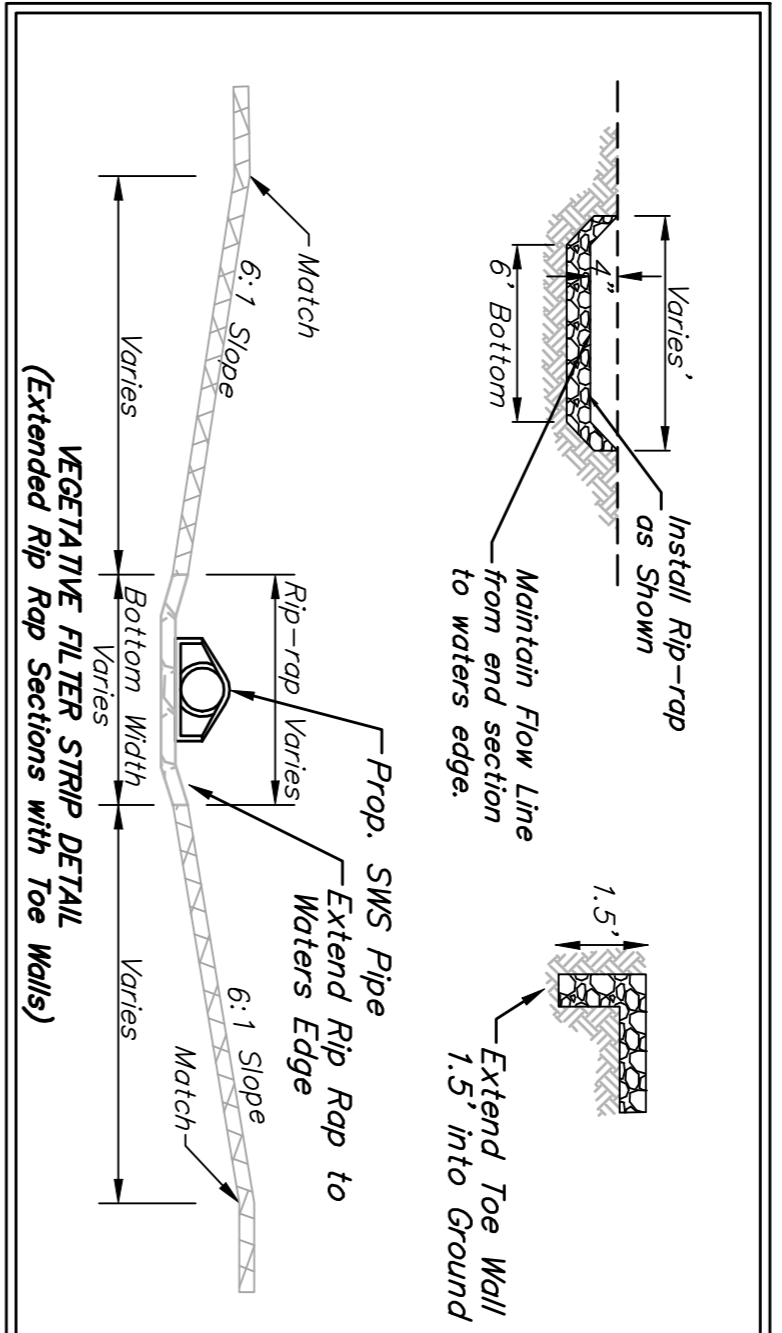

Static Water Surface
 Elev. = 1325.5

*Rip-rap shall be 6" to 9" stone compacted and will be paid as Light Stone Rip Rap.

Sta 0+00, Line 6
 Begin construction of 15" RCP w/ end section.
 38.0 S.Y. light stone rip-rap* (Vegetative Filter Strip)

Sta 0+54.9, End Line 6
 Construct std. type 1A double curb inlet (10'x3')
 1 - 18" Stub (NW)
 Top Elev. = 1335.50

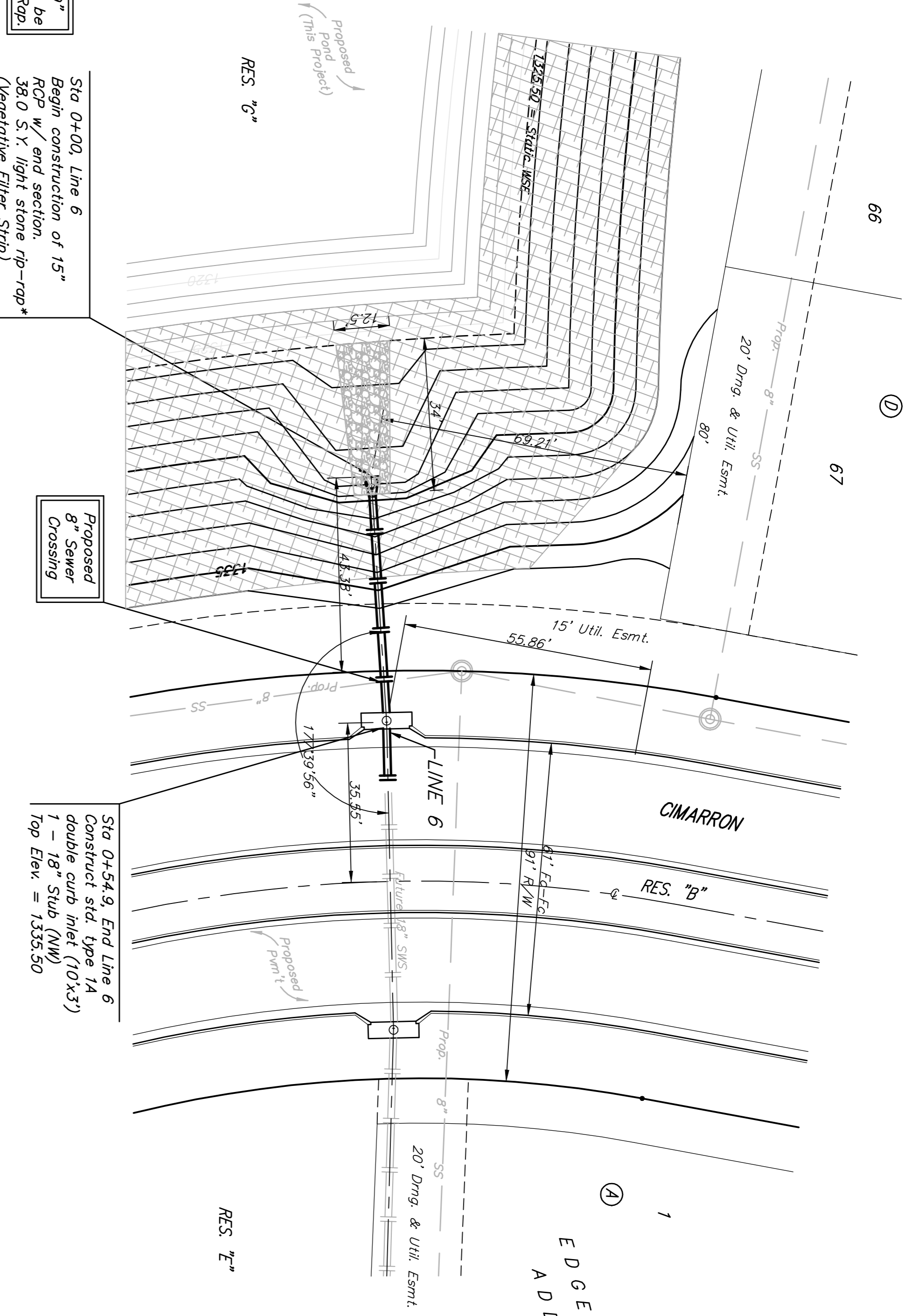

EDGE WATER
 ADDITION

Scale: 1" = 20' Horizontal
 1" = 5' Vertical
 • = Iron

1340	
1335	
1330	
1325	
1320	

Baughman
 ENGINEERING | SURVEYING | PLANNING | LANDSCAPE ARCHITECTURE

EDGE WATER ADDITION
LINE 6
 STORM WATER DRAIN IMPROVEMENTS

PROJECT NUMBER: 468-44333
 DATE: 08/07
 SCALE: Noted
 SHEET: 5 OF 44

07.05EB39