

BENCHMARKS:
 BM #1: City of Wichita Disc at Southwest corner of 135th St. W. & 13th St. N. 30.00± S. of @ 35.00± W. of @ Elev. = 1355.65 NGVD29

BM #2: Small Railroad Spike in 2nd HLP W. of 135th St. W. on South Side of 13th St. N., (N. Face of HLP). Elev. = 1359.50 NGVD29

BM #3: Small Railroad Spike in 4th HLP W. of 135th St. W. on South Side of 13th St. N., (N. Face of HLP). Elev. = 1366.64 NGVD29

P.V.I.
 Elev. = 1372.80
 42' V.C.

Sta. 2+60.21, 14.25' Lt.
 Install subdivision benchmark (Flat survey marker No. 8134-08 3" top diameter) in top of curb. Cost shall be incidental to L.F. curb & gutter.

Valve Box
 Elev. = 1372.75

Construct 5" A.C. pavement w/ 5" reinf. rock base.

Construct std. comb. roll type curb & gutter (3-5/8")

Transition from 1/2 crown to full crown in 10'

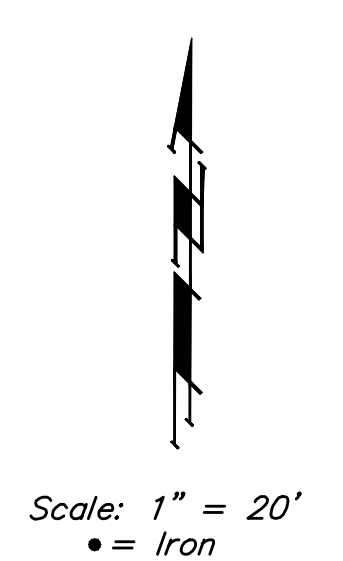
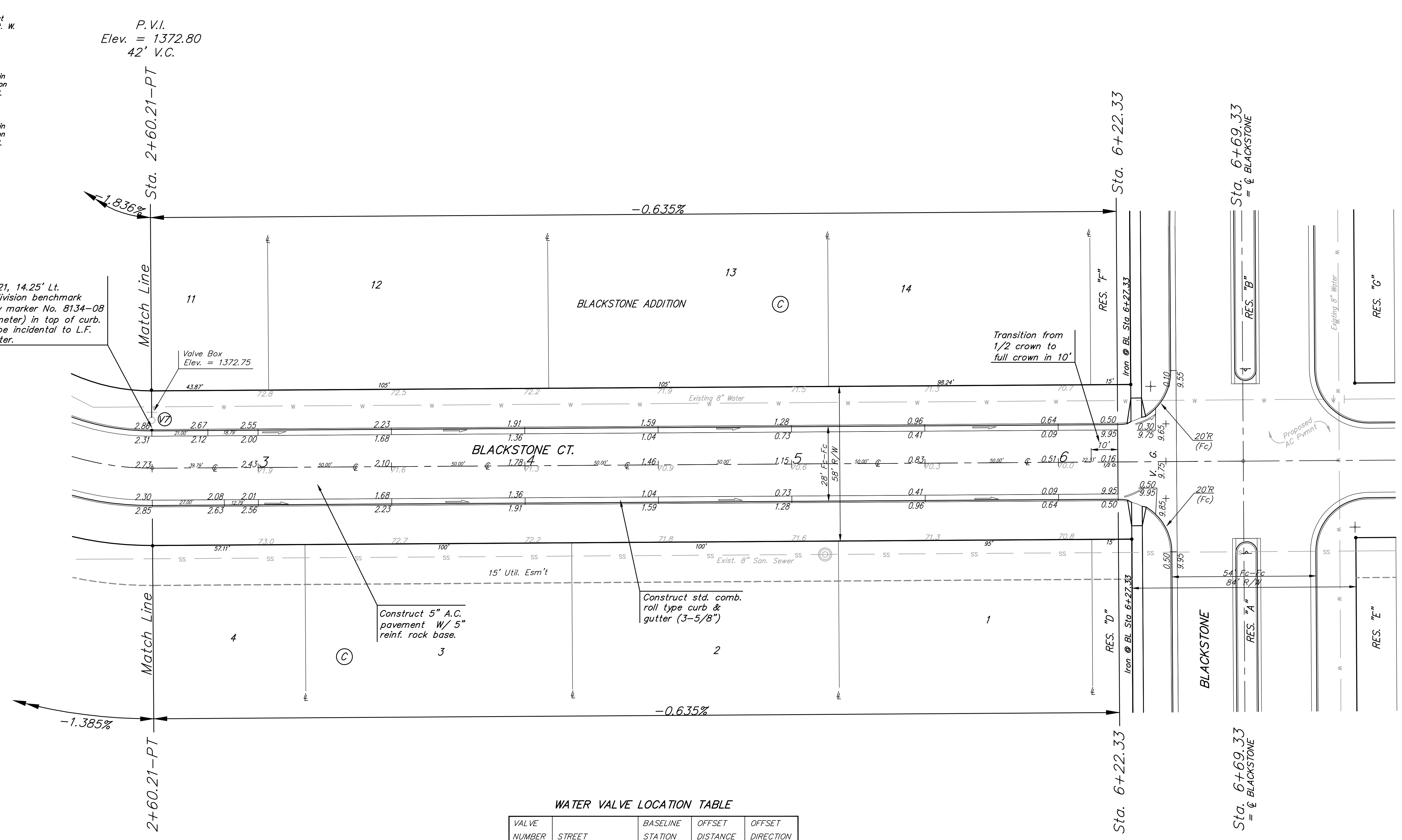

WATER VALVE LOCATION TABLE

VALVE NUMBER	STREET	BASELINE STATION	OFFSET DISTANCE	OFFSET DIRECTION
V1	Blackstone	0+54.00	36'	Rt.
V2	Blackstone	0+90.00	36'	Rt.
V3	Blackstone	2+48.00	36'	Rt.
V4	Blackstone	5+19.29	26'	Rt.
V5	Blackstone	8+27.44	26'	Rt.
V6	Blackstone Ct.	0-19.81	36.37'	Rt.
V7	Blackstone Ct.	2+60.21	23'	Lt.
V8	Blackstone Ct.	2+22.00	39.73'	Rt.
V9	Price	0+24.55	26'	Lt.
V10	Price	0+39.09	26'	Lt.
V11	Price	5+87.70	26'	Lt.
V12	Obsidian Ct.	0+28.85	39.73'	Lt.
V13	Obsidian	4+40.39	26'	Rt.

Paving contractor will be responsible to operate all water valves on the project, in the presence of the inspector, to ensure accessibility to the valves, and that all valves are left in the "ON" position when the project is completed.

Roll type curb & gutter to be constructed on the pavement on this sheet.
 Top of curb elevation are given for full height curb.

Baughman Blackstone Addition - Phase I
BLACKSTONE CT
 Lots 1-14, Block C

Baughman Company, P.A. 315 Ellis St. Wichita, KS 67211 P 316-262-7271 F 316-262-0149
 ENGINEERING | SURVEYING | PLANNING | LANDSCAPE ARCHITECTURE

PROJECT NUMBER: 472-84397
 DESIGN: JAK
 DRAWN: AMH/TMS
 APPROVED: NBW
 DATE: 8/22/07

REVISIONS:

SCALE: Noted
 SHEET: **10 OF 45**

Blackstone\Phase I\S4 06-08-E615