

NOTE:  
 All areas shall be graded to drain to street, gutter or existing storm water sewer, via drives, flumes, private storm water sewer and/or other approved drainage facilities.

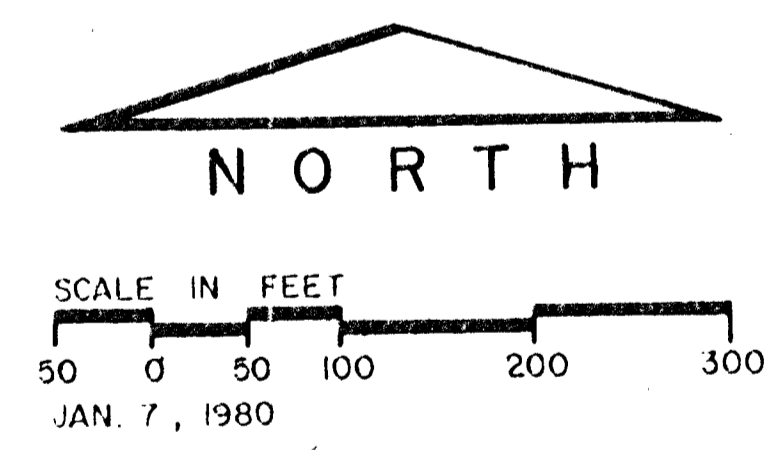

REVISED DRAINAGE CONCEPT      JANUARY 25, 1980

# CENTRAL - RIDGE

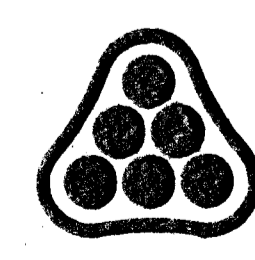
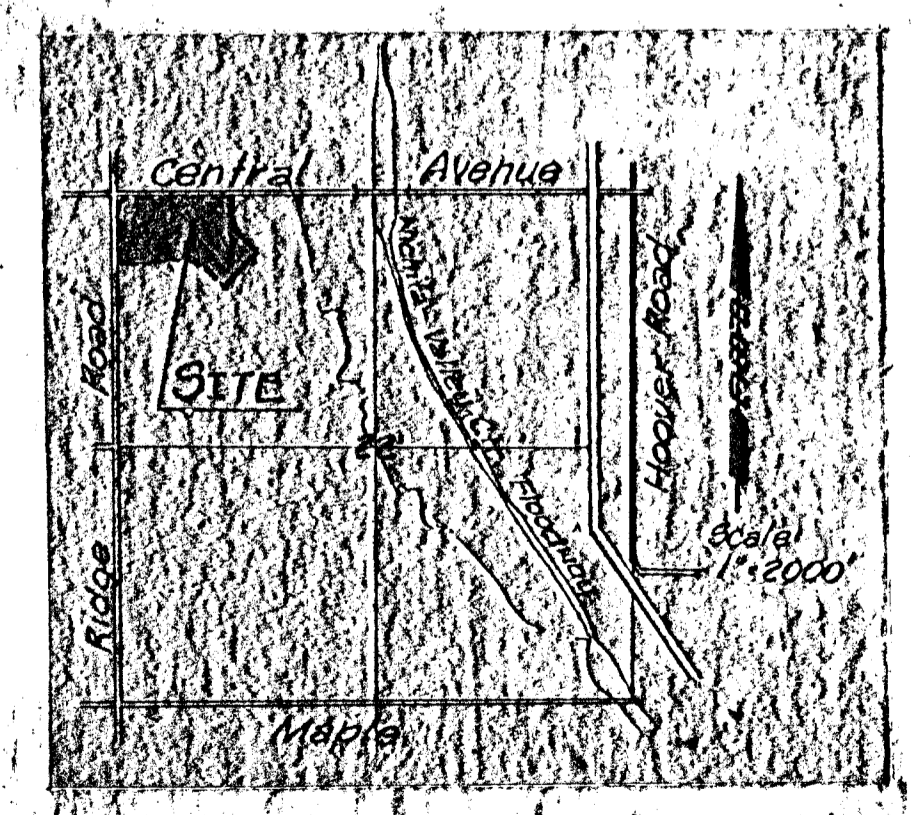

**PROFESSIONAL ENGINEERING CONSULTANTS, P.A.**  
 ENGINEERS  
 WICHITA, KANSAS

Preliminary Drainage Concept  
 2/8/80