

N.W. COR. N.W. 1/4
SEC. 18, T27S, R1W



NOTES:

BENCHMARK: CITY STD. BRASS CAP IN CONC. 25' N. & 30' E. OF S. 1/4 COR. SEC. 7, T27S, R1W. ELEV. 1345.33 M.S.L.

SETBACKS AND RESERVES SHALL MEET REQUIREMENTS AS SET FORTH UNDER BRIARWOOD ESTATES C.U.P. DP-136 GENERAL PROVISIONS.

RESERVES "A" & "B" SHALL PERMIT DRAINAGE, UTILITIES CONFINED TO EASEMENTS, LANDSCAPING, PRIVATE ACCESS AND RECREATIONAL FACILITIES.

DRAINAGE CONCEPT PLAN SHALL BE PREPARED AND SUBMITTED BY PROFESSIONAL ENGINEERING CONSULTANTS.

MINIMUM PAD ELEVATIONS FOR ALL LOTS SHALL BE 1335.00 M.S.L.

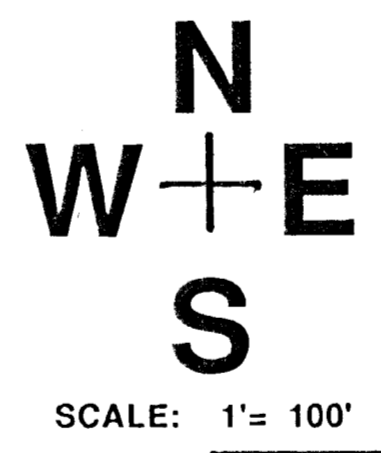

LOCATION MAP

PRELIMINARY PLAT (REPLAT OF A PORTION OF BRIARWOOD ESTATES 4TH & 5TH ADDITIONS)

BRIARWOOD ESTATES 6TH ADDITION

OWNER: SLAWSON INVESTMENT COMPANY, INC., 104 S. BROADWAY, WICHITA, KANSAS 67202 PH: 263-3201

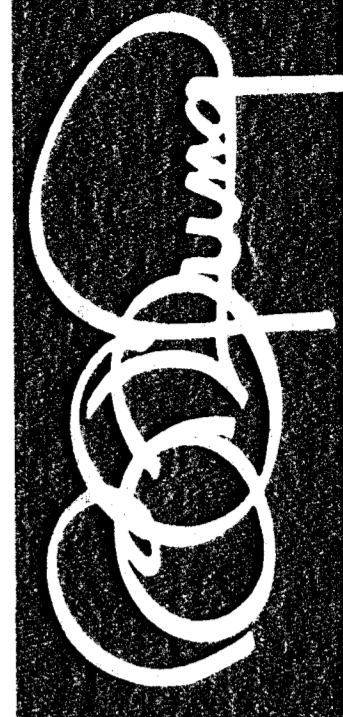

BILL G. YUNG DESIGN
WICHITA, KS. 67220
4812 E. 28TH STREET NORTH
316-850-5567

DATE: MAY 1, 1991
REV.

SHEET TITLE
BRIARWOOD ESTATES
6TH ADDITION

PROJECT
PRELIMINARY PLAT

SHEET
OF