

BAREFOOT BAY

AN ADDITION TO WICHITA, SEDGWICK COUNTY, KANSAS

STATE OF KANSAS)
) SS
 COUNTY OF SEDGWICK)

I, MICHAEL W. BERRY, A REGISTERED LAND SURVEYOR IN AFORESAID STATE AND COUNTY, DO HEREBY CERTIFY THAT ON THIS 20th DAY OF MAY, 1994, I HAVE CAUSED TO BE SURVEYED AND PLATTED BAREFOOT BAY, AN ADDITION TO WICHITA, SEDGWICK COUNTY, KANSAS, INTO LOTS, A BLOCK, STREETS, AND RESERVES, THE SAME BEING A TRACT OF LAND IN THE NORTH ONE-HALF OF SECTION 3, TOWNSHIP 27 SOUTH, RANGE 1 WEST OF THE 6TH P.M. DESCRIBED AS FOLLOWS: BEGINNING AT THE POINT OF INTERSECTION OF THE NORTHERLY RIGHT-OF-WAY LINE OF THE KANSAS SOUTHWESTERN RAILROAD (FORMERLY THE MISSOURI PACIFIC RAILROAD) WITH THE WEST LINE OF THE NE 1/4 OF SAID SECTION 3, SAID POINT ALSO BEING 192.74 FEET ON A BEARING OF N0°03'54"E FROM THE SW CORNER OF SAID NE 1/4; THENCE BEARING N39°27'49"W ALONG SAID NORTHERLY RIGHT-OF-WAY A DISTANCE OF 660.23 FEET; THENCE BEARING N50°32'11"E A DISTANCE OF 130.00 FEET; THENCE BEARING N0°03'54"E A DISTANCE OF 158.73 FEET; THENCE BEARING N25°58'06"W A DISTANCE OF 410.72 FEET; THENCE BEARING N0°03'54"E A DISTANCE OF 550.00 FEET; THENCE BEARING N89°47'30"E A DISTANCE OF 1945.00 FEET; THENCE BEARING S0°03'54"W A DISTANCE OF 1525.00 FEET; THENCE BEARING S44°47'30"W A DISTANCE OF 268.58 FEET; THENCE BEARING S0°12'30"E A DISTANCE OF 30.15 FEET; THENCE BEARING N89°52'02"W A DISTANCE OF 1202.09 FEET TO A POINT IN THE NORTHERLY RIGHT-OF-WAY OF THE KANSAS SOUTHWESTERN RAILROAD; THENCE ALONG SAID RIGHT-OF-WAY BEARING N39°27'49"W A DISTANCE OF 84.88 FEET TO THE POINT OF BEGINNING.

Michael W. Berry
 MICHAEL W. BERRY, R.L.S. NO. 946
 PROFESSIONAL ENGINEERING CONSULTANTS, P.A.

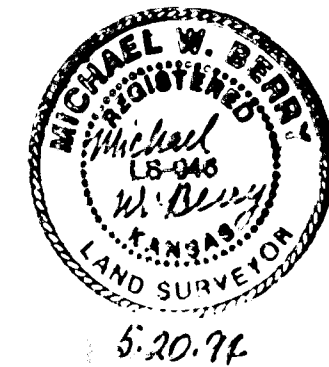

KNOW ALL MEN BY THESE PRESENTS THAT WE, THE UNDERSIGNED PROPERTY OWNERS OF THE LAND, AS ABOVE SET FORTH IN THE SURVEYOR'S CERTIFICATE, HAVE CAUSED THE LAND TO BE SURVEYED AND PLATTED INTO LOTS, A BLOCK, STREETS, AND RESERVES, THE SAME TO BE KNOWN AS BAREFOOT BAY, AN ADDITION TO WICHITA, SEDGWICK COUNTY, KANSAS.

EASEMENTS AS INDICATED FOR THE CONSTRUCTION AND MAINTENANCE OF PUBLIC UTILITIES AND DRAINAGE ARE HEREBY GRANTED. THE STREETS ARE HEREBY DEDICATED TO AND FOR THE USE OF THE PUBLIC.

THE 5 FOOT WALL EASEMENT ALONG THE SOUTH LINE OF RESERVE C AND LOT 41, BLOCK 1, IS PLATTED FOR THE CONSTRUCTION AND MAINTENANCE OF A PRIVATE WALL. UTILITIES MAY CROSS THE WALL EASEMENT.

MINIMUM PAD ELEVATION (LOWEST OPENING) FOR ALL LOTS SHALL BE 1325.4 M.S.L. OR 138.2 CITY DATUM.

LOWEST FLOOR ELEVATION FOR ALL LOTS SHALL BE 1324.5 M.S.L. OR 137.3 CITY DATUM.

NOTE: MONUMENTS FOR RESERVE BOUNDARIES NOT SET UNLESS OTHERWISE NOTED.

RESERVE "A" IS HEREBY PLATTED FOR OPEN SPACE, ENTRY MONUMENTS, LANDSCAPING, IRRIGATION, AND UTILITIES CONFINED TO EASEMENTS. RESERVE "B" IS HEREBY PLATTED FOR ENTRY MONUMENT, LANDSCAPING, AND IRRIGATION. RESERVE "C" IS HEREBY PLATTED FOR OPEN SPACE, ENTRY MONUMENTS, LANDSCAPING, IRRIGATION, AND WALLS, EMERGENCY ACCESS, AND UTILITIES CONFINED TO EASEMENTS. RESERVE "D" IS HEREBY PLATTED FOR FLOODWAY, LAKE, OPEN SPACE, RECREATIONAL FACILITIES, AND LANDSCAPING. RESERVES "A" THROUGH "D" SHALL BE SUBJECT TO THE RESTRICTIVE COVENANTS ESTABLISHED BY THE DECLARATION OF LANDOWNERS' ASSOCIATION AGREEMENTS AND SHALL BE OWNED AND MAINTAINED BY A LANDOWNERS' ASSOCIATION TO BE FORMED WITHIN BAREFOOT BAY, AN ADDITION TO WICHITA, SEDGWICK COUNTY, KANSAS.

THE FLOODWAY WITHIN RESERVE "D" SHALL BE THE RESPONSIBILITY OF THE LANDOWNERS' ASSOCIATION UNTIL SUCH TIME AS THE GOVERNING BODY EXERCISING JURISDICTION ELECTS TO ASSUME THE RESPONSIBILITY FOR THE MAINTENANCE AND IMPROVEMENT OF THE FLOODWAY, PROVIDED FURTHER THAT NO STRUCTURE SHALL BE CONSTRUCTED ON OR WITHIN SAID FLOODWAY, NOR SHALL ANY FILL, CHANGE OF GRADE, CREATION OF CHANNEL OR OTHER WORK BE CARRIED ON WITHOUT THE PERMISSION OF THE CITY ENGINEER.

OWNER: BAREFOOT BAY DEVELOPMENT, INC.

BY: *J. Ritchie*
 JACK O. RITCHIE, C.E.O.

STATE OF KANSAS)
) SS
 COUNTY OF SEDGWICK)

BE IT REMEMBERED ON THIS 20th DAY OF MAY, 1994, BEFORE ME, A NOTARY PUBLIC IN AFORESAID STATE AND COUNTY, CAME JACK O. RITCHIE, CHIEF EXECUTIVE OFFICER OF BAREFOOT BAY DEVELOPMENT, INC. TO ME PERSONALLY KNOWN TO BE THE SAME PERSON WHO EXECUTED THE FOREGOING INSTRUMENT OF WRITING AND DULY ACKNOWLEDGED THE EXECUTION OF SAME FOR AND ON BEHALF AND AS THE ACT AND DEED OF SAID CORPORATION, IN TESTIMONY WHEREOF I HAVE HEREUNTO SET MY HAND AND AFFIXED MY NOTARIAL SEAL THE DAY AND YEAR ABOVE WRITTEN.

Gary L. Wiley
 GARY L. WILEY
 NOTARY PUBLIC



MY COMMISSION EXPIRES Jan 15, 1997

THIS PLAT HAS BEEN SUBMITTED TO AND APPROVED BY THE WICHITA SEDGWICK COUNTY METROPOLITAN AREA PLANNING COMMISSION, WICHITA, KANSAS, DATED THIS _____ DAY OF _____, 1993.

_____, CHAIRMAN

Warren S. Krout
 WARREN S. KROUT, SECRETARY

THIS PLAT APPROVED AND ALL DEDICATIONS SHOWN HEREON ARIE ACCEPTED BY THE CITY COUNCIL OF THE CITY OF WICHITA, KANSAS, DATED THIS _____ DAY OF _____, 1994.

Elma Broadfoot
 ELMA BROADFOOT, MAYOR

_____, DEPUTY CITY CLERK

ENTERED ON TRANSFER RECORD THIS _____ DAY OF _____, 1994.

_____, COUNTY CLERK

THIS IS TO CERTIFY THAT THIS INSTRUMENT WAS FILED FOR RECORD IN THE REGISTER OF DEEDS OFFICE AT _____ W., ON THIS _____ DAY OF _____, 1994.

_____, REGISTER OF DEEDS

PAT KETTLER

ED RESA, DEPUTY