

- NOTES:**
- 1.) LOTS 1 - 73 BLK. 1, 1 - 46 BLK. 2, AND 1 - 32 BLK. 3 SHALL BE REZONED AA.
 - 2.) LOTS 33 - 61 BLOCK 3 AND LOTS 1 - 20 BLOCK 4 SHALL BE REZONED AA WITH A CONDITIONAL USE TO PERMIT, DUPLEX, AND OR MULTIFAMILY USES.
 - 3.) A DRAINAGE CONCEPT PLAN SHALL BE PREPARED AND SUBMITTED TO COUNTY ENGINEER FOR APPROVAL. A DRAINAGE STUDY SHALL ALSO BE PREPARED AND SUBMITTED TO FEMA TO ESTABLISH LIMITS OF 100 YEAR FLOOD PLAIN AND SET MINIMUM PAD ELEVATIONS FOR LOTS.
 - 4.) RESERVE "A" SHALL PERMIT DRAINAGE, LAKES, ENTRY MONUMENTS, DRAINAGE STRUCTURES, PARKS, JOGGING PATHS, LANDSCAPING, GAZEBOS, CLUBHOUSE AND RELATED FACILITIES, AND UTILITIES CONFINED TO EASEMENTS. ALL STRUCTURES ON RESERVE "A" SHALL HAVE A SETBACK OF 25'.
 - 5.) RESERVE "B" SHALL PERMIT PARKS AND RELATED FACILITIES, JOGGING PATHS, GAZEBOS, LANDSCAPING AND UTILITIES CONFINED TO EASEMENTS.
 - 6.) RESERVES "C" THROUGH "I" SHALL PERMIT WALKS, ENTRY MONUMENTS, LANDSCAPING AND UTILITIES CONFINED TO EASEMENTS.
 - 7.) RESERVES "F" "M" "O" SHALL ALSO PERMIT GUARD HOUSES. RESERVE "S" SHALL ALSO PERMIT WATER FEATURE.

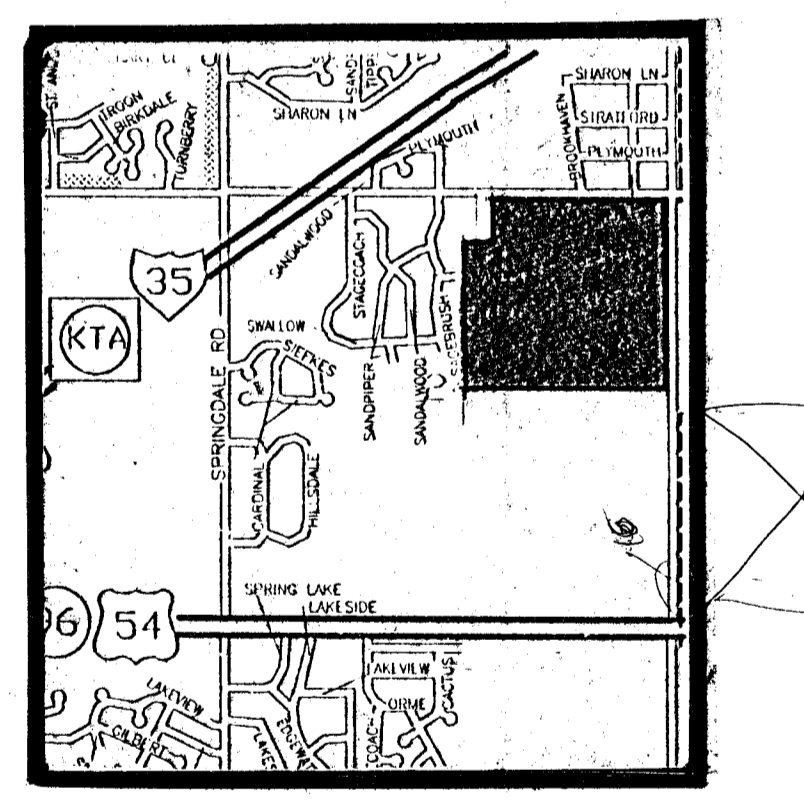

LOCATION MAP

PRELIMINARY PLAT

BELLE TERRE

TOTAL ACRES: 148.9
 TOTAL LOTS: 213
 MINIMUM LOT SIZE: (80'X120') 9600 S.F.

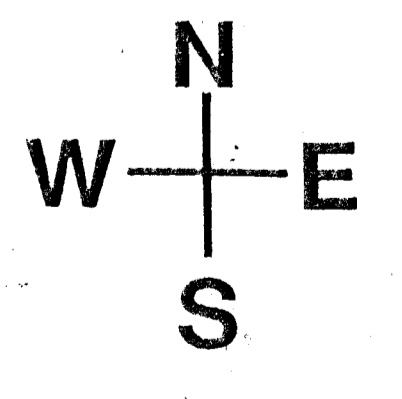

SCALE: 1"=100'
 CONTOUR INTERVAL = 2'

OWNER: DOWNING DEVELOPMENT CO. 1124 TERRADYNE ANDOVER, KANSAS 67002

DATE: SEPT. 23, 1992

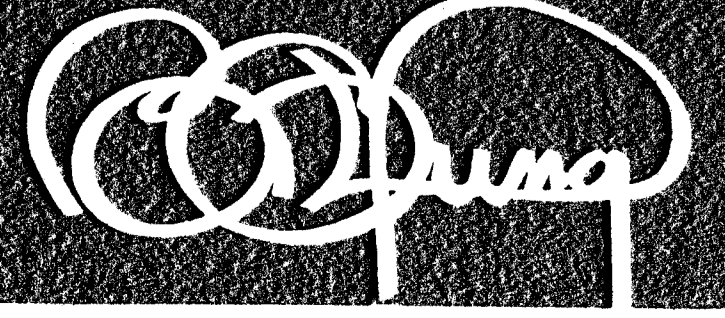

BILL G. YUNG DESIGN
 1912 E. 29TH STREET NORTH WICHITA, KS 67220 318-683-5520