

NOTES

- BENCH MARK:**
 CITY STANDARD - SQUARE CUT, TO R.O.B., 49' WEST AND 17' NORTH OF THE CENTERLINE OF WOODLAWN AND 29TH STREET NORTH, ELEVATION - 175.83
- 1) ALL DRAINAGE WAYS AND DRAINAGE IMPROVEMENTS SHALL BE DETERMINED AT THE TIME OF PLATTING. A DRAINAGE CONCEPT PLAN SHALL BE PREPARED BY MID-KANSAS ENGINEERING CONSULTANTS.
 - 2) LAKES SHOWN ON THE PLAN ARE CONCEPTUAL AT THIS POINT AND SHALL BE DESIGNED WITH THE FINAL SITE PLAN IN CONFORMANCE WITH THE APPROVED GRADING PLAN.
 - 3) SEE O.U.P. G.P. 14 FOR FINAL STREET PLAN CONSIDERATIONS (WOODLAWN AND 29TH STREET NORTH).

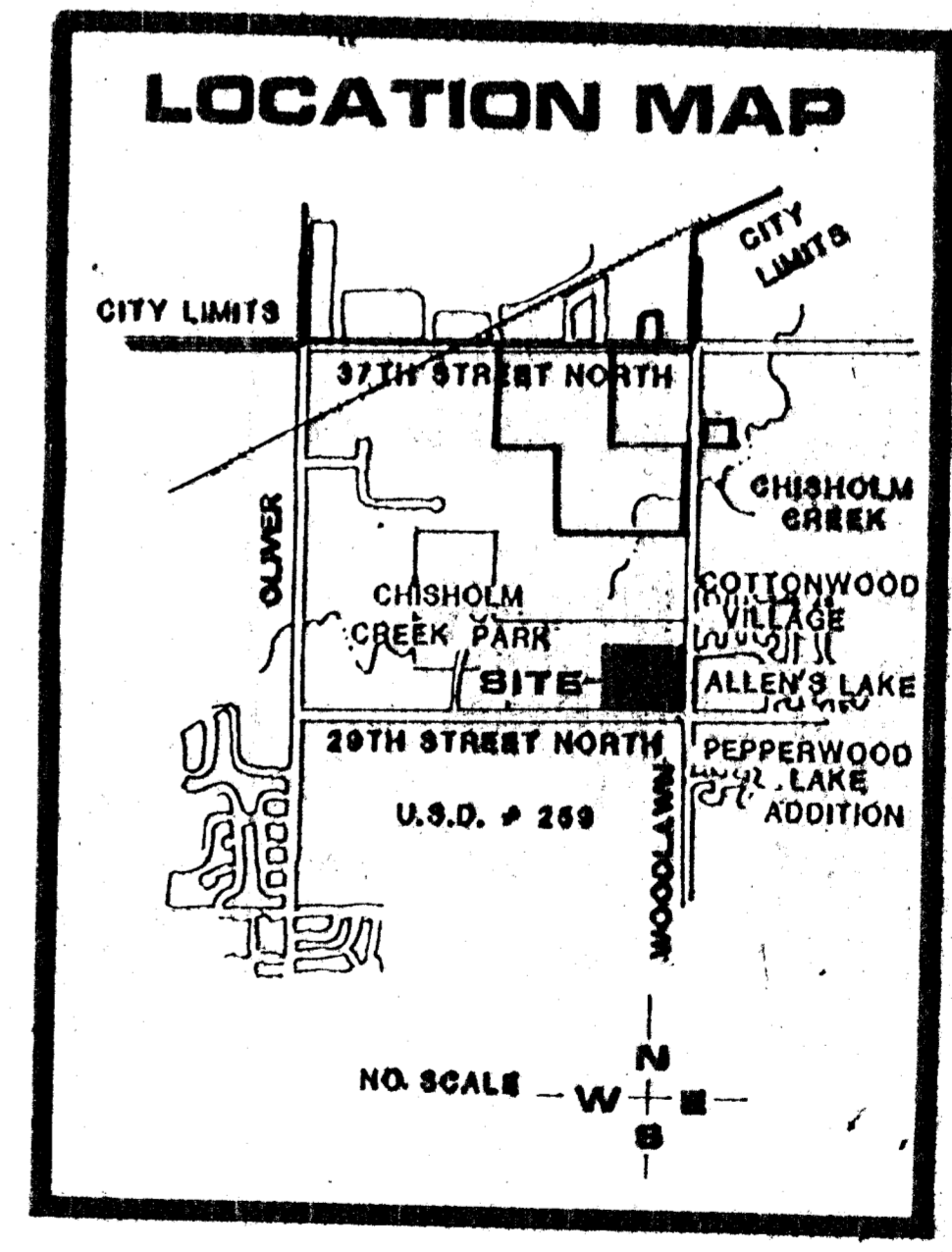

SCALE: 1" = 50'
 CONTOUR INTERVAL = 1'

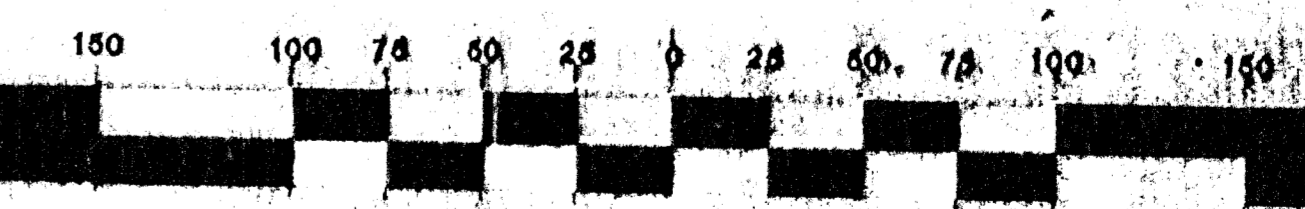

DRAINAGE & UTILITY CONCEPT
THE BOARDWALK

OWNER: WICHITA PARK BOARD, CITY HALL 488 N. MAIN, WICHITA, KS. 67203

DATE: JULY 23, 1997



BILL G. YUNG DESIGN
 4912 E. 29TH STREET NORTH WICHITA, KS 67220 316-683-8687