

**PRELIMINARY PLAT
AIR PRODUCTS 2ND ADDITION**

A TRACT IN THE NE 1/4 OF SEC. 33, 28-S, R-1W TOGETHER WITH, AND BEING A REPLAT OF LOT 2, AIR PRODUCTS ADDITION, SEDGWICK COUNTY, KANSAS

OWNER: AIR PRODUCTS AND CHEMICALS, INC.

UNPLATTED
KAREN L. JANK

UNPLATTED
CARL E. BECKER

1004.52
S 89° 22' 42" W

630
S 89° 22' 42" W

850
S 00° 00' W

70-2-1 JULY 15, 1984

BAUGHMAN COMPANY, P.A.
3100 W. 101st St., Suite 100, Overland Park, KS 66204
PH: 353-2200

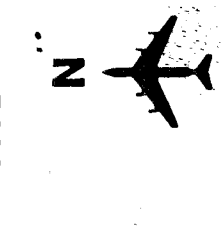
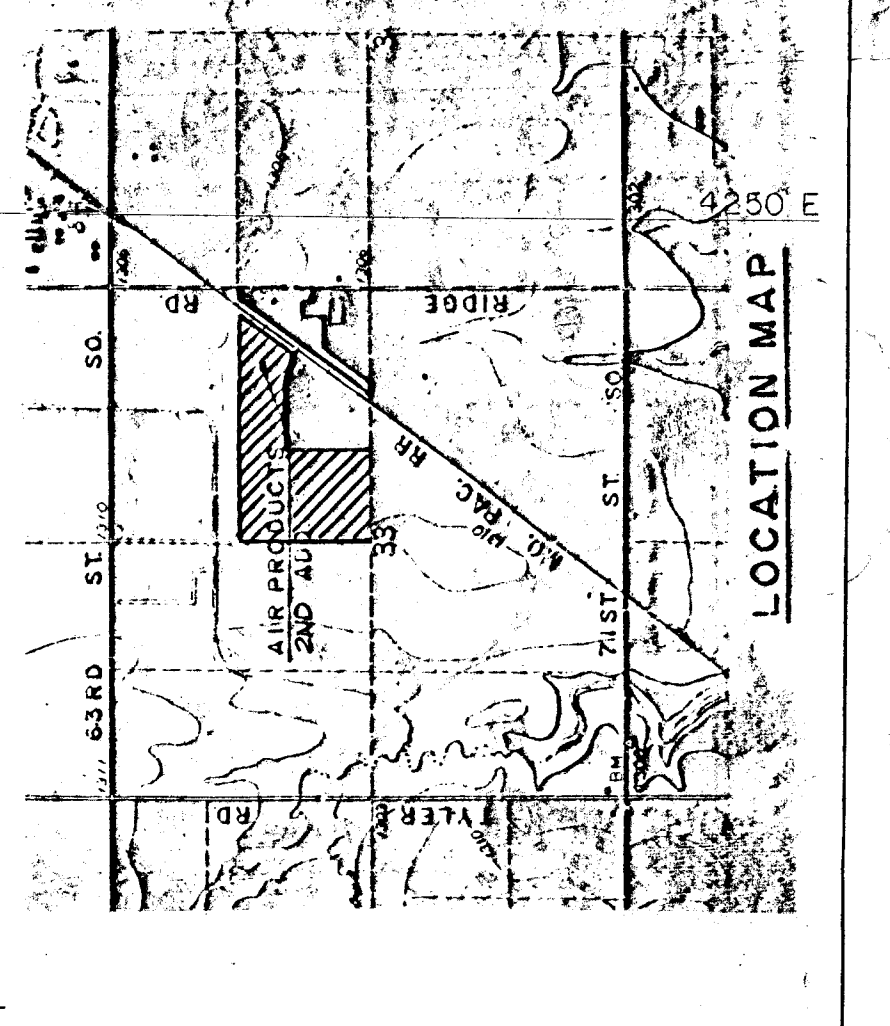

CONTOUR INTERVAL: 1 FT.
VERTICAL DATUM: NGVD 29
HORIZONTAL DATUM: NAD 83
SCALE: AS SHOWN
DATE: 7/15/84

10' Kansas Gas and Electric Easement (Book Mfg. 456, Page 178)

10' Kansas Gas and Electric Easement (Book Mfg. 456, Page 178)

10' Kansas Gas and Electric Easement (Book Mfg. 456, Page 178)

10' Kansas Gas and Electric Easement (Book Mfg. 456, Page 178)

10' Kansas Gas and Electric Easement (Book Mfg. 456, Page 178)

10' Kansas Gas and Electric Easement (Book Mfg. 456, Page 178)

10' Kansas Gas and Electric Easement (Book Mfg. 456, Page 178)

10' Kansas Gas and Electric Easement (Book Mfg. 456, Page 178)

10' Kansas Gas and Electric Easement (Book Mfg. 456, Page 178)

10' Kansas Gas and Electric Easement (Book Mfg. 456, Page 178)

10' Kansas Gas and Electric Easement (Book Mfg. 456, Page 178)

10' Kansas Gas and Electric Easement (Book Mfg. 456, Page 178)

10' Kansas Gas and Electric Easement (Book Mfg. 456, Page 178)

10' Kansas Gas and Electric Easement (Book Mfg. 456, Page 178)

10' Kansas Gas and Electric Easement (Book Mfg. 456, Page 178)

10' Kansas Gas and Electric Easement (Book Mfg. 456, Page 178)

10' Kansas Gas and Electric Easement (Book Mfg. 456, Page 178)

10' Kansas Gas and Electric Easement (Book Mfg. 456, Page 178)

10' Kansas Gas and Electric Easement (Book Mfg. 456, Page 178)

10' Kansas Gas and Electric Easement (Book Mfg. 456, Page 178)

10' Kansas Gas and Electric Easement (Book Mfg. 456, Page 178)

10' Kansas Gas and Electric Easement (Book Mfg. 456, Page 178)

10' Kansas Gas and Electric Easement (Book Mfg. 456, Page 178)

10' Kansas Gas and Electric Easement (Book Mfg. 456, Page 178)

10' Kansas Gas and Electric Easement (Book Mfg. 456, Page 178)

10' Kansas Gas and Electric Easement (Book Mfg. 456, Page 178)

10' Kansas Gas and Electric Easement (Book Mfg. 456, Page 178)

10' Kansas Gas and Electric Easement (Book Mfg. 456, Page 178)

10' Kansas Gas and Electric Easement (Book Mfg. 456, Page 178)