

SCALE 1"=100'  
DATE DEC 9, 1980

BM Railroad Spike in Highline Pole along North R/W line of Wichita Valley Center Floodway 58.4' East, Southeast of Intersection of R/W line with West line of SE 1/4, Sec 34, T27S, R1E of the 6th PM  
Elev 1256.19 ms

Zoning on this property - Approved "R-1"  
For Street Grades see Drainage Plan  
C.A.C. = Complete Access Control

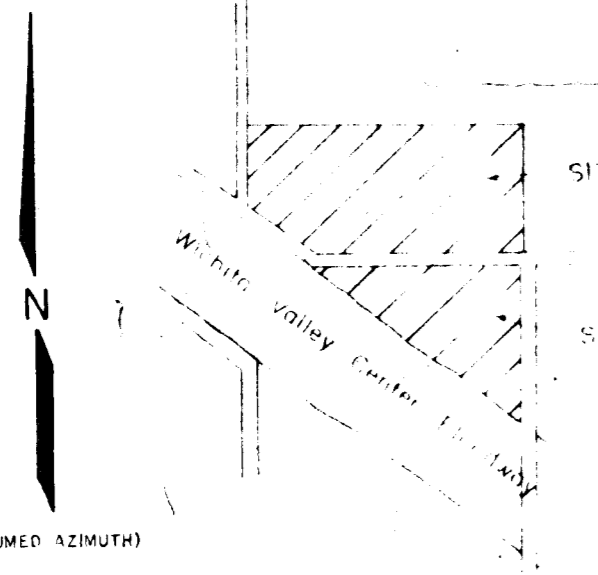

TOPOGRAPHIC MAP OF LANDS LOCATED AT  
SEC. 34 28S/1E.  
SEC. 3 29S/1E.  
SEDGWICK COUNTY, KANSAS  
ENGINEERING & SURVEYING  
ALLIED LABORATORIES

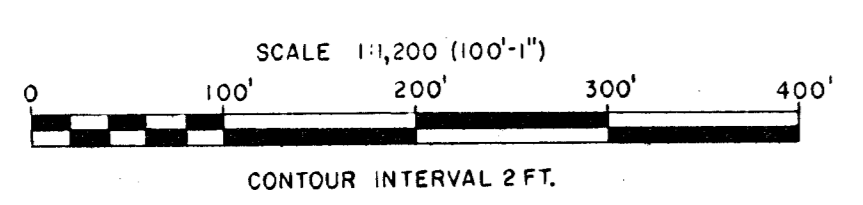

PHOTOGRAMMETRY BY  
MILES AIR PHOTO SURVEY  
WICHITA, KANSAS 67202  
1978 1:2500 FILE # 108 P-11

AERIAL PHOTOGRAPHY  
TYPE: PANORAMA, 4x4, F-11  
DATE: 10/25/77, 4:30 P.M.  
DATE: 10/25/77, 4:30 P.M.  
DATE: 10/25/77, 4:30 P.M.

OWNER / DEVELOPER: BLOOD ORCHARDS, INC.  
6346 S BROADWAY  
WICHITA, KANSAS

ENGINEER: PROFESSIONAL ENGINEERING CONSULTANTS P.A.  
1440 E ENGLISH  
WICHITA, KANSAS 67211

# APPLEWOOD FARMS ...

## PRELIMINARY PLAT

### UTILITY SCHEDULE

- 1. Sanitary Sewer - not available
- 2. Storm Sewer - not available
- 3. Water - not available
- 4. Gas Lines - none existant
- 5. Telephone - not available
- 6. Power in Business District Grove
- 7. 4 KV 10-2 Line (2) Overhead \*
- 8. Gas - not available

\* All proposed power lines to be overhead