

NOTES

- 1) BENCHMARK: MAIZE AND 9TH STREET NORTH, CITY OF WICHITA DISC. 32' NORTH AND 38' EAST OF QUARTER SECTION CORNER. ELEV. - 152.283 CITY DATUM.
- 2) ZONED AA UNDER HUNTINGTON PLACE C.U.P., D.P.-152.
- 3) DRAINAGE CONCEPT PLAN TO BE PREPARED BY BAUGHMAN COMPANY.
- 4) RESERVE "A" TO PERMIT DRAINAGE, DRAINAGE STRUCTURES, LAKES, LANDSCAPING, SIDEWALKS, GAZEBOS, RECREATION FACILITIES, AND UTILITIES CONFINED TO EASEMENTS.

J-26B
LAT. 221
S.W. INTERCEPTOR

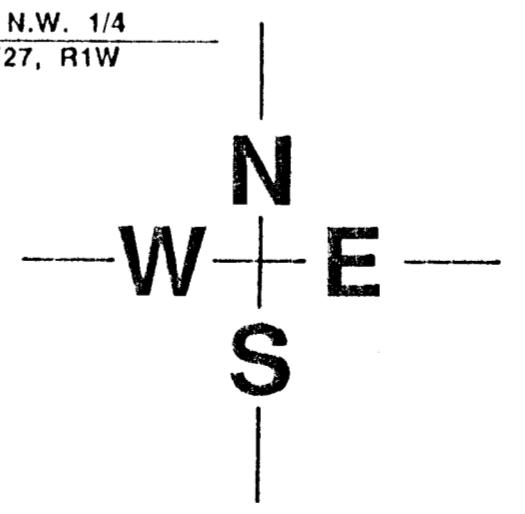

SCALE: 1" = 100'
CONTOUR INTERVAL = 1'

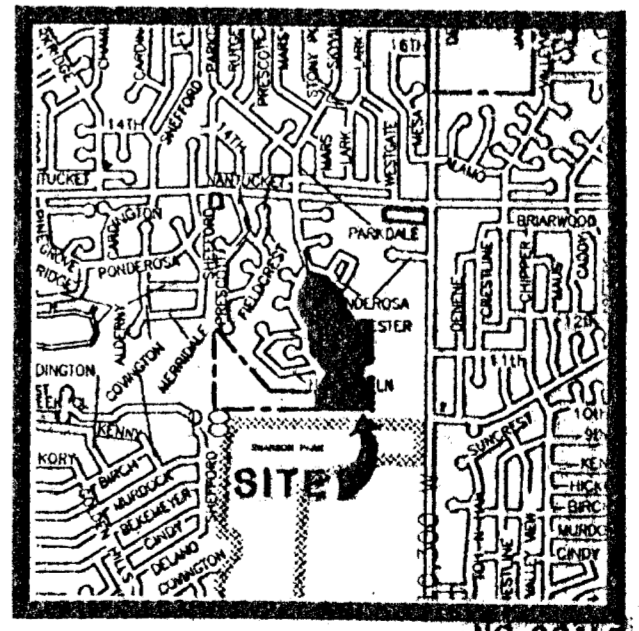

LOCATION MAP

PRELIMINARY PLAT

DRAINAGE / UTILITY CONCEPT

ARLINGTON PLACE 2ND ADDITION

OWNER: ARLINGTON PLACE INC., 1147 COACH HOUSE COURT, WICHITA, KANSAS 67235

BILG YUNG DESIGN

1147 COACH HOUSE COURT
WICHITA, KANSAS 67235
PH: 316.262.6666
WWW.BILGYUNGDESIGN.COM

SHEET	PROJECT	DATE	REV
01	ARLINGTON PLACE 2ND ADDITION	11/15/2011	1