

PRELIMINARY PLAT
FLIGHT TRAINING
CENTER ADDITION

Part of Block 6, all of Blocks 7 and 8, together with the Alley in Block 8, Wells St. and part of Hoyt Ave. and part of the SW 1/4 of Sec. 16, Twp. 27S, R-2-E

BEECH AIRCRAFT CORPORATION

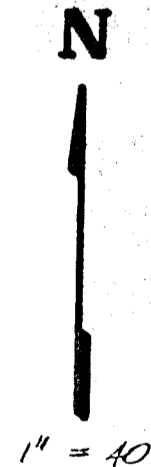
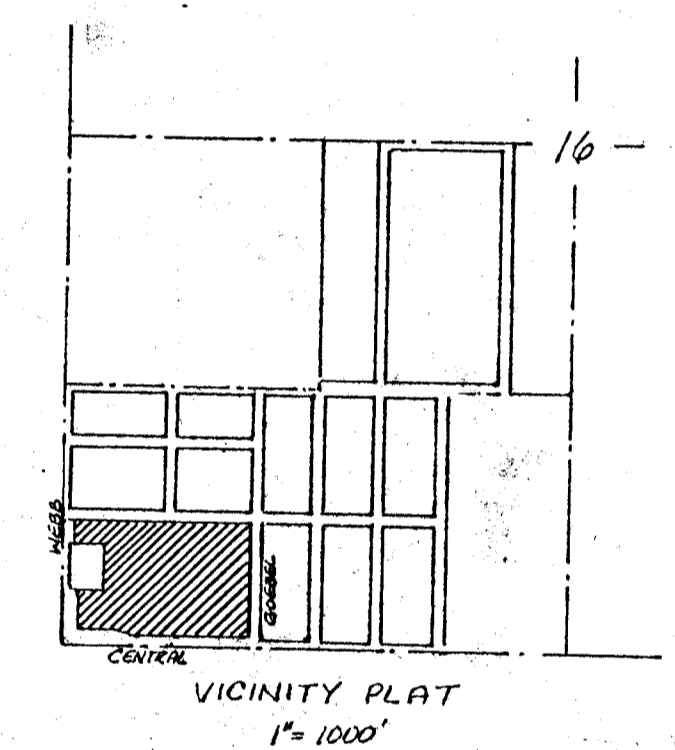

BENCH MARK:
 Standard Disc, Top of Head Wall
 North end of R.C.B.C. on East
 Side of Webb Rd. 275' ± North
 of E. Central Ave.
 Elevation = 1360.32 Mean Sea Level

1" = 40'
 Elev. = M.S.L.