

3M. 119.9' 1/2" cut 100' ch. # N end radius as N.M. Cor. Kessler & Central
 3M. 123.44 S.E. Cor. conc. porch Nos. 159 N. Kessler

1123 TO RT. IRON ON # STA. 310
 14.53' N.M. TO S.E. Cor. Brick Nos. 297
 62.52' N.M. TO N.E. Cor. Brick Garage

Scale: 1" = 20' N
 +0.126%

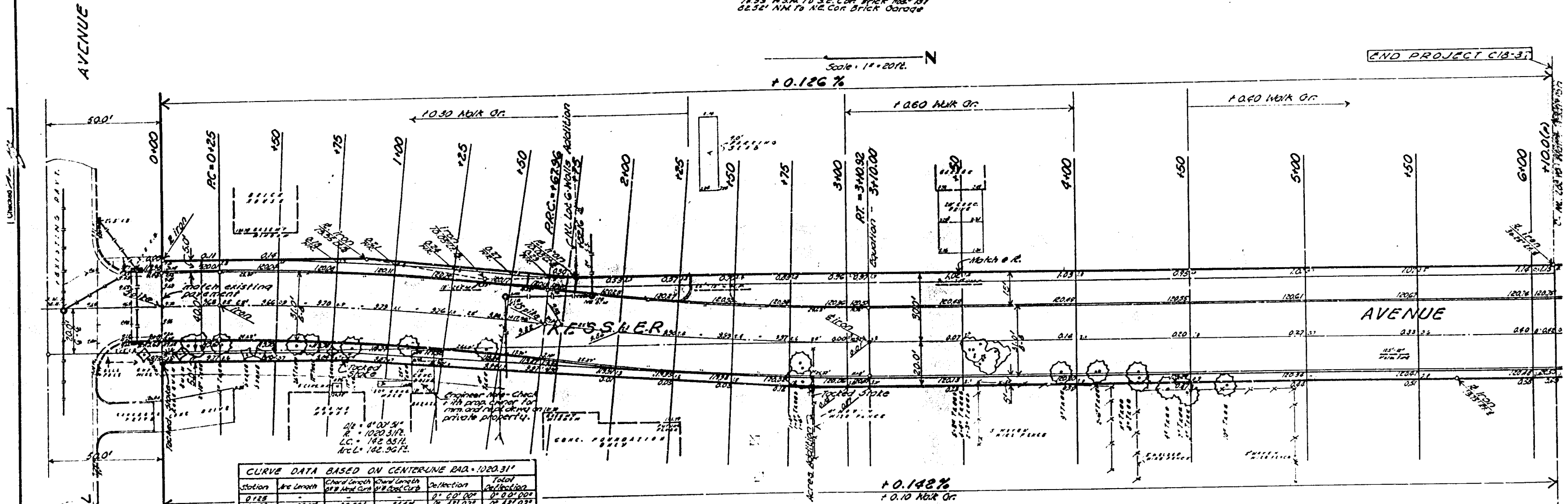

CURVE DATA BASED ON CENTERLINE B.M. 1020.31'

Station	Arc Length	Chord Length	Chord Length	Deflection	Tangent
		Old Curve	New Curve		
0+00	0.00	0.00	0.00	0° 00' 00"	0.00
0+25	25.00	24.88	24.88	0° 00' 00"	0.00
0+50	50.00	49.76	49.76	0° 00' 00"	0.00
0+75	75.00	74.64	74.64	0° 00' 00"	0.00
1+00	100.00	99.52	99.52	0° 00' 00"	0.00
1+25	125.00	124.40	124.40	0° 00' 00"	0.00
1+50	150.00	149.28	149.28	0° 00' 00"	0.00
1+75	175.00	174.16	174.16	0° 00' 00"	0.00
2+00	200.00	199.04	199.04	0° 00' 00"	0.00
2+25	225.00	223.92	223.92	0° 00' 00"	0.00
2+50	250.00	248.80	248.80	0° 00' 00"	0.00
2+75	275.00	273.68	273.68	0° 00' 00"	0.00
3+00	300.00	298.56	298.56	0° 00' 00"	0.00
3+25	325.00	323.44	323.44	0° 00' 00"	0.00
3+50	350.00	348.32	348.32	0° 00' 00"	0.00
3+75	375.00	373.20	373.20	0° 00' 00"	0.00
4+00	400.00	398.08	398.08	0° 00' 00"	0.00
4+25	425.00	422.96	422.96	0° 00' 00"	0.00
4+50	450.00	447.84	447.84	0° 00' 00"	0.00
4+75	475.00	472.72	472.72	0° 00' 00"	0.00
5+00	500.00	497.60	497.60	0° 00' 00"	0.00
5+25	525.00	522.48	522.48	0° 00' 00"	0.00
5+50	550.00	547.36	547.36	0° 00' 00"	0.00
5+75	575.00	572.24	572.24	0° 00' 00"	0.00
6+00	600.00	597.12	597.12	0° 00' 00"	0.00
6+25	625.00	622.00	622.00	0° 00' 00"	0.00
6+50	650.00	646.88	646.88	0° 00' 00"	0.00
6+75	675.00	671.76	671.76	0° 00' 00"	0.00
7+00	700.00	696.64	696.64	0° 00' 00"	0.00
7+25	725.00	721.52	721.52	0° 00' 00"	0.00
7+50	750.00	746.40	746.40	0° 00' 00"	0.00
7+75	775.00	771.28	771.28	0° 00' 00"	0.00
8+00	800.00	796.16	796.16	0° 00' 00"	0.00
8+25	825.00	821.04	821.04	0° 00' 00"	0.00
8+50	850.00	845.92	845.92	0° 00' 00"	0.00
8+75	875.00	870.80	870.80	0° 00' 00"	0.00
9+00	900.00	895.68	895.68	0° 00' 00"	0.00
9+25	925.00	920.56	920.56	0° 00' 00"	0.00
9+50	950.00	945.44	945.44	0° 00' 00"	0.00
9+75	975.00	970.32	970.32	0° 00' 00"	0.00
10+00	1000.00	995.20	995.20	0° 00' 00"	0.00

Deflection per 100' = 1.2346 mins.

+0.122%
 +0.10 Walk Gr.

NOTE TO FIELD ENGINEER & CONTRACTOR - Grade Parking and curb 20" for proposed sidewalk. Compact fill in sidewalk area, sidewalk to be constructed by OTHERS.

ALL LOTS - West Side Across Adjoining

CARTHWORK
 EXCAV. 1594.4
 133.6 110%
 1753.8 C.Y.
 FILL 26
 2.8 110%
 30 C.Y.

KESSLER AVENUE
 N.E. Central Avenue to
 N.E. Lot 10 - Walks Addition
 300' Concrete and Curb
 City of Wichita, Kan.
 B.E. Smith City Engineer
 Date: Oct. 1926 Proj. No. C.18