

# COUNTRY VILLAGE ADDITION

PRELIMINARY PLAT  
(A REPLAT OF ECHO HILLS AND ADDITION)

SCALE 1" = 100'  
 CONTIGUOUS PLAT NO. 2  
 PHOTOGRAPHY DATE SEPT. 8, 1979

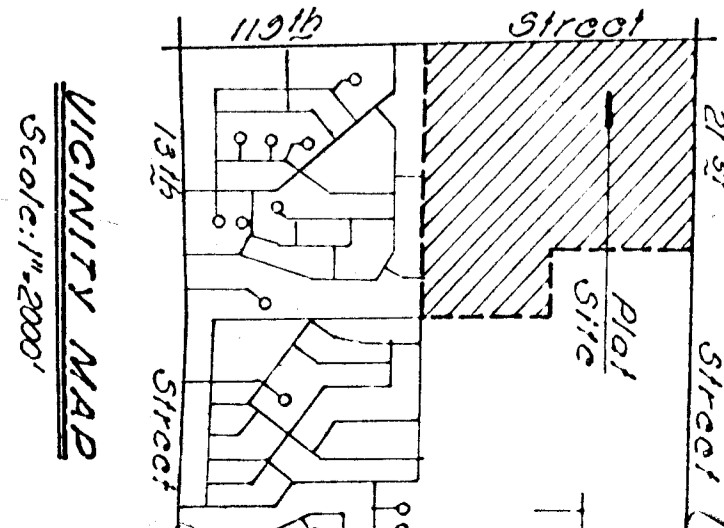

- PHASE I
- PHASE II
- PHASE III
- PHASE IV
- PHASE V
- UNPLATTED

UNPLATTED