

ZONED AA

ZONED LC

ZONED AA

ZONED AA

STARKEY DEVELOPMENT CENTER

AN ADDITION TO WICHITA, SEDGWICK COUNTY, KANSAS

SKETCH PLAN

STARKEY DEVELOPMENT CENTER, INC.
 William E. Beaton, Executive Director
 144 S. Young
 Wichita, KS 67209
 PH (316) 942-4271

The west 170.5 feet of Lots 1, 2, 3, 4, and 5, except the south 200 feet thereof; and the east 98.5 feet of Lot 1, except the south 200 feet thereof; and the N1/2 of Lot 8, and all of Lot 9, McComas Acres Sedgwick County, Kansas, and all of Lot 1, Sedgwick County, Kansas.

DRAINAGE PLAN

DRAINAGE CALCULATIONS

AREA	SIZE	C	Q5	Q100
A	1.4 AC	0.5	3.2 CFS	5.2 CFS
B	4.3 AC	0.8	15.7 CFS	25.3 CFS
C	2.7 AC	0.8	9.8 CFS	16.0 CFS
D	0.9 AC	0.8	3.7 CFS	6.0 CFS

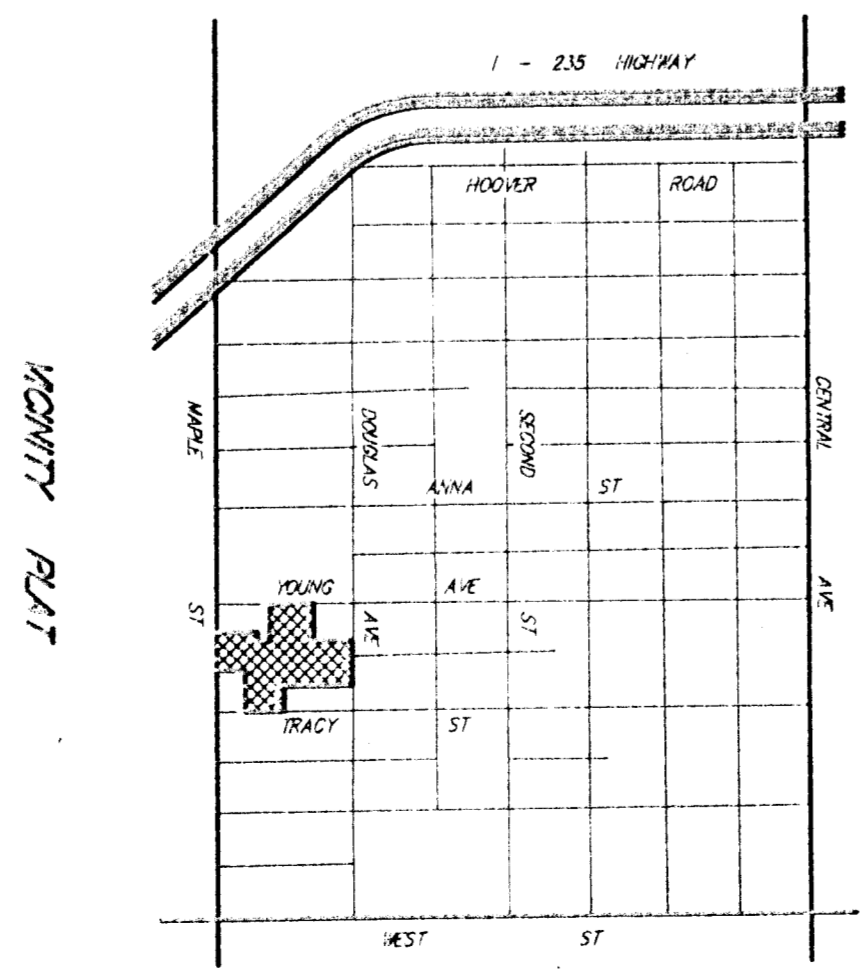

1" = 50'
 ELEV = CITY DATUM