

Note: Return this drawing to office.

3630 GAL / AK-1/DW
125 GAL / PER / DW



UNPLATTED K.T. WIEDEMANN TRUST "R-1" "LC"

UNPLATTED "R-1" CATHOLIC DIOCESE OF WICHITA

WESTLINK VILLAGE 11th ADD. "AA"

1079.01
N.L. Westlink Village 11th

728.6'
N.L. Westlink Village 6th

UNPLATTED AVA JOHNS "LC"

WESTLINK VILLAGE 10th ADD. "LC" "A"

WESTLINK VILLAGE "AA"

8th ADDITION "AA"

PRELIMINARY PLAT
HARVEST HILLS

OWNER / DEVELOPER : AMARADO INVESTMENTS INC.
230 SOUTH MARKET
WICHITA, KANSAS

LAND PLANNER : OBLINGER SMITH CORPORATION
625 FIRST NATIONAL BANK BLDG.
WICHITA, KANSAS

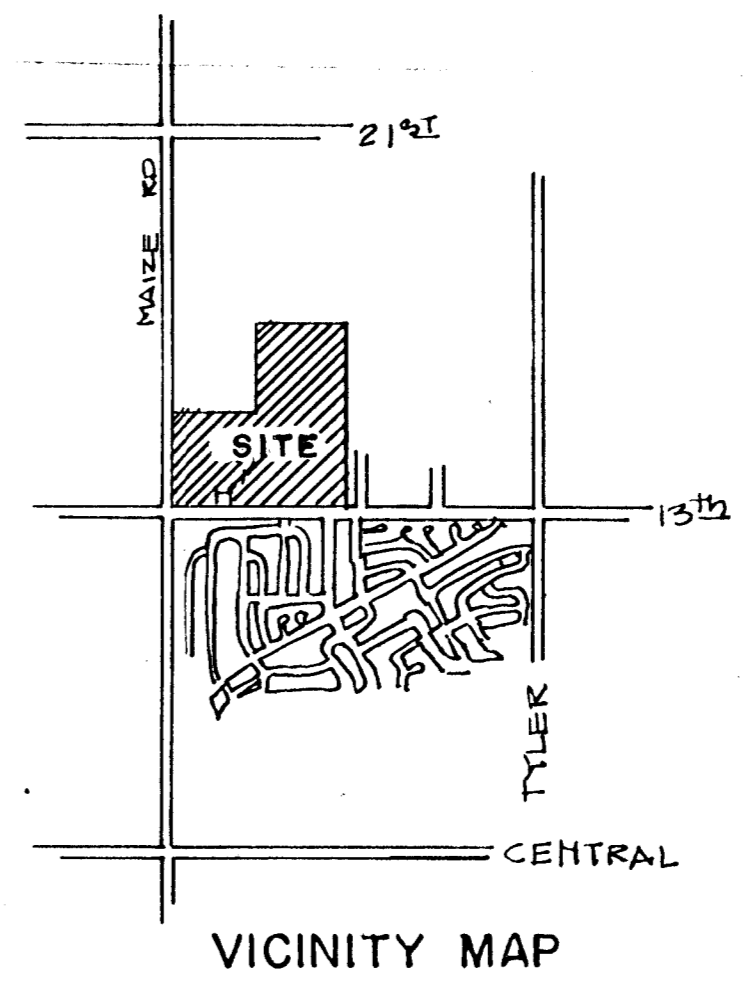
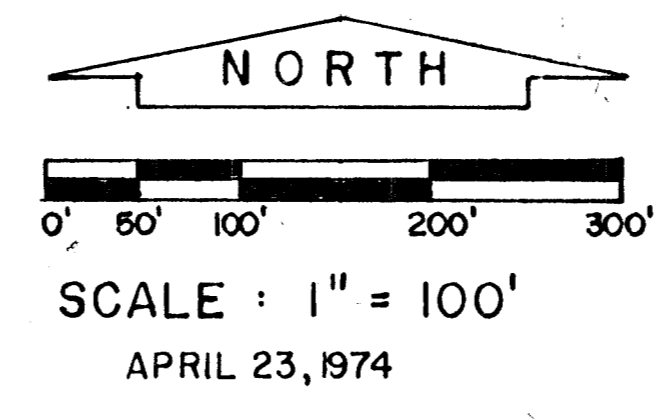

NOTE: SEE ACCOMPANYING "SIDEWALK PLAN" FOR SIDEWALK LOCATIONS
BOUNDARY SURVEY & TOPOGRAPHY BY MOHRING ENGRS.
FEB. 13, 1973