

Unplatted R-1 Board of County Commissioners Sedgwick County, KS.

Unplatted R-1 Board of County Commissioners Sedgwick County, KS.

LOT BLOCK
Zoning: Exist. R-1
Prop. R-1

**PRELIMINARY PLAT OF
FOUR MILE CREEK ADDITION**
Owner/Dev. Board of County Commissioners
c/o James Weber P.E.
1250 South Seneca 67213

Engineer: P.E.C. p.a.
1440 English 67211

SCALE: 1" = 50'
● = Iron set.

B.M. RR. Spike in P. Pole 70'S. & 30'E
of S.E. Cor. Sec. 25, T21S, R2E of
16th. P.M. Elev. = 1287.02 M.S.L.
Topo. as of Jan. 1987.
First Floor Elev = 1200.00 M.S.L.

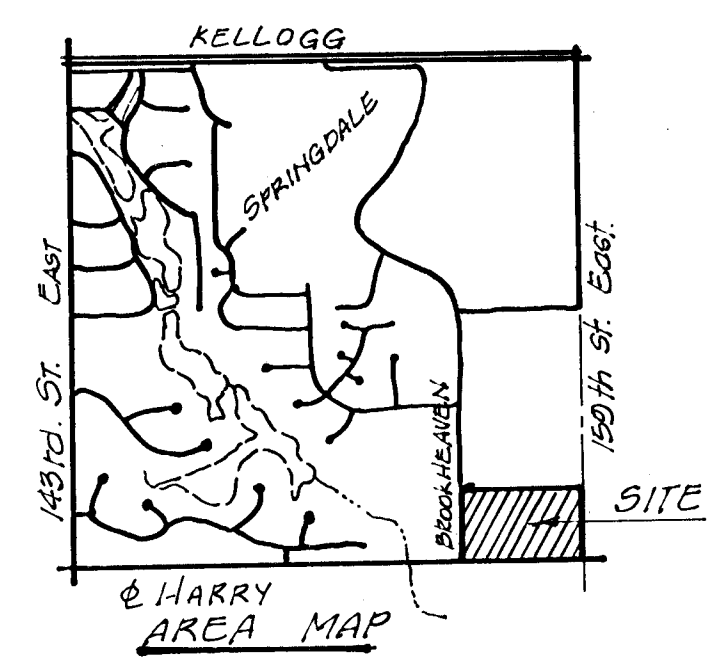

SE CORNER SECTION 25
T21S, R2E

Access Control except for (2) TWO openings

Unplatted R-1

Underground Gas Main & Teleph cable
Elev. 11.34, 41111 overhead Power Line