

DRAINAGE AREA

A = 0.70 ACRES
 C = 0.8
 T_c = 15 MIN.
 i_s = 5.21
 i_s = 6.95
 Q_s = 2.9 C.F.S.
 Q₁₅ = 3.9 C.F.S.

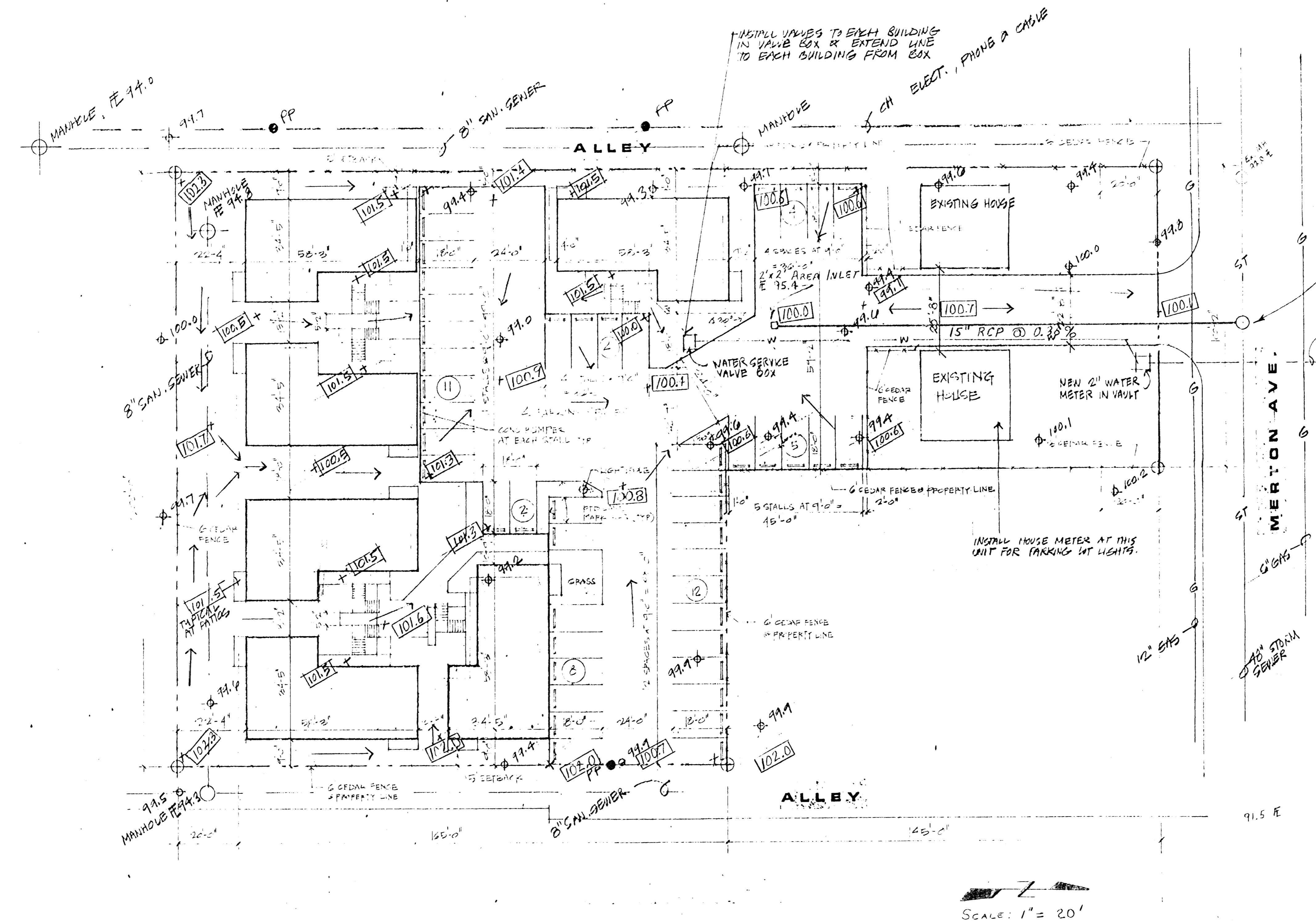

CONSTRUCT 6'x6' REINFORCED CONC. M.H. PER CITY OF WICHITA SPECIFICATIONS.
 FL IN 18" RCP (W) = 94.75
 FL OUT 48" RCP (E) = 91.95 ±
 NEW TAP & ENTRANCE LINE TO METER LOCATION BY CITY

EXISTING GRADES : 100.0
 NEW GRADES : 100.0
 SURFACE DRAINAGE DIRECTION: →

LEGAL DESCRIPTION:
 THE NORTH 1/2 OF LOTS 17 AND 19 EXCEPT THE EAST 10 FEET OF SAID LOT 19, BLOCK N, ON MERTON AVE. IN PRINCESS ADDITION;
 THE SOUTH 1/2 OF LOT 17, THE SOUTH 1/2 AND EAST 10 FEET OF THE NORTH 1/2 OF LOT 19, ALL OF LOTS 21 AND 23; AND THE SOUTH 1/2 OF LOTS 25, 27, 29, AND 31, BLOCK N, PRINCESS ADDITION;
 THE SOUTH 10 FEET OF VACATED ALLEY ADJACENT TO EVEN LOTS 16 THROUGH 32 TO THE NORTH, EXCEPT THE EAST 5 FEET AND WEST 3 FEET OF SAID ALLEY, BLOCK N, ESTIMER AVE., PRINCESS ADDITION
 ALL IN WICHITA, SEDGWICK COUNTY, KS.
 ZONED "R-3"

SCALE: 1" = 20'

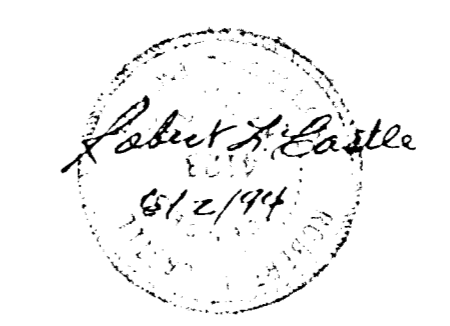

CREW PARTNERSHIP WICHITA, KANSAS	
DRAINAGE PLAN MERTON AVENUE - CREW ADDITION WICHITA, KANSAS	
CASTLE & ASSOCIATES ENGINEERS WICHITA, KANSAS	DWG FILE NO. 9317-D-50.042
DATE 1994	SHEET NO. OF