

UNPLATTED  
 Owner: Inland Investment Co. Inc.  
 10300 W. Central  
 Zoning AA

Owner: Board of Park Commissioners  
 Zoning AA

REVISED PRELIMINARY PLAT  
**GOLDEN HILLS SECOND ADDITION**  
 WICHITA, SEDGWICK COUNTY, KANSAS

H. WILHELM SOLT PRES.  
 OWNER: **SUNRISE ENTERPRISES, LTD.**  
 401 Industrial Road  
 Goddard, Kansas 67052

ENGINEER: PROFESSIONAL ENGINEERING CONSULTANTS, P.A.  
 1440 E. English  
 Wichita, Kansas 67211

Note: All existing bldgs to be removed

Bench Mark: RR spike in wingwall pile 3000' north of Central Ave. and 110th St W. Elev. = 1332.98 M.S.L.

APRIL 12, 1984

Note: All utilities, Gas, Power, Water, San Sewer, Teleph. available in Golden Hills Add.

SCALE 1" = 100'

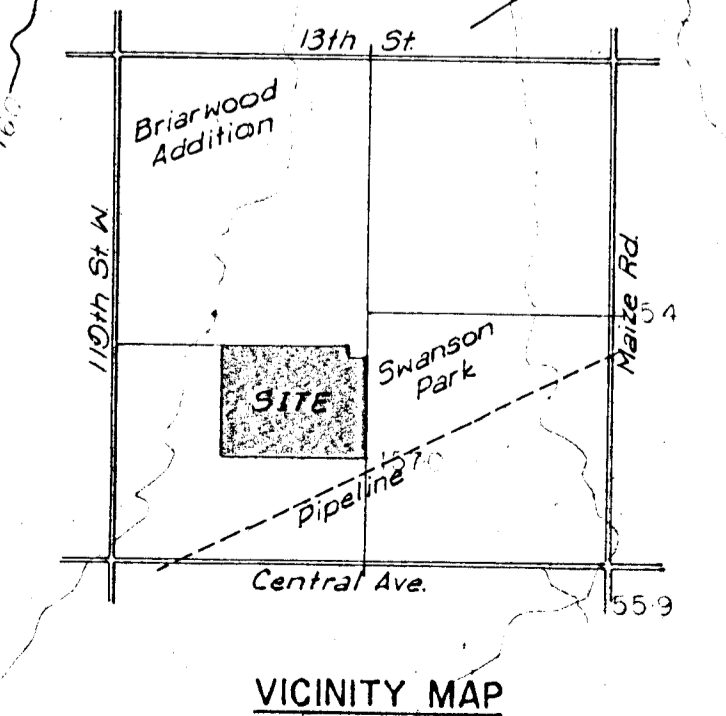

VICINITY MAP