

- NOTES**
- RESERVE F IS RESERVED FOR PRIVATE STREETS, ENTRY MONUMENTS, LANDSCAPED ISLANDS, ENTRY GATES, PARKING, IRRIGATION, LIGHTING, AND UTILITIES CONFINED BY EASEMENTS.
 - RESERVE C ALLOWS SIDEWALKS, LANDSCAPING, IRRIGATION, MAILBOX COMPLEX, COMMUNITY CLUBHOUSE, SWIMMING POOL, PONDS/FOUNTAINS, LIGHTING, AND UTILITIES CONFINED BY EASEMENTS.
 - RESERVES A AND B ALLOWS ENTRY GATES SIGNAGE, LANDSCAPING, BERMS, IRRIGATION, LIGHTING, AND UTILITIES CONFINED BY EASMENTS.
 - RESERVE D AND E ALLOW SIDEWALKS, LANDSCAPING, IRRIGATION, AND UTILITY CONFINED BY EASEMENTS.
 - TOPOGRAPHY PROVIDED BY MKEC, CONTOUR INTERVAL - 2 FT.
 - MKEC WILL PREPARE DRAINAGE AND UTILITY PLANS AND WELL AS INFORMATION ON BENCHMARKS.
 - SUGGESTED UTILITY EASEMENTS ARE SHOWN ON THIS PLAN. FINAL LOCATION WILL BE DETERMINED ON THE FINAL PLAT WHEN THE UTILITY SYSTEMS ARE DESIGNED. UTILITIES WILL BE DEFINED THROUGHOUT THE RESERVES AT THE FINAL PLAT.
 - AREA TO BE REPLANTED IS UNDER THE TALLGRASS CUP (DP -159)

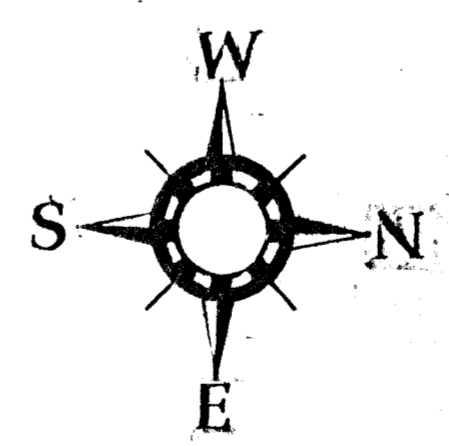
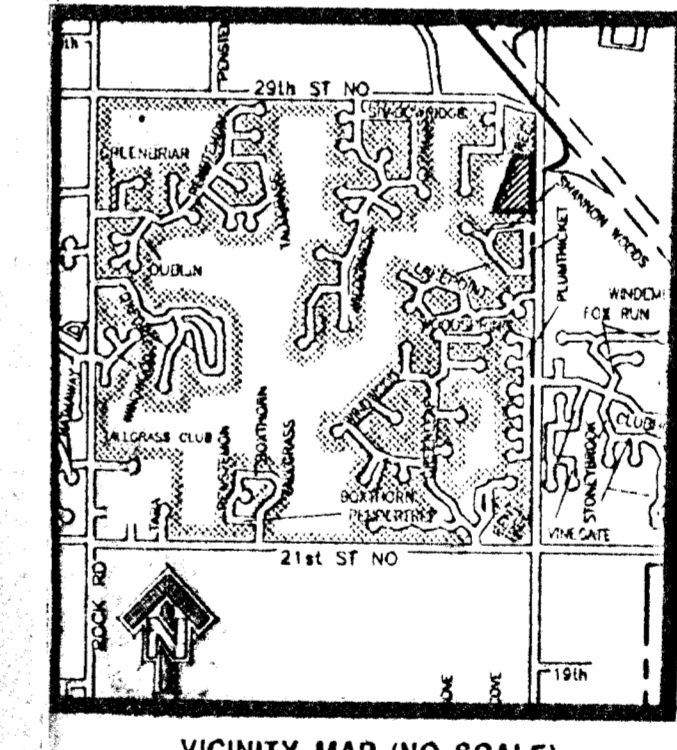

SCALE 1" = 50'
OCTOBER 20, 1995

N.E. COR. SEC. 5
T. 27 S., R. 2 E.

MID-KANSAS ENGINEERING
CONSULTANTS, INC.
411 N. WEBB ROAD
WICHITA, KS. 67206
316-684-9600

OWNER: RICHARD J. & JUANITA E. HATTRUP
2810 BENT TREE W. K. 67226
SUBDIVIDER: LEEWOOD HOMES
3500 NORTH ROCK ROAD W.K. 67226
ENGINEER: MID-KANSAS ENGINEERING CONSULTANTS
411 NORTH WEBB ROAD 67206

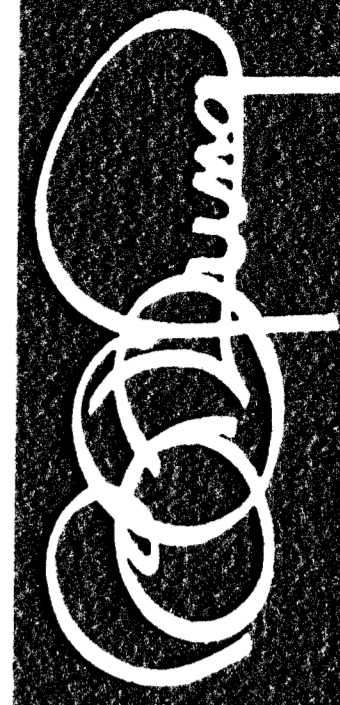

YUNG DESIGN GROUP
BRANSON OFFICE • 1821 W. HIGHWAY 76, SUITE 7 • BRANSON, MO 65616
PH: 417-336-6285 • FAX: 417-336-6286
WICHITA OFFICE • 4912 E. 20TH STREET NORTH • WICHITA, KS 67220
PH: 316-685-5887 • FAX: 316-685-9286

DATE OCTOBER 20, 1995
REV.

SHEET TITLE

PROJECT PROJECT NO.

SHEET OF

DRAINAGE / UTILITY CONCEPT
A REPLAT OF LOT 24 BLOCK 1 FOX POINTE ADDITION
FOX POINTE SECOND ADDITION

WICHITA AIRPORT AUTHORITY

K-96
RAMP