

LEDGEND:

- W = Water Main
- U.E. = Underground Electric
- O.E. = Overhead Electric
- O.T. = Overhead Telephone
- O.C. = Overhead Cable T.V.
- F.H. = Fire Hydrant
- S.S. = Sanitary Sewer
- S.W.S. = Storm Water Sewer
- P.L. = Property Line
- P. = Platfiled
- T.C. = Top of Curb
- FL. = Flow Line of Curb

# FRAZEY ADDITION

## VICINITY MAP

Commencing 50 feet South of the Southeast Corner of Lot 215, on Topeka Avenue, in Stafford and Wright's Addition to Wichita; thence West 150 feet; thence South 70 feet; thence East 150 feet; thence North 70 feet to the place of beginning.  
 AND ALSO  
 Beginning 120 feet South of the Southeast Corner of Lot 215, on Topeka Avenue in said Addition; thence South 78 feet; thence West 150 feet; thence North 78 feet; thence East 150 feet to the place of beginning.

## SITE DRAINAGE PLAN

DRAINAGE SHALL BE ACCOMPLISHED, AS INDICATED, VIA APPROVED OPENINGS SUCH AS DRIVES & FLUMES

MOHRING & ASSOCIATES  
 CONSULTING ENGINEERS  
 WICHITA

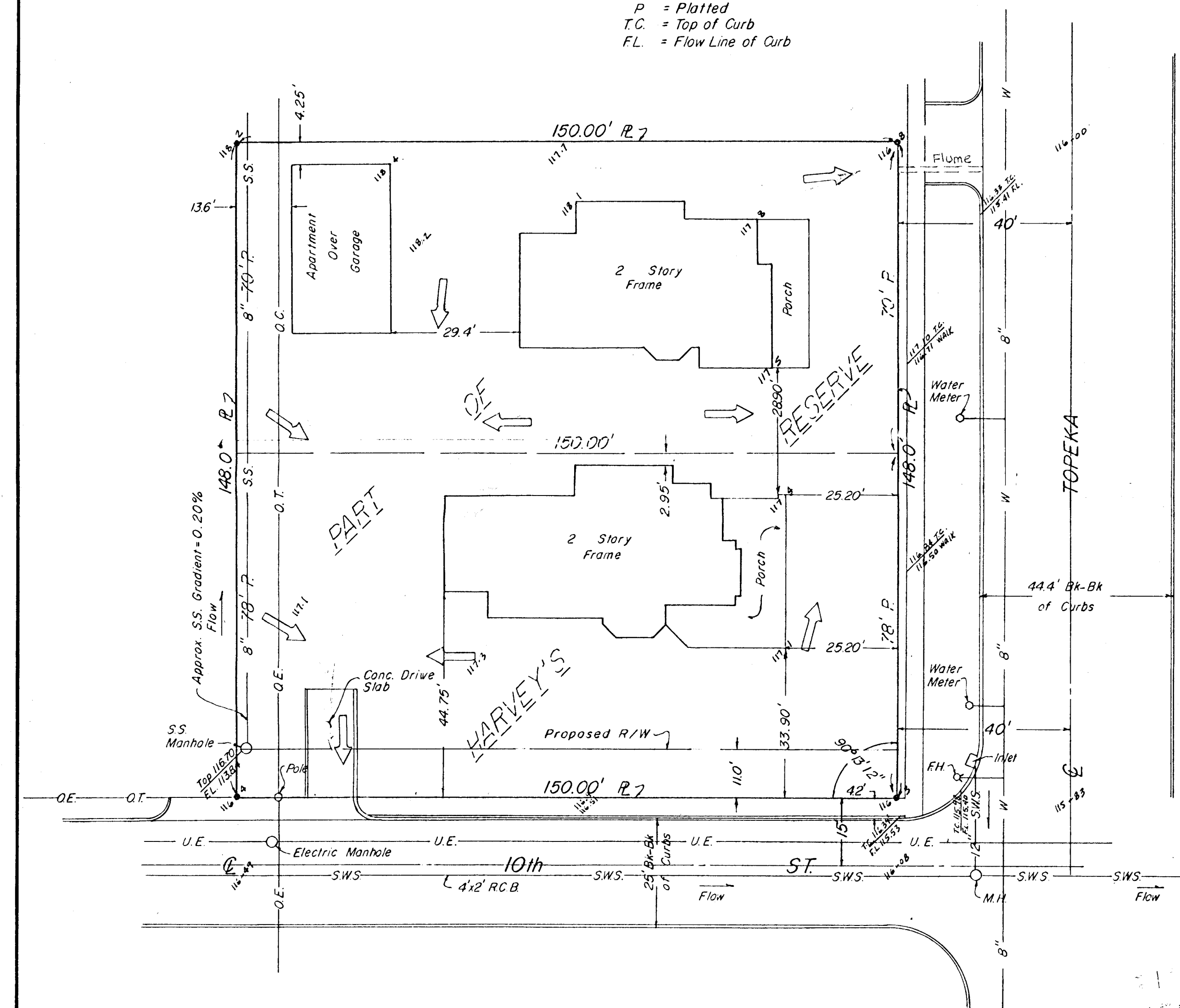

SITE BENCH MARK:  
 "T" in Troy on top of Fire Hydrant at S.E. Prop. Cor. Elev. 118.17, City Datum.

*Handwritten notes:*  
 1. 10th St. via App. 1  
 2. 10th St. via App. 2  
 3. 10th St. via App. 3  
 4. 10th St. via App. 4  
 5. 10th St. via App. 5

