

230 Pettie, Suite 2  
 Lincoln, Kansas • 67201  
 Phone: 783-8261  
 Fax: 783-8261

Parker Associates, Inc.  
 Issue

THURSDAY APARTMENTS  
 1001 S. 10TH AVE  
 LINCOLN, KANSAS

Date \_\_\_\_\_  
 Project \_\_\_\_\_

SUN

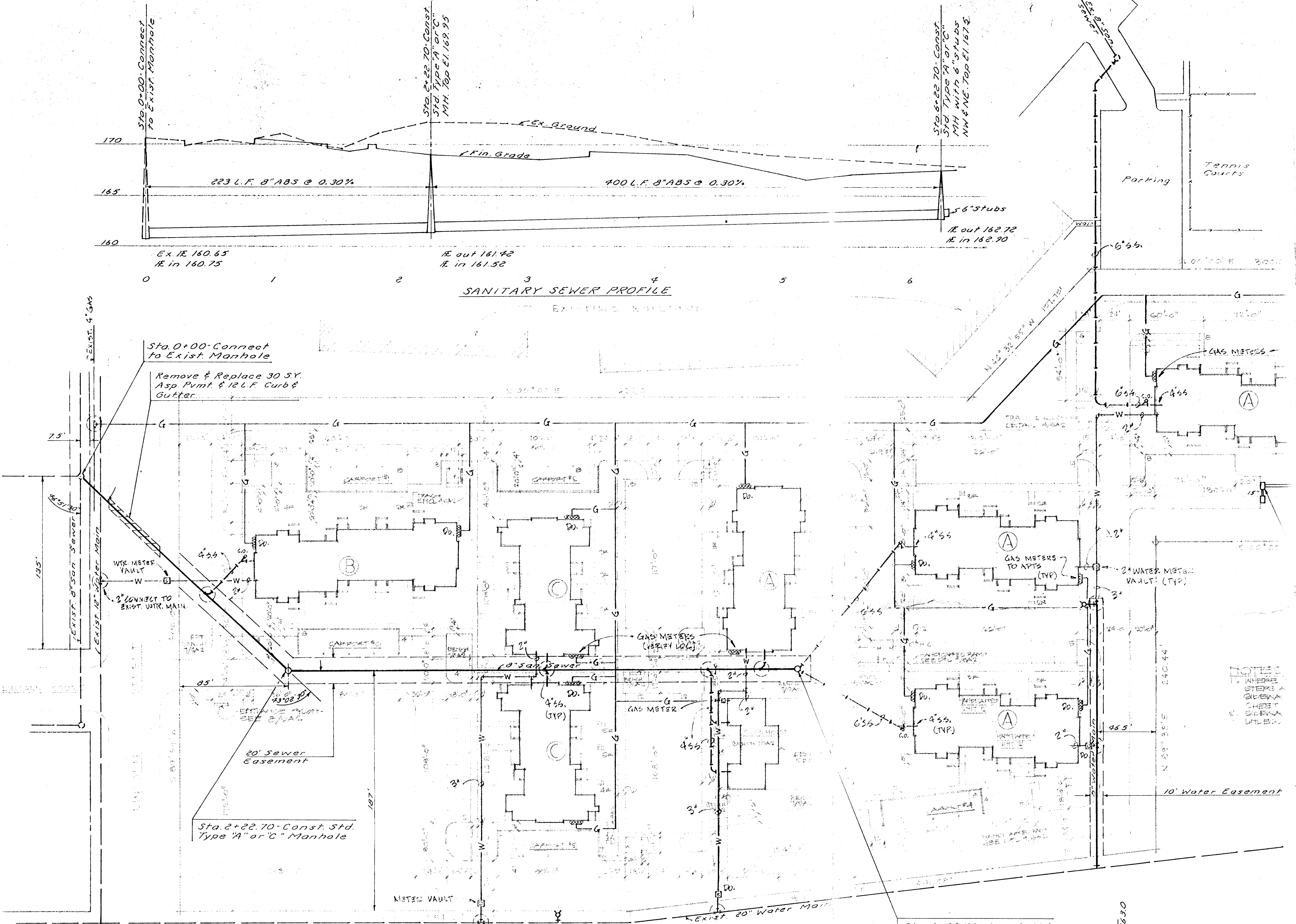

Const. 3 Type 1 Inlets  
 Install 45 L.F. 18" Pipe  
 with End Section. Connect  
 Inlets with 2' 4 L.F. Lengths  
 15" Pipe

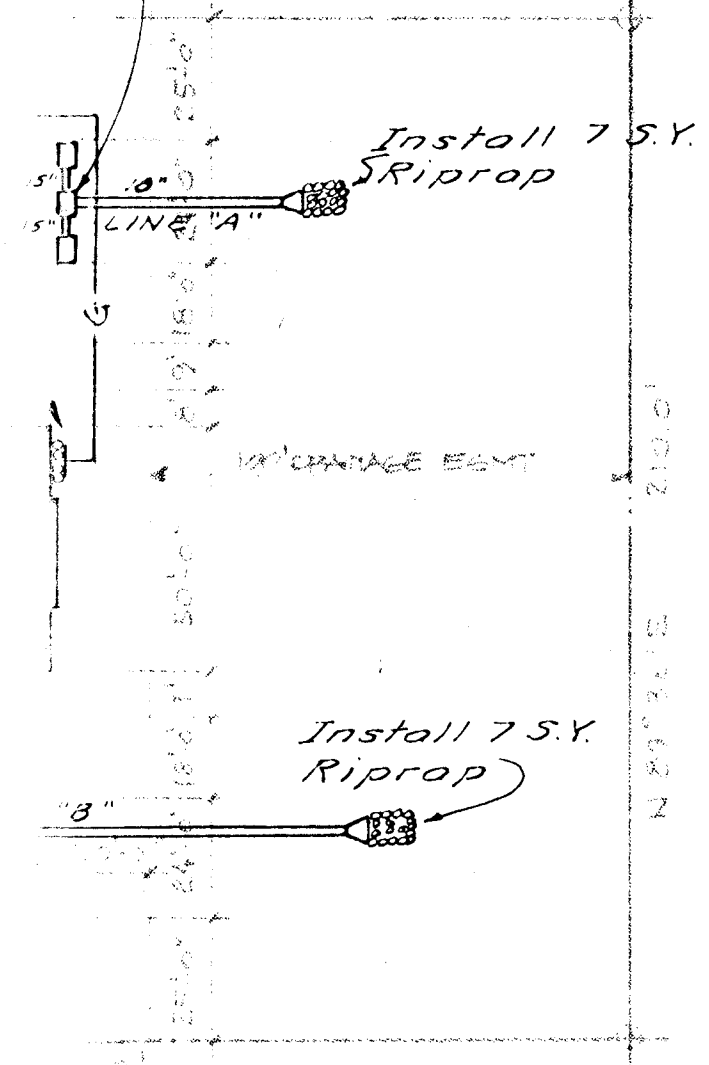

Const. 2 Type 1 Inlets  
 all 105 L.F. 15" Pipe  
 with End Section. Connect  
 Inlets with 2' 4 L.F. 15" Pipe

NOTES:  
 1. REFER TO SHEET 100-100-000-002 FOR GENERAL NOTES.  
 2. SEE SHEET 100-100-000-003 FOR UTILITY LOCATIONS.  
 3. SEE SHEET 100-100-000-004 FOR EASEMENT LOCATIONS.

Note: San sewer Contractor shall maintain one lane open to traffic on Lincoln during construction of the sanitary sewer.

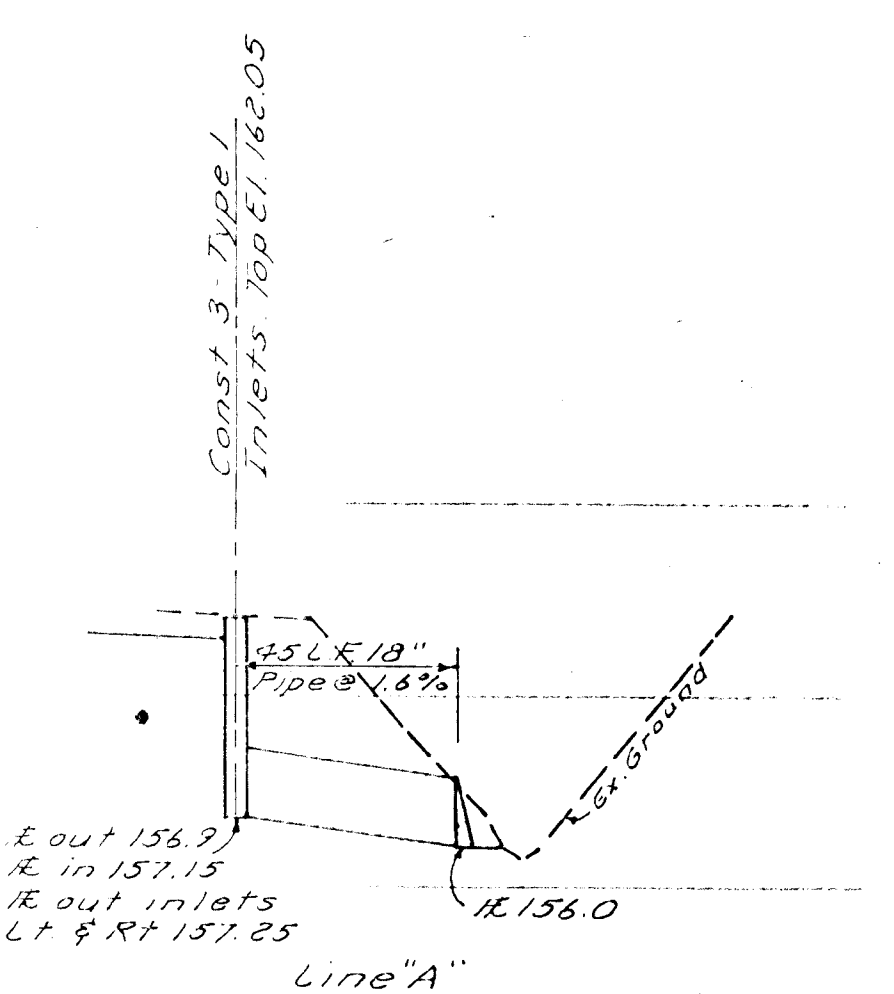
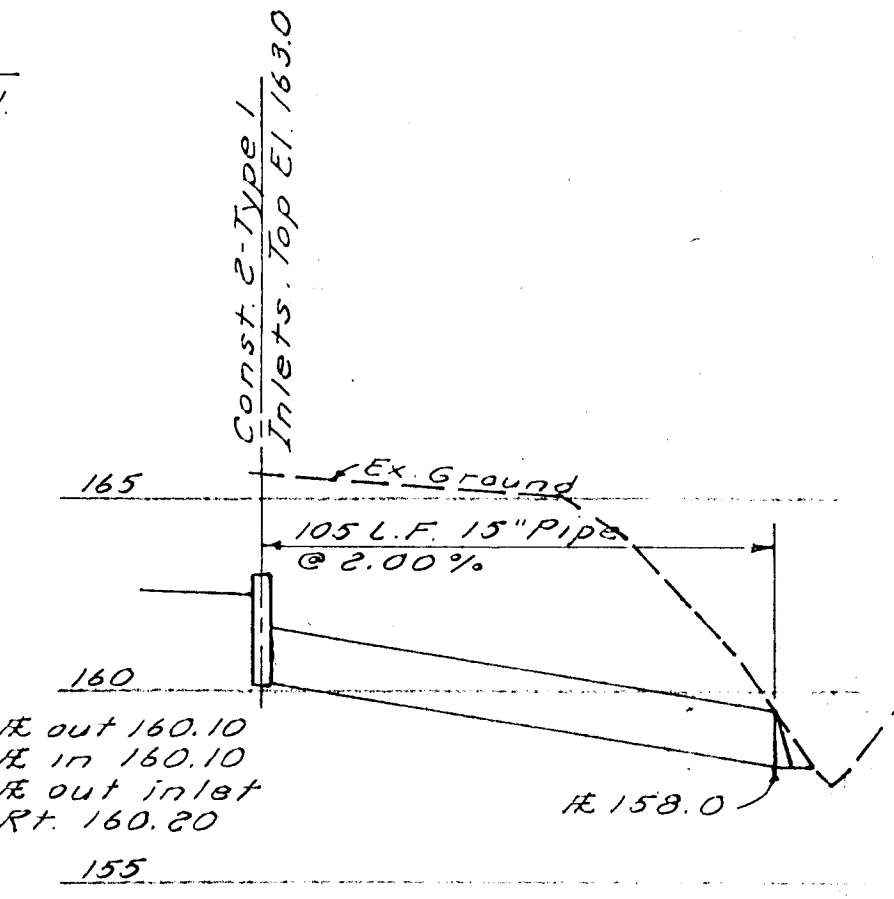
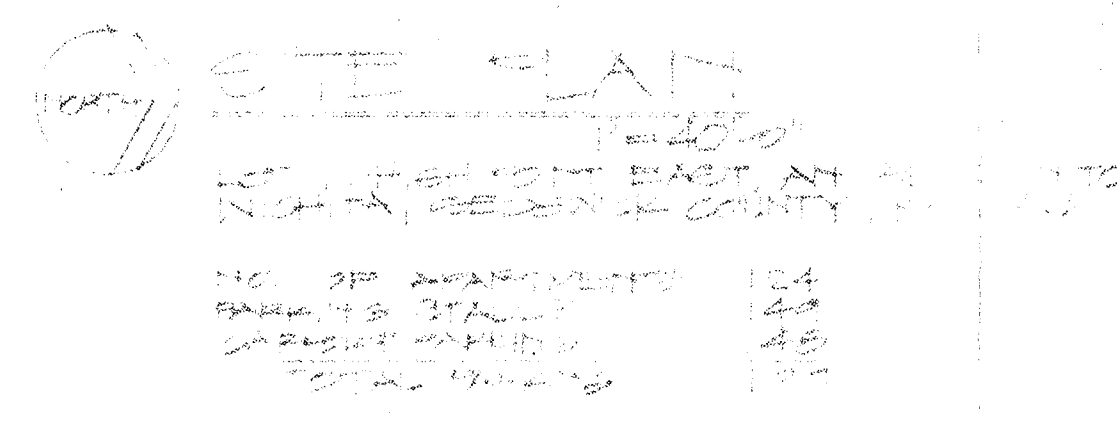

570 SEWER PROFILES