

M.H.  
Top W Rim 128.93  
FL in (N) 120.58  
FL out (S) 120.58

M.H.  
Top W Rim 126.37  
FL in (N) 120.10

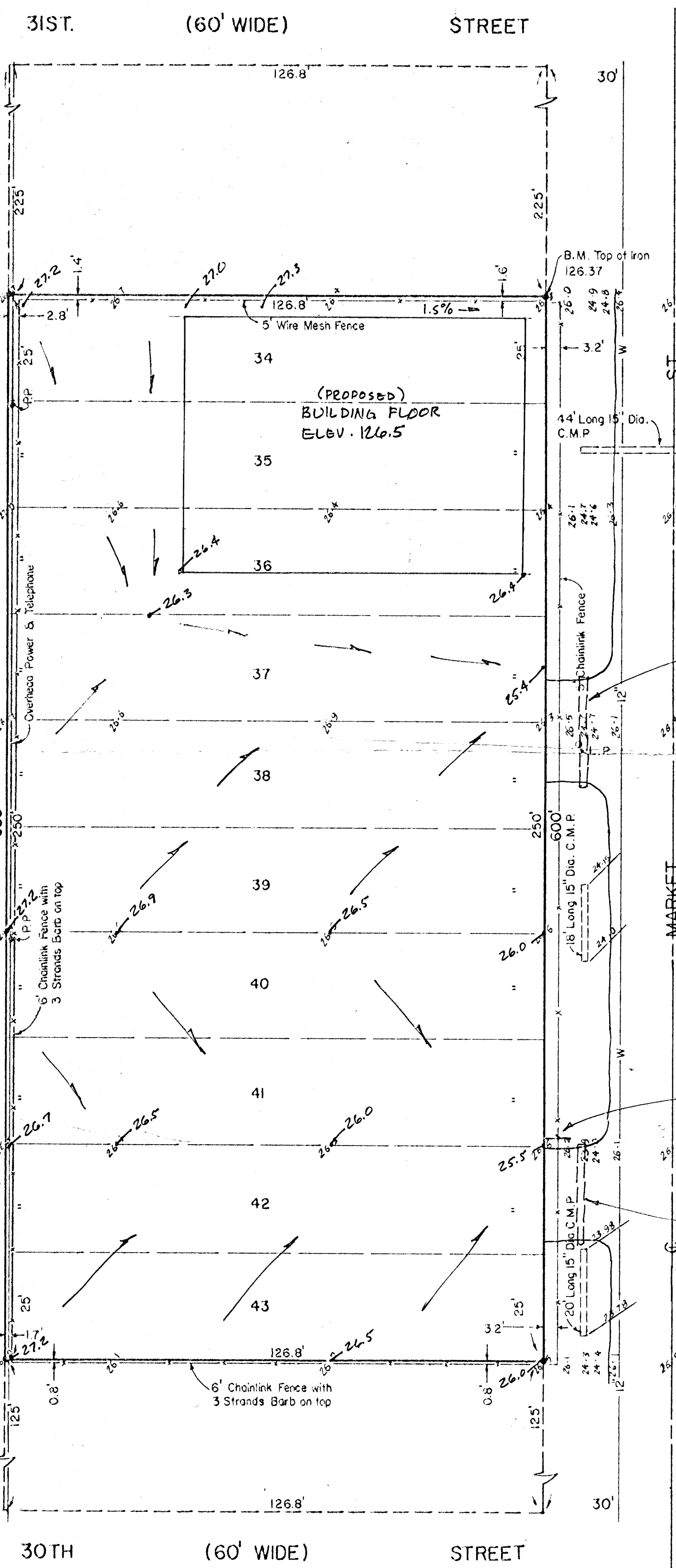

TOPOGRAPHY AND VICINITY MAP  
FOR  
HERRING FIRST ADDITION  
TO WICHITA, SEDGWICK COUNTY, KANSAS  
(GRADING PLAN)

LEGAL DESCRIPTION

Lots 34 through 43, Block 22, Jones Park Addition, to North Wichita.

18" CULVERT @  
EXISTING DITCH FL.

18" CULVERT @  
EXISTING DITCH FL.

NOTE: ALL DRAINAGE TO PUBLIC R/W WILL BE VIA PIPES, FLUMES, DRIVES, OR OTHER APPROVED STRUCTURES (TYPICAL)

NOTE: 8" San Sewer 4' W of E. Line Market Street.

BENCH MARK: Top of Iron at N.E. Property Corner Elev. 126.37 City Datum.

MOEHRING & ASSOCIATES  
CONSULTING ENGINEERS  
WICHITA  
#81-086-SD JUNE 1981  
NOV. 1981

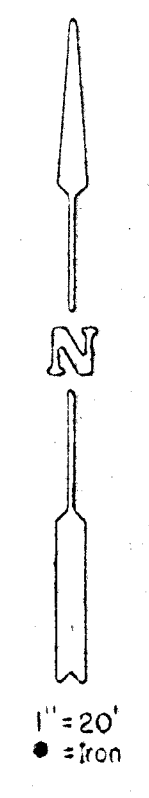

1" = 20'  
• = 5' on

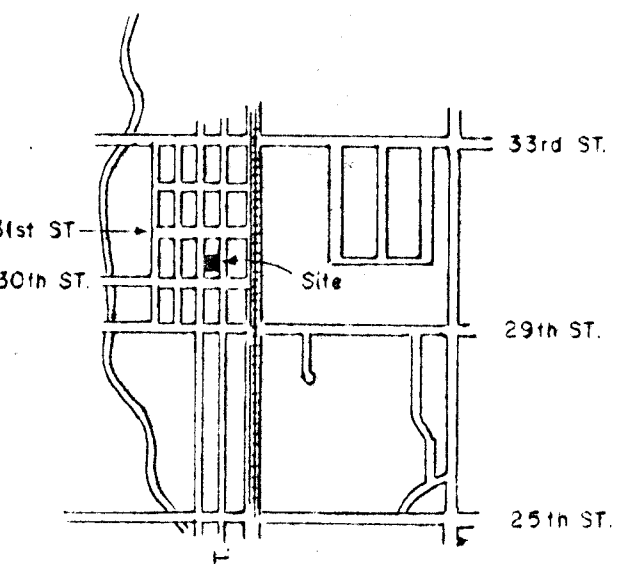

VICINITY MAP

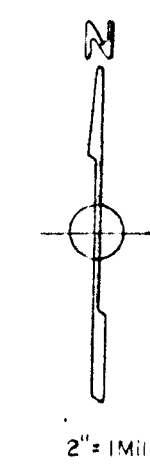

2" = 1 Mile