

REVISED PRELIMINARY PLAT (DONNA'S 1ST. ADD.)
DONNA'S 3RD. ADDITION
 THE WEST 370 FEET OF LOT 17, R. A. MORRIS TRACTS.
 FORD M. DUKE

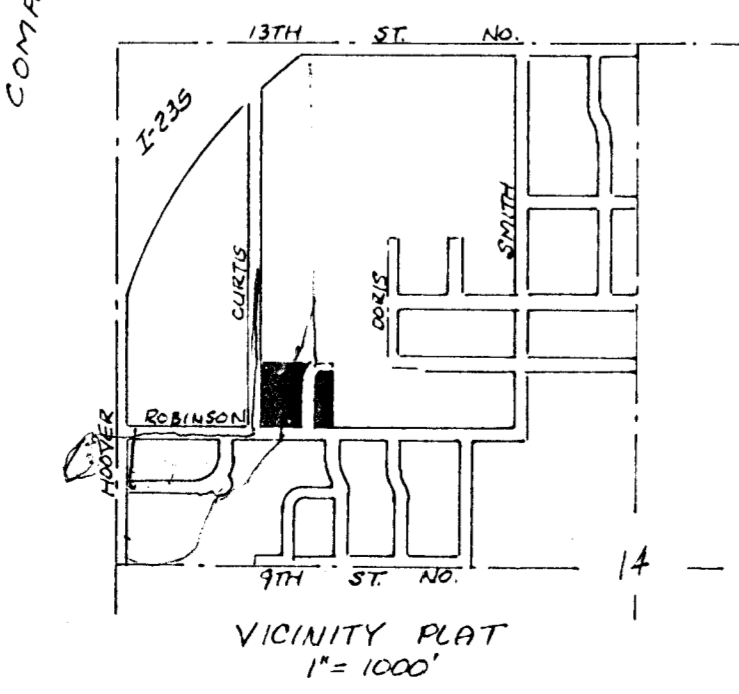

BENCH MARK:
 City Standard Disc. 3 1/2" E. & 4 1/2" S.
 c/c & Hoover & 9th St.
 Elev. = 126.213 City Datum