

February 2, 1994

Mr. Kelly P. Finn  
Environmental Engineer  
Industrial Programs Section  
Buearu of Water  
Kansas Department of Health & Environment  
Forbes Field, Bldg. 740  
Topeka, KS 66620-0001

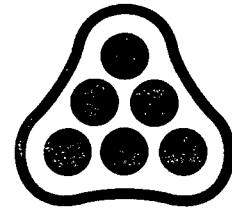

**P**ROFESSIONAL  
**E**NGINEERING  
**C**ONSULTANTS  
PROFESSIONAL ASSOCIATION

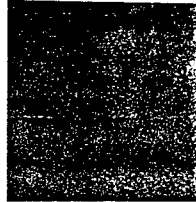

Reference: Stormwater Application for Construction Activity  
Pembrook Addition and Pembrook 2nd Addition  
PEC File Nos. 32/34-93633/1/2-042

Dear Mr. Finn:

On behalf of Socora Village Company, we hereby submit an Application for NPDES Permit for the referenced additions.

The documentation enclosed is as follows:

- Form 1.
- Supplemental Information.
- Drainage Plan.
- Grading Plan.
- Plats.

If there are nay questions, please advise.

Very truly yours,

PROFESSIONAL ENGINEERING CONSULTANTS, P.A.

Michael W. Berry, P.E.  
Manager  
Land Development Division

MWB:st

Encl.

cc: Socora Village Co. w/o encl.  
Chris Breitenstein, City Engineer's Office

Please print or type in the unshaded areas only  
(fill-in areas are spaced for elite type, i.e., 12 characters/inch).

Form Approved. OMB No. 2040-0086 Approval expires 7-31-88

<b>FORM 1</b>	<b>EPA</b>	<b>U.S. ENVIRONMENTAL PROTECTION AGENCY</b> <b>GENERAL INFORMATION</b> <i>Consolidated Permits Program</i> <i>(Read the "General Instructions" before starting.)</i>	<b>EPA I.D. NUMBER</b> F NOT REQUIRED
---------------	------------	---	--

<b>LABEL ITEMS</b> I. EPA I.D. NUMBER III. FACILITY NAME FACILITY MAILING ADDRESS VI. FACILITY LOCATION	<b>PLEASE PLACE LABEL IN THIS SPACE</b>
---	---

**GENERAL INSTRUCTIONS**

If a preprinted label has been provided, affix it in the designated space. Review the information carefully; if any of it is incorrect, cross through it and enter the correct data in the appropriate fill-in area below. Also, if any of the preprinted data is absent (the area to the left of the label space lists the information that should appear), please provide it in the proper fill-in area(s) below. If the label is complete and correct, you need not complete items I, III, V, and VI (except VI-B which must be completed regardless). Complete all items if no label has been provided. Refer to the instructions for detailed item descriptions and for the legal authorizations under which this data is collected.

**II. POLLUTANT CHARACTERISTICS**

**INSTRUCTIONS:** Complete A through J to determine whether you need to submit any permit application forms to the EPA. If you answer "yes" to any questions, you must submit this form and the supplemental form listed in the parenthesis following the question. Mark "X" in the box in the third column if the supplemental form is attached. If you answer "no" to each question, you need not submit any of these forms. You may answer "no" if your activity is excluded from permit requirements; see Section C of the instructions. See also, Section D of the instructions for definitions of bold-faced terms.

SPECIFIC QUESTIONS	MARK 'X'			SPECIFIC QUESTIONS	MARK 'X'		
	YES	NO	FORM ATTACHED		YES	NO	FORM ATTACHED
A. Is this facility a publicly owned treatment works which results in a discharge to waters of the U.S.? (FORM 2A)		X		B. Does or will this facility (either existing or proposed) include a concentrated animal feeding operation or aquatic animal production facility which results in a discharge to waters of the U.S.? (FORM 2B)		X	
C. Is this a facility which currently results in discharges to waters of the U.S. other than those described in A or B above? (FORM 2C)		X		D. Is this a proposed facility (other than those described in A or B above) which will result in a discharge to waters of the U.S.? (FORM 2D)		X	
E. Does or will this facility treat, store, or dispose of hazardous wastes? (FORM 3)		X		F. Do you or will you inject at this facility industrial or municipal effluent below the lowermost stratum containing, within one quarter mile of the well bore, underground sources of drinking water? (FORM 4)		X	
G. Do you or will you inject at this facility any produced water or other fluids which are brought to the surface in connection with conventional oil or natural gas production, inject fluids used for enhanced recovery of oil or natural gas, or inject fluids for storage of liquid hydrocarbons? (FORM 4)		X		H. Do you or will you inject at this facility fluids for special processes such as mining of sulfur by the Frasch process, solution mining of minerals, in situ combustion of fossil fuel, or recovery of geothermal energy? (FORM 4)		X	
I. Is this facility a proposed stationary source which is one of the 28 industrial categories listed in the instructions and which will potentially emit 100 tons per year of any air pollutant regulated under the Clean Air Act and may affect or be located in an attainment area? (FORM 5)		X		J. Is this facility a proposed stationary source which is NOT one of the 28 industrial categories listed in the instructions and which will potentially emit 250 tons per year of any air pollutant regulated under the Clean Air Act and may affect or be located in an attainment area? (FORM 5)		X	

**III. NAME OF FACILITY**

1 SKIP PEMBROOK AND PEMBROOK SECOND ADDITIONS

**IV. FACILITY CONTACT**

A. NAME & TITLE (last, first, & title)	B. PHONE (area code & no.)
2 CHAMBERS, LARRY A., PRESIDENT	316 263 3201

**V. FACILITY MAILING ADDRESS**

A. STREET OR P.O. BOX	
3 104 SOUTH BROADWAY, SUITE 200	
B. CITY OR TOWN	C. STATE D. ZIP CODE
4 WICHITA	KS 67202

**VI. FACILITY LOCATION**

A. STREET, ROUTE NO. OR OTHER SPECIFIC IDENTIFIER	
5 NW 1/4, SECTION 1, T27S, R1E	
B. COUNTY NAME	
SEDGWICK	
C. CITY OR TOWN	D. STATE E. ZIP CODE F. COUNTY CODE (if known)
6 WICHITA	KS 67220

**PEMBROOK AND PEMBROOK 2ND ADDITIONS**  
**PEC File No. 36-93339-3104**

1. For location, see maps enclosed.
2. The total development area is 43 acres, and the total disturbed area is 35 acres.
3. No local or state erosion and sediment control regulations are in effect. Construction is to be performed in accordance with standard local practice. For example, street and drainage construction is to be performed in accordance with Section 903, Seeding, and Section 904, Erosion and Pollution Control, in "Standard Specification for State Road and Bridge Construction, Kansas Department of Transportation, Edition 1990." Provisions have been made for temporary seeding, for inlet sediment protection, and for hay bales if field conditions warrant.
4. No local or state erosion and sediment control regulations are in effect. Upon completion of construction, the disturbed area adjacent to the stream will be seeded, fertilized, and mulched, and stone riprap and concrete headwalls will be constructed at the storm sewer outlets. In addition, all private lawns will be seeded or sodded upon completion of residential construction.
5. The runoff coefficient for single-family residential areas of this type is estimated to be 0.48 to 0.64. The total anticipated impervious area is estimated to be 10 acres, or 23% of the site. All embankment materials will be soil excavated on site. The soils are clays and clay loams.
6. The receiving water is on an unnamed tributary to the East Fork Chisholm Creek.

7.5MINUTE SERIES (TOPOGRAPHIC)

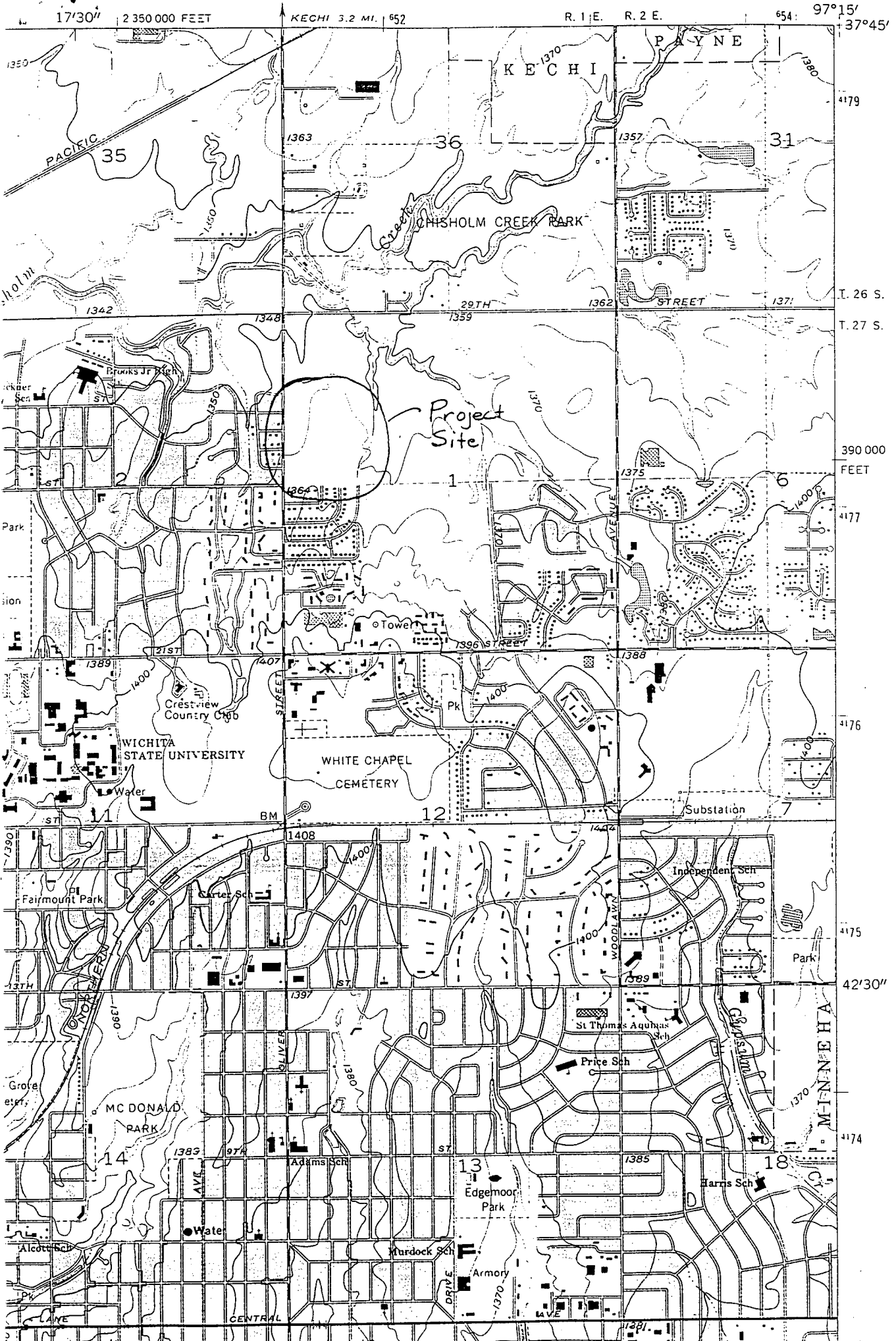

T. 26 S.

T. 27 S.

390 000  
FEET

4176

4175

42'30"

4174

4179

4177