

GENERAL LOCATION SKETCH
1" = 2000'

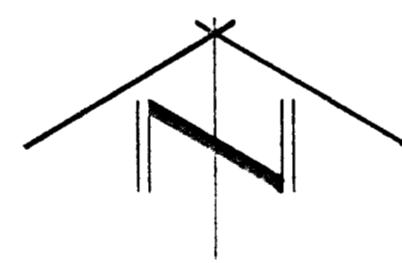
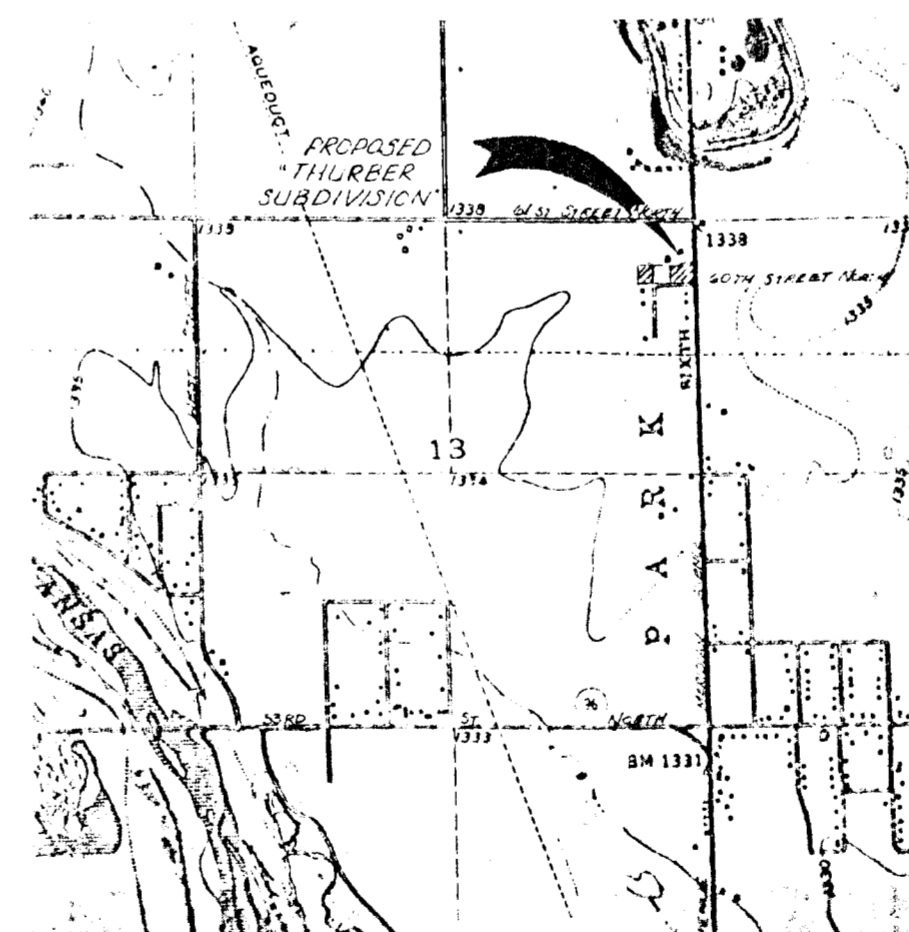

SCALE: 1"=60'

BENCH MARK:
Intersection 60th St North
and Meridian Avenue
1337.85 assumed

Topography by Transit Stadia
13 May, 1982
8 July, 1982

VICINITY MAP
"THURBER SUBDIVISION"
SEDGWICK COUNTY, KANSAS
9 July, 1982
FILE # 82040