

PRELIMINARY PLAT OF JAMESBURG PARK WICHITA, SEDGWICK CO, KANSAS

LEGAL DESCRIPTION
 The NE1/4 of Sec. 8, T27S, R1W of the 6th P.M., Sedgwick County, Kansas, except Road R/W as recorded at File 198, pages 1549, 1543 & 1544; and also except a tract described as follows: Beginning at a point in the South line of the NE1/4 of Sec. 8, T27S, R1W of the 6th P.M., Sedgwick County, Kansas, and 293.00' N. of the SE Corner of said NE1/4; thence N. parallel with the East line of said NE1/4 and bearing N. 01°27'12" E., a distance of 108.00'; thence N. 39°35'18" E., parallel with the South line of said NE1/4, a distance of 309.00'; to a point 40.00' W. of the East line of said NE1/4; thence N. 01°27'12" E., a distance of 450.00'; thence N. 89°55'18" E., a distance of 550.00' to the P.C. of a curve having a radius of 330.00' and a chord bearing of S. 23°57'12" W.; thence Southwesterly along said curve and through a central angle of 45°00'00" to the P.T. of said curve; thence S. 46°27'12" W., a distance of 467.26'; to the P.C. of a curve to the Right having a radius of 250.00'; thence along said curve to the Right and through a central angle of 31°51'43", a distance of 312.73'; thence S. 41°01'05" E., a distance of 203.35' to a point on the South line of said NE1/4; thence N. 89°55'18" E., a distance of 467.73' to the point of beginning; and also except a tract described as beginning at a point 19.00' West of the SE Corner of the NE1/4 of said Sec. 8; thence West 330.00'; thence North 198.00'; thence East 330.00'; thence South 198.00' to the point of beginning.

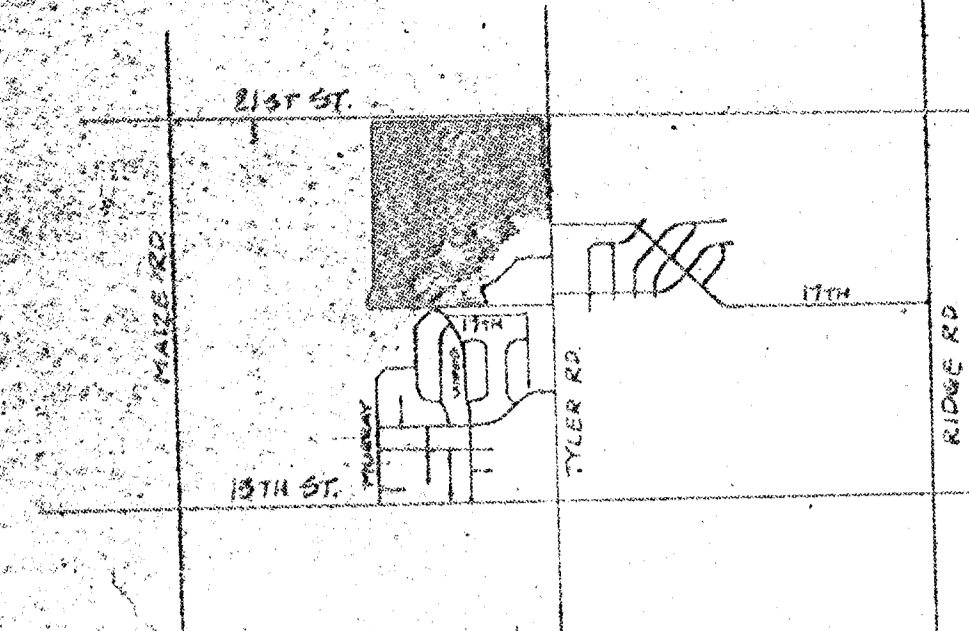

VICINITY MAP

Drainage Plan
5/180

