

N 1/4 Cor. Sec. 35  
T 218, R 2E of the 6th PM

N.E. Cor. N.E. 1/4, Sec. 35  
T 218, R 2E of the  
6th PM

HARRY STREET

LOOKMOOR

TIMBER VALLEY ADDITION

OSIE

WOODDALE

WILLOW OAK COURT

COUNTRY SIDE

FUNSTON

FUNSTON

ZONING R-1

RANCHLANDS, INC.

RANCHLANDS, INC.

ZONING R-1

RANCHLANDS, INC.

WEeping WILLOW

WEeping WILLOW

ST. ANDREWS DRIVE

CREEK SIDE LANE

WILLOW OAK

SPRING FOLLO

MT. VERNON

MT. VERNON

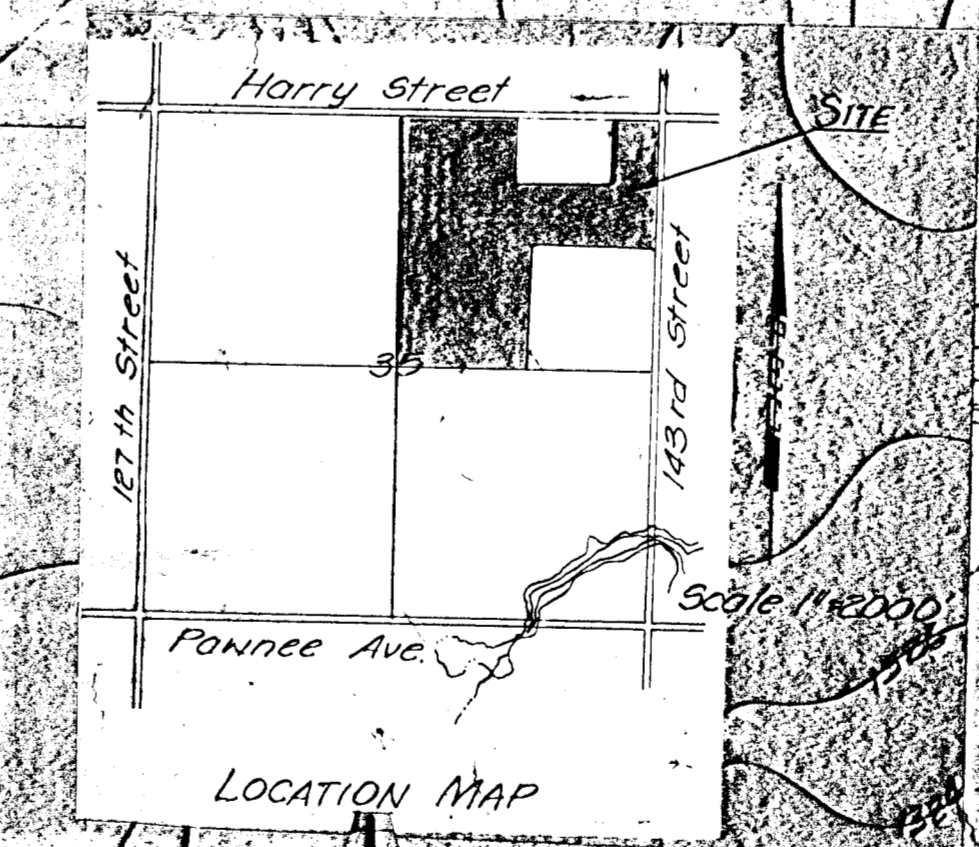

# REVISED PRELIMINARY PLAT ZONING R-1 TIMBER VALLEY 2ND ADDITION

Owner: Timber Valley, Inc.  
Developer: Perry Land Company, Inc.  
221 S. Broadway  
Engineer: Professional Engineering Consultants, P.A.  
1480 E. 11th W. Columbia, MO

UTILITIES:  
Water: None Available  
Gas: " "  
Telephone: " "  
San. Sewer: " "  
Power: 34.21 K.V. 47E. East side  
Road: Street

E.M. - RR Right of Way Power Pole  
45' W. E. S.W. 1/4 Cor. Sec. 35  
T 218, R 2E  
Elev. 1325.25 (M.S.L.)

Scale: 1" = 100'  
November 30, 1979  
Date of Topo: March 3, 1968  
Topo at 5' Intervals

Note: Side yard setbacks to be shown as 10' on final Plat.  
Note: for Plat, Street Grades  
See Drainage Concept

Center, Sec. 35  
T 218, R 2E

RANCHLANDS, INC.

1:24.8

1:24.8