

← NORTH

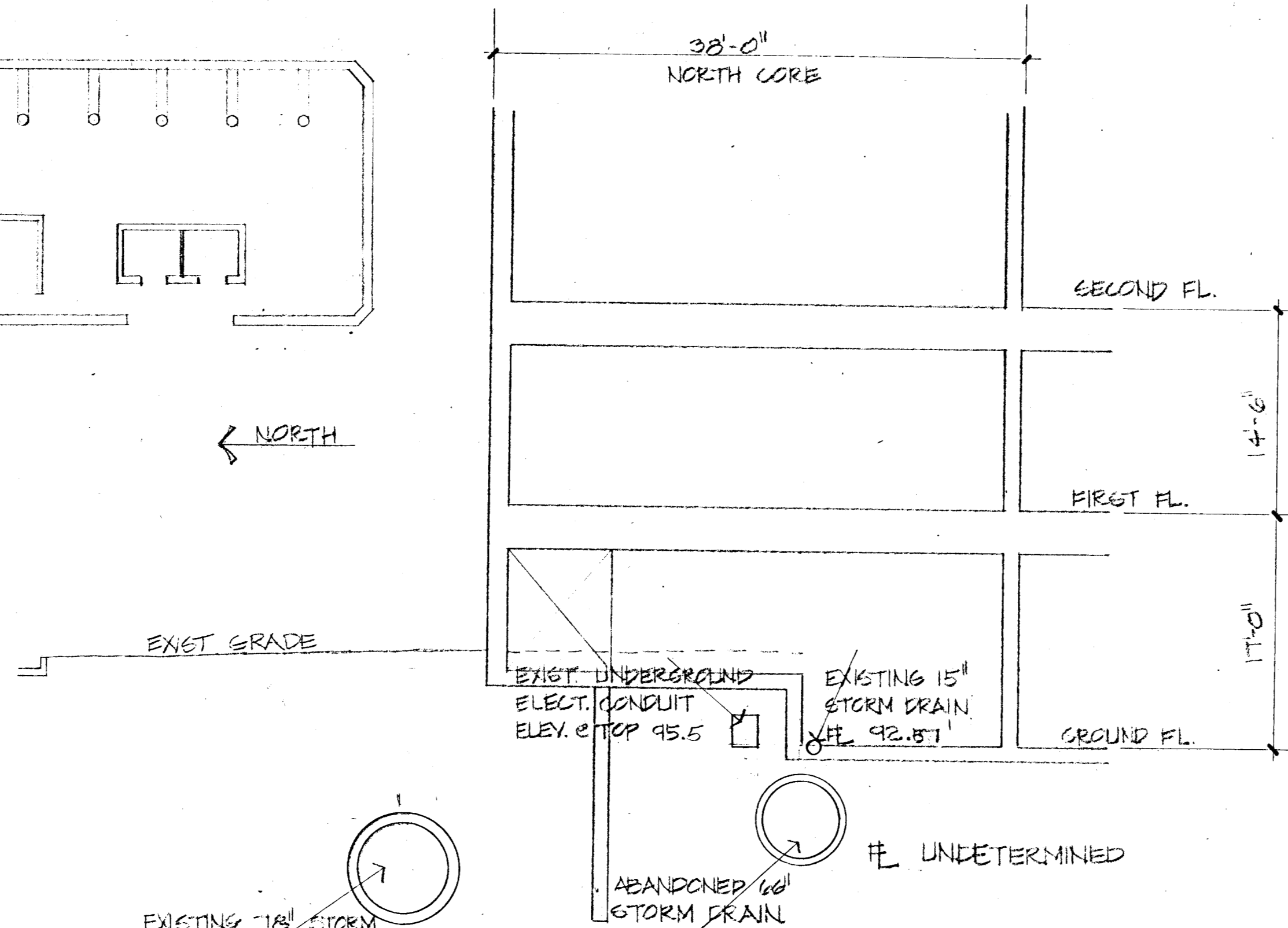

FIRST FLOOR - TENTATIVE
ELEV. 1310.50

FARM CREDIT BANK
WICHITA, KANSAS
12/15/82

c-59

PROPOSED SECTION THROUGH NORTH CORE AT NW CORNER
SCALE 1/8" = 1'-0"

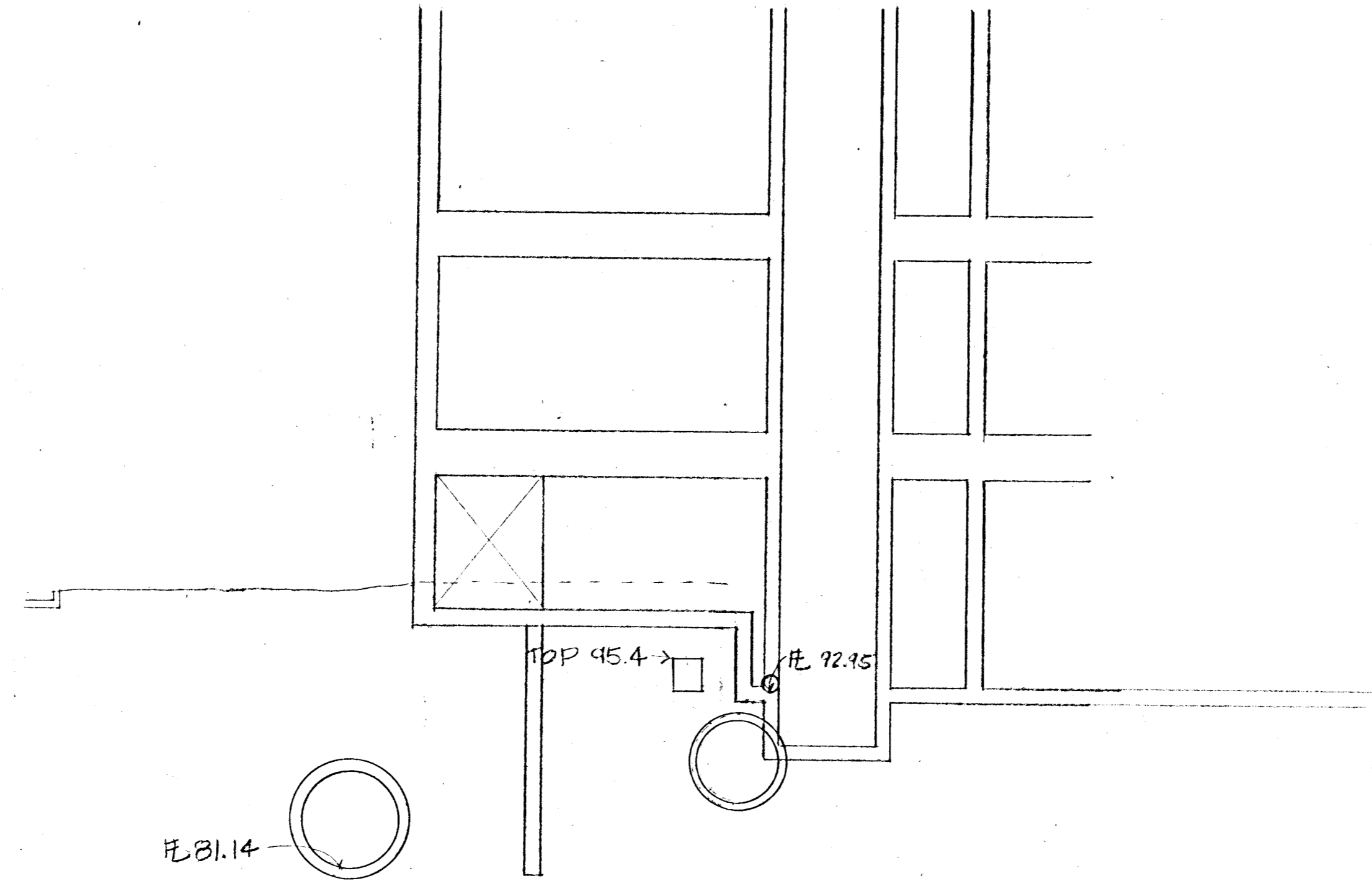

AC 1/14

PROPOSED SECTION THROUGH NORTH CORE AT ELEVATORS

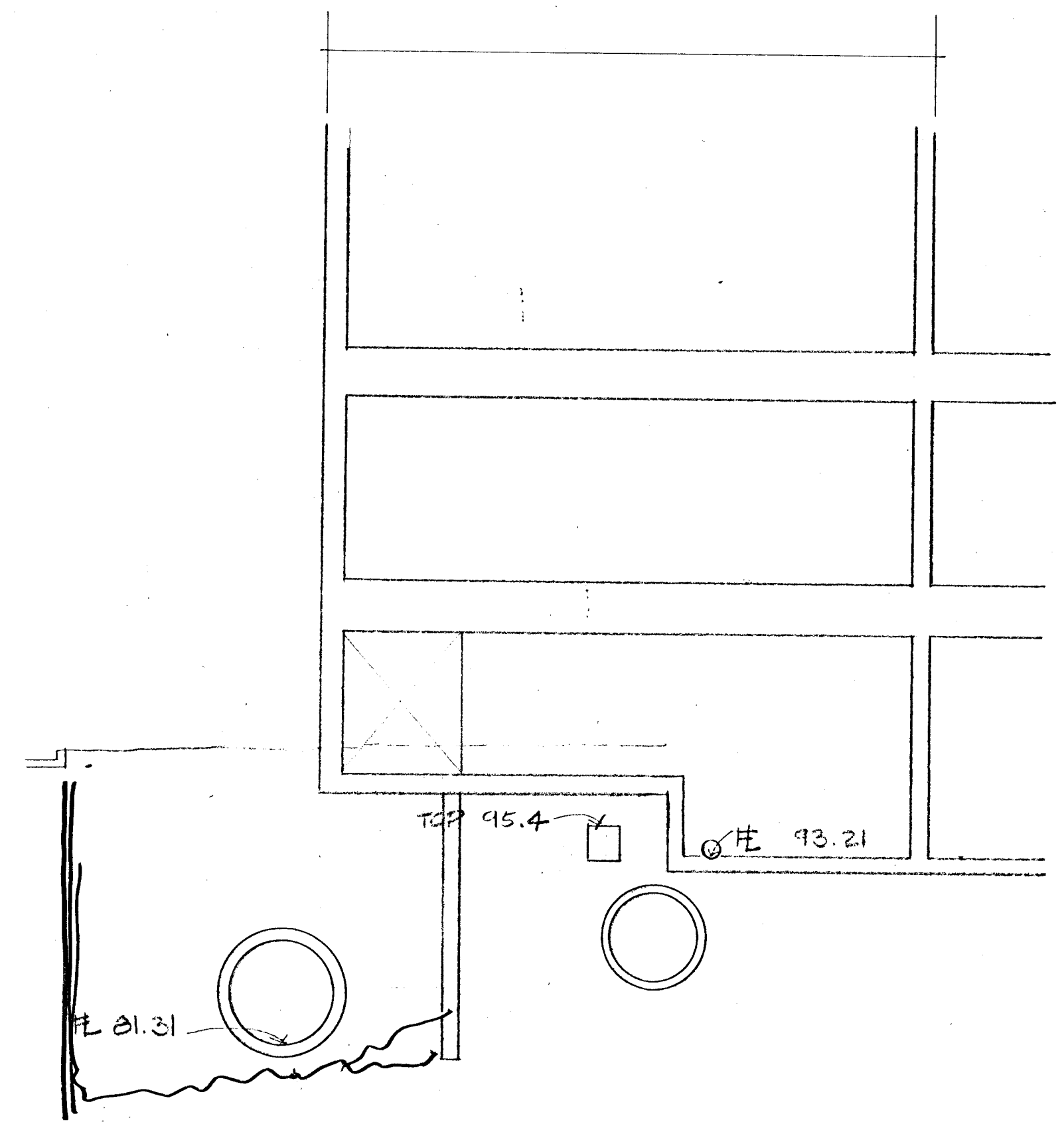

PROPOSED SECTION THROUGH NORTH CORE AT NE CORNER

12/15/82