

NOTES

BENCH MARK :
 ROCK ROAD AND 13TH STREET NORTH CITY OF WICHITA BENCH MARK DISC. 42 FT. NORTH AND 38 FT. EAST OF CENTER LINE OF BOTH; ELEVATION: 186.849

A DRAINAGE CONCEPT FOR THIS PROJECT HAS BEEN DESIGNED AND PREPARED BY PROFESSIONAL ENGINEERING CONSULTANTS, (PEO)

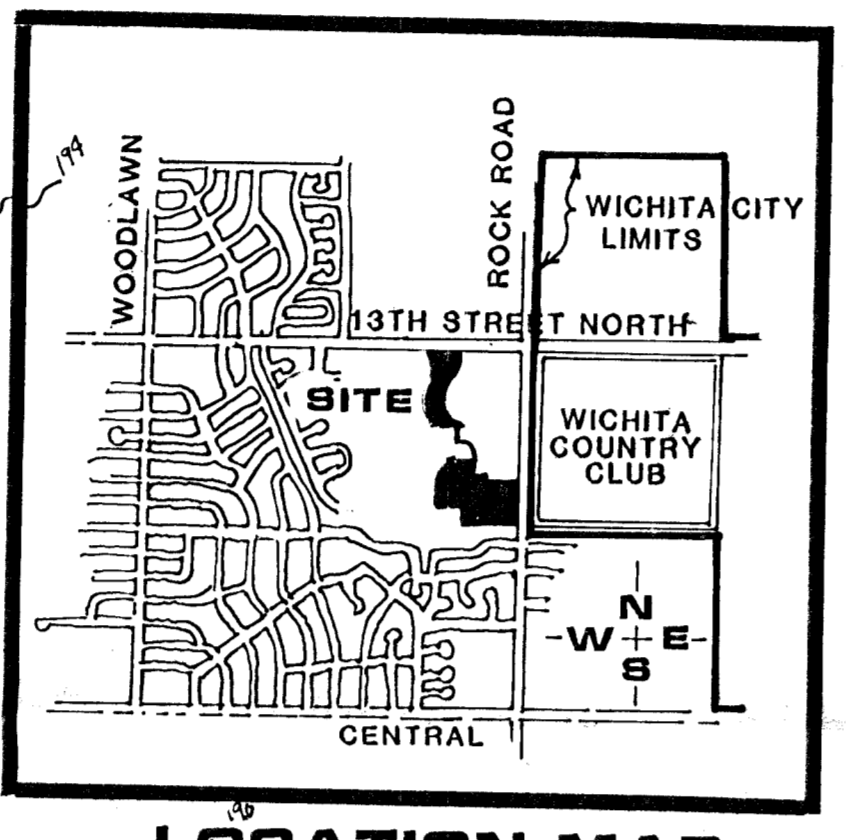

SCALE: 1" = 100'
 CONTOUR INTERVAL = 2'

PRELIMINARY PLAT (A RE-PLAT OF A PORTION OF FAIRFIELD ESTATES)

FAIRFIELD ESTATES 2ND

OWNER: RALPH RUDY 716 N. GOW WICHITA, KS. 67203

