

**SUBDIVISION COMMITTEE
METROPOLITAN AREA PLANNING COMMISSION**

AGENDA ITEM NO. 14.

July 9, 1998

**STAFF REPORT
(One-Step Final Plat)**

CASE NUMBER: S/D 98-68 - GREENWICH HEIGHTS 3RD ADDITION

OWNER/APPLICANT: Jim Hageman, 2407 Herrington, Wichita, KS 67210

SURVEYOR/ENGINEER: Baughman Company, P.A., 315 Ellis, Wichita, KS 67211

LOCATION: South of Pawnee, East of Greenwich

SITE SIZE: 1.79 acres

NUMBER OF LOTS

Residential: 2
Office:
Commercial:
Industrial:
Total: = 2

MINIMUM LOT AREA: 34,500 sq.ft.

CURRENT ZONING: SF-20, Single-Family Residential

PROPOSED ZONING: Same

VICINITY MAP

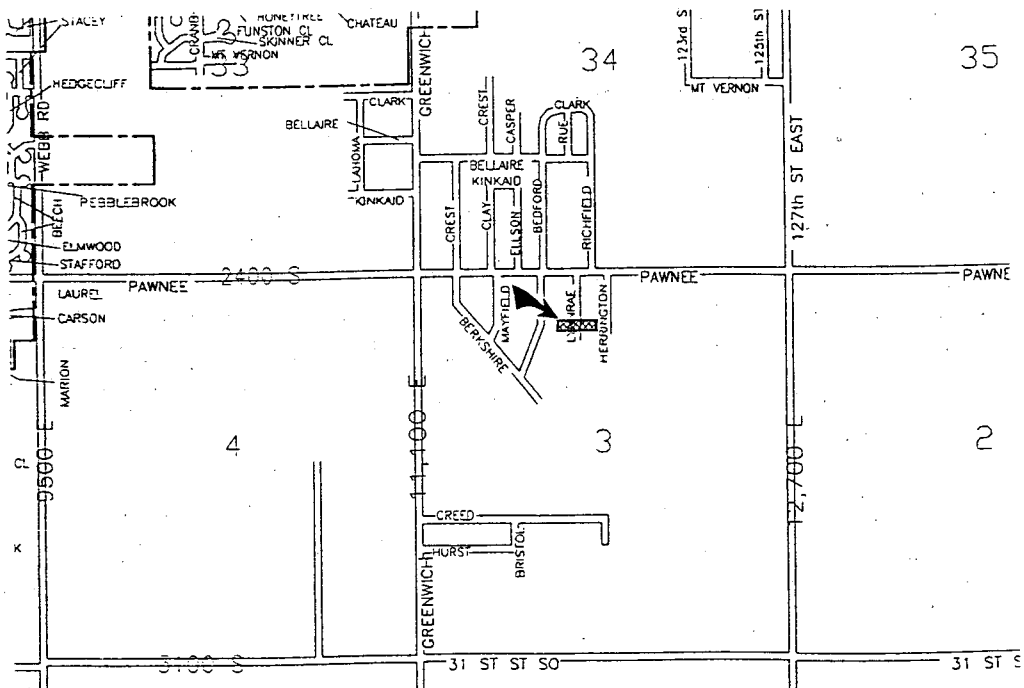

Note: This site is located in the County within three miles of the City of Wichita in an area designated as "New Growth" by the Wichita-Sedgwick County Comprehensive Plan and classified as a suburban subdivision. The platted street and turnaround will extend from the existing street to the north.

STAFF COMMENTS:

- A. This site is located in the County's Four Mile Creek sewer system and will be served by the County.
- B. The applicant shall guarantee the extension of City water to serve the lots being platted. These improvements will be with the City of Wichita and consequently an outside-the-city water agreement shall be provided.
- C. If improvements are guaranteed by petition, a notarized certificate listing the petitions shall be submitted to the Planning department for recording.
- D. County Engineering needs to comment on the status of the applicant's drainage plan.
- E. The temporary turnaround will need to be established by separate instrument.
- F. County Fire needs to comment on the length of Lynnrae Lane. With this 150-foot segment, the total street length measured from Pawnee (780 feet) exceeds the 600-foot limitation imposed by the Subdivision regulations.
- G. The applicant shall guarantee the installation of the proposed new street extension.
- H. The final plat shall reference a tie point to a section corner.
- I. The applicant shall install or guarantee the installation of all utilities and facilities which are applicable and described in Article 8 of the MAPC Subdivision Regulations. (Water service and fire hydrants required by Article 8 for fire protection shall be as per the direction and approval of the Chief of the Fire Department.)
- J. The applicant's engineer is advised that the Register of Deeds is requiring the name(s) of the notary public, who acknowledges the signatures on this plat, to be printed beneath the notary's signature.

- K. To receive mail delivery without delay, and to avoid unnecessary expense, the applicant is advised of the necessity to meet with the U.S. Postal Service Growth Management Coordinator (phone 316-729-0102) prior to development of the plat so that the type of delivery, and the tentative mailbox locations can be determined.
- L. The applicant is advised that various State and Federal requirements [specifically but not limited to the Army Corps of Engineers, Kanopolis Project Office, Rt. 1, Box 317, Valley Center, KS 67147] for the control of soil and wind erosion and the protection of wetlands may impact how this site can be developed. It is the applicant's responsibility to contact all appropriate agencies to determine any such requirements.
- M. The owner of the subdivision should be aware of the fact that the development of any subdivision greater than five (5) acres in size may require an NPDES Storm Water Discharge Permit from the Kansas Department of Health and Environment in Topeka. Further, on all construction sites, the City of Wichita requires that best management practices be used to reduce pollutant loadings in storm water runoffs.
- N. Perimeter closure computations shall be submitted with the final plat tracing.
- O. Recording of the plat within thirty (30) days after approval by the City Council and/or County Commission.
- P. The representatives from the utility companies should be prepared to comment on the need for any additional utility easements to be platted on this property.
- Q. The applicant is reminded that a disk shall be submitted with the final plat tracing to the Planning Department detailing this plat. This will be used by the City and County GIS Department.