

1" = 100'
Elev. = City Datum
3/23/81

BENCH MARK:
City Standard Disc. 4" W. & 30" S.
of 55th St. So. & Hyd.
Elev. = 16.57 City Datum

NOTE:
Refer to approved "GRIFFIN PARK"
Community Unit Plan DP-120
for building Set-backs

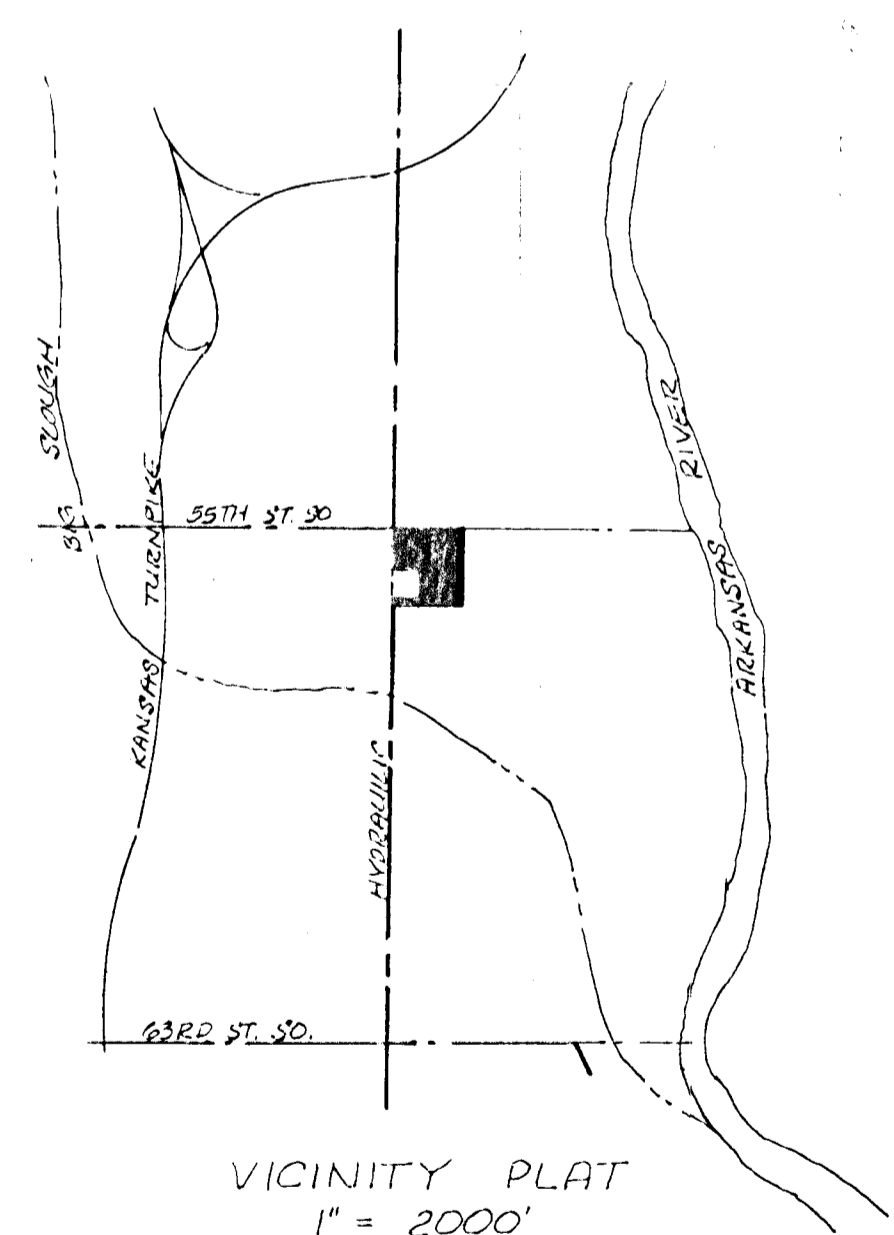

PRELIMINARY PLAT
GRIFFIN PARK

THE NORTH 731 FEET OF
THE WEST 21 ACRES OF THE NW/4 OF
THE NW/4 OF SEC. 27, TWP 28-S, R-1E
OF THE 6TH P.M., SEDGWICK COUNTY,
KANSAS, EXCEPT THE SOUTH 270 FEET