

SECTION A-A  
SECTION ALONG AXIS OF DAM  
SHOWING CROSS SECTION OF DAM SITE AND  
SPILLWAY AND LONGITUDINAL SECTION  
OF DAM

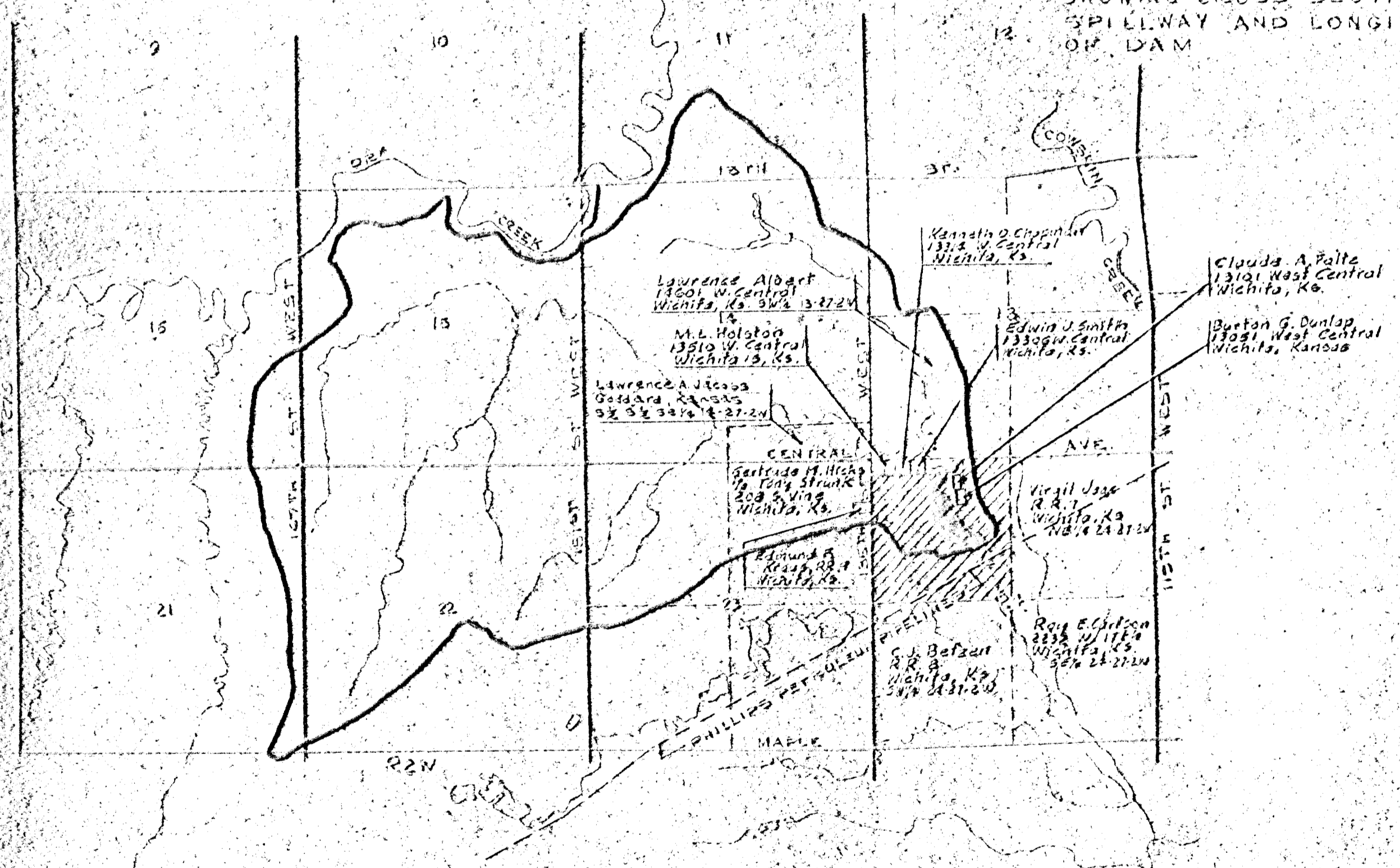

DRAINAGE AREA  
2200 ACRES = 3.13 SQ. MILES  
1" = 2000'

- CL - STIFF DARK GRAY-BROWN, SANDY CLAY.
- ML - MEDIUM DENSE, DARK BROWN, SANDY SILT.
- SC-CL - MEDIUM, BROWN, CLAYEY SAND.
- SC - LOOSE, YELLOW-BROWN, CLAYEY SAND.
- SM - LOOSE, YELLOW-BROWN, SILTY SAND.
- SP - LOOSE, YELLOW-BROWN, FINE-MEDIUM SAND WITH CLAY BEAMS.
- SW - LOOSE, YELLOW-BROWN, FINE-COURSE, SAND.

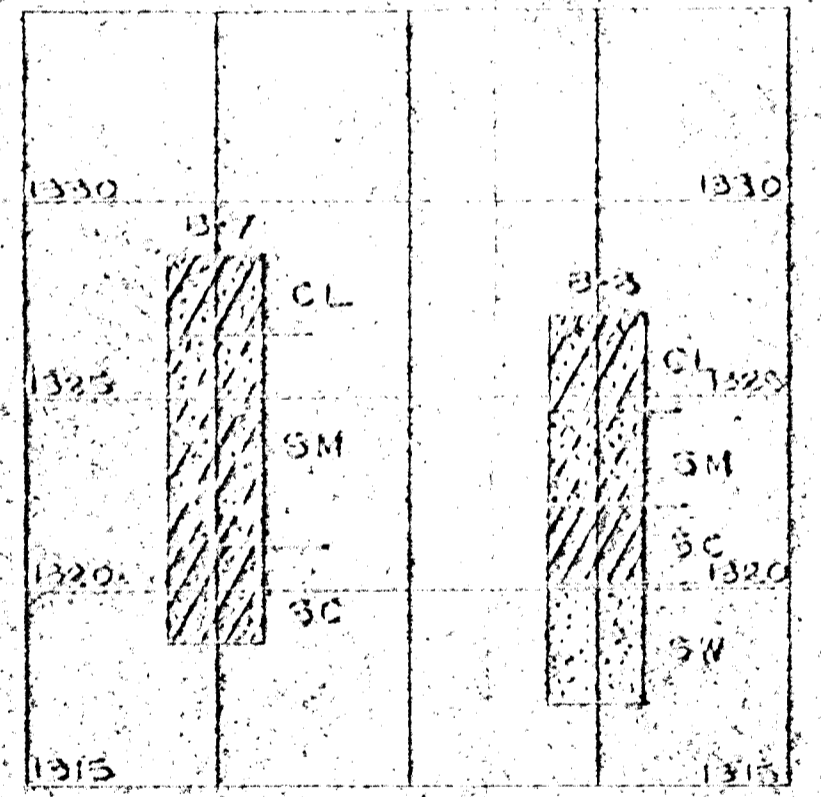

BORING LOG  
B-7 & B-3

AREA CAPACITY		
ELEVATION	AREA ACRES	CAPACITY ACRES FEET
1325	1.55	0
1328	3.21	3.34
1330	3.45	27.20
1331	10.85	37.03
1332	11.56	43.03
1334	15.73	73.13
1335	18.13	92.41
1336	20.85	111.00
1338	27.33	160.71
1340	33.83	227.06

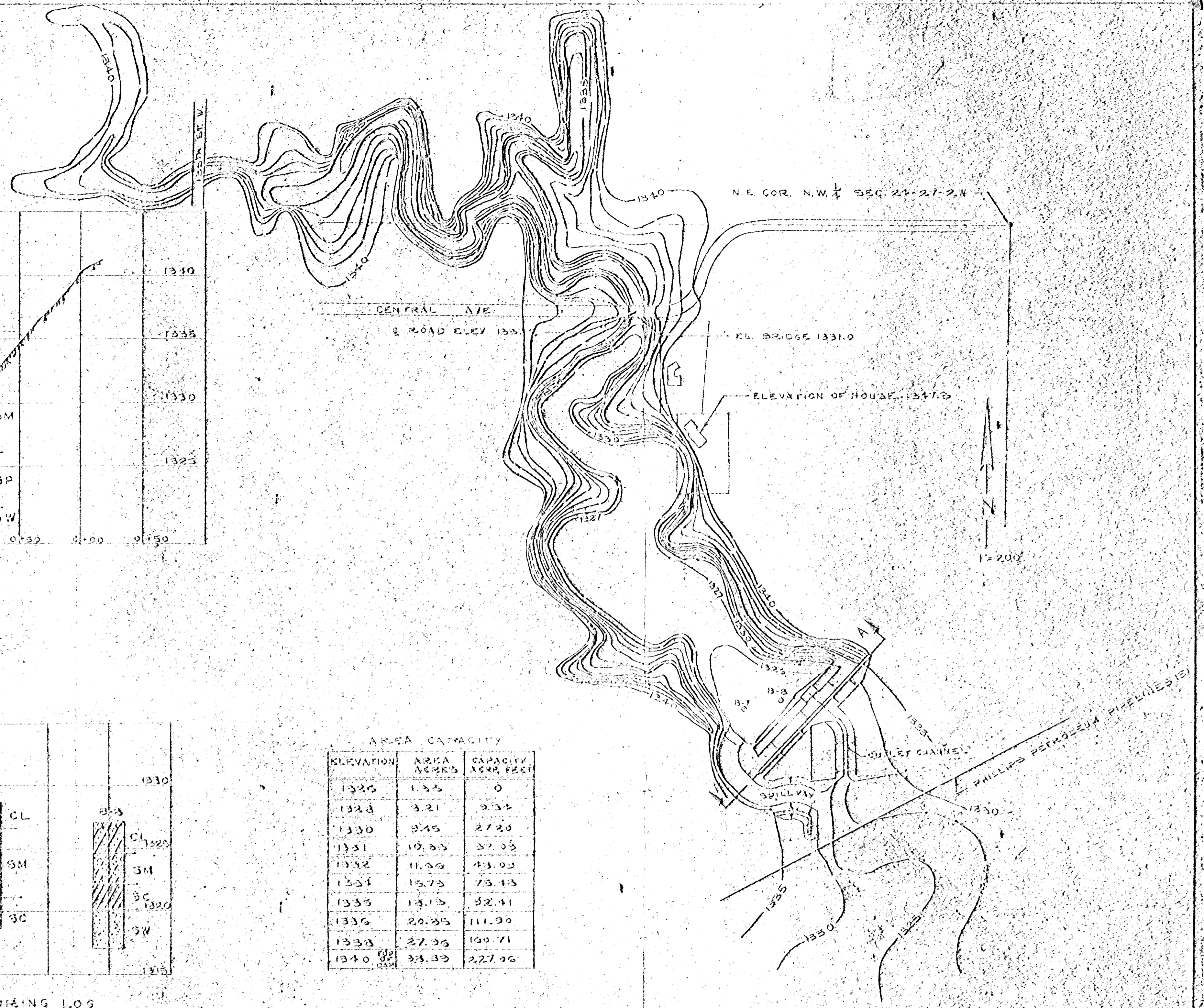

K. O. TAYLOR, P.E.  
1542 S. ST. FRANCIS  
WICHITA, KANSAS  
AUG., 1971  
REVISED NOV. 17, 1971  
REVISED JAN. 23, 1972  
REVISED JULY 7, 1976



Rainbow Lakes 4<sup>th</sup> Add.  
Plot - F-11  
EARTH-FILL DAM IN THE  
N.W. 1/4 SEC. 21-27-24  
FOR  
L.V. BELL

DATE	BY	REVISION