

WICHITA—SEDGWICK COUNTY

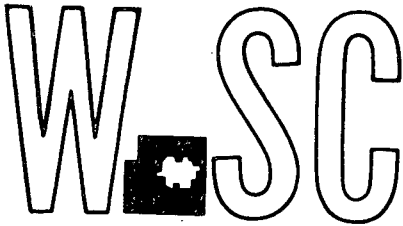

METROPOLITAN AREA PLANNING  
DEPARTMENT

CITY HALL — TENTH FLOOR  
455 NORTH MAIN STREET  
WICHITA, KANSAS 67202  
(316) 268-4561

January 30, 1978

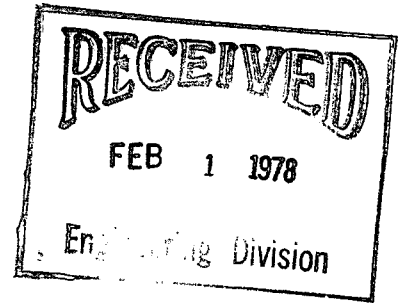

K. O. Taylor  
1542 S. St. Francis  
Wichita, Kansas 67211

Re: S/D 77-108 Preliminary plat of Rainbow Lakes West Third  
Addition

Dear Mr. Taylor:

At the regular meeting of the Subdivision Committee of the Metropolitan Area Planning Commission, January 26, 1978, the above captioned plat was considered. The action of the Committee was to recommend that this plat be deferred for two weeks for further study of the drainage problems involved and redesign of the plat to eliminate the narrow fingers of open space and the isolated lots.

At such time as the revised preliminary plat is submitted, it will be rescheduled for consideration by the Subdivision Committee.

Sincerely,

A handwritten signature in cursive script that reads 'Curtis L. Newby'.

Curtis L. Newby  
Junior Planner

CLN:et

cc:

Dean Sellers, Assistant City Engineer  
M. S. Mitchell, Flood Control

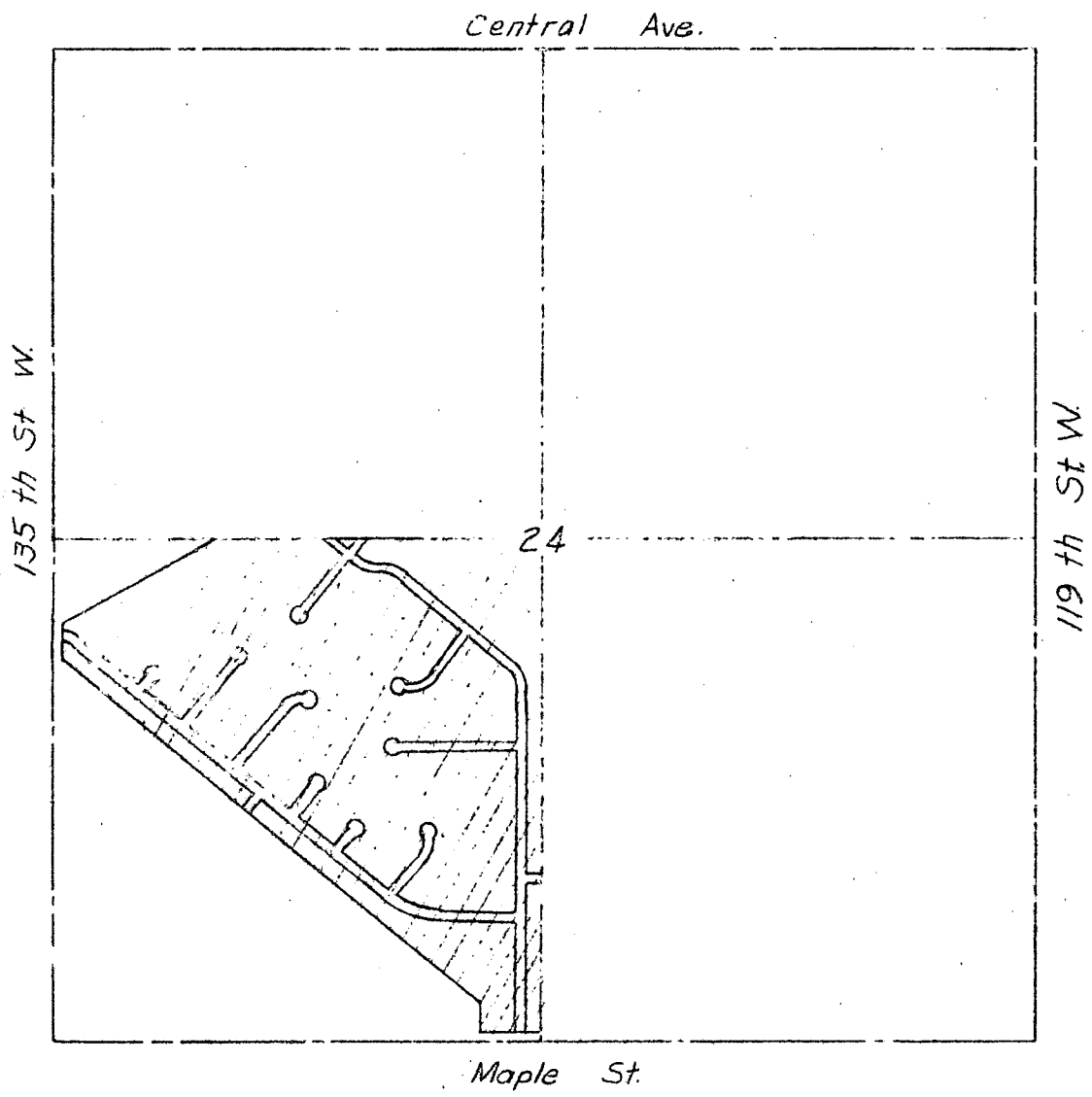

Scale: 1" = 1000'

Vicinity Map  
Rainbow Lakes West Third Addition

THE CITY OF WICHITA



DEPARTMENT OF PUBLIC WORKS  
ENGINEERING DIVISION  
CITY HALL — SEVENTH FLOOR  
455 NORTH MAIN STREET  
WICHITA, KANSAS 67202  
(316) 268-4501

January 30, 1991

Owner  
Lot 24, Block 4, Rainbow  
Lakes West 3rd Addition

Dear Sir:

At this point in time the City of Wichita is not willing to allow any excavation within the platted 'Reserve A' of Rainbow Lakes West 3rd Addition.

Sincerely,

Chris J. Breitenstein, P.E.  
Civil Engineer II

CB:gnz

THIS AGREEMENT made and entered into this 11 day of October, 1993, by and between the City of Wichita, Kansas, party of the first part (hereinafter "City"), and Paul L. Williams, party of the second part (hereinafter "Owner").

WITNESSETH:

WHEREAS, City, at some undetermined time in the future, intends to construct certain public improvements to serve property owned by Owner and property owned by others; and

WHEREAS, Owner is the owner of real property legally described as Lot 3 Block 2 Rainbow Lakes 3rd addition Sedgwick County KS; and

WHEREAS, Owner wishes to Construct House on property

WHEREAS, City wishes to insure that the said real property owned by Owner will be included in the improvement district responsible for that portion of the costs of said future improvement that are to be assessed pursuant to the provisions of K.S.A. 12-6a01 et seq..

NOW, THEREFORE, the parties hereto agree as follows:

1. City shall grant Owner's \_\_\_\_\_ to said real property, notwithstanding the fact that not all the public improvements normally required to be constructed prior to \_\_\_\_\_ have been constructed.

2. Owner, on his own behalf and on behalf of his heirs, assigns and successors in interest, irrevocably waives his right, pursuant to K.S.A. 12-6a06, to protest the commencement of the construction of Street and related improvements

by City, but nothing contained herein shall be deemed to be a waiver by Owner of his right to challenge, pursuant to K.S.A. 12-6a11, the reasonableness of the portion of the cost of said construction assessed against Owner's said real property.

3. A copy of this agreement shall be recorded with the Register of Deeds and the promises herein made by Owner shall constitute covenants running with the land described herein.

IN WITNESS WHEREOF, said parties have set their hand this 11<sup>th</sup>  
day of October, 1993.

Owner(s) please sign, then type or  
print name below signature:

CITY OF WICHITA

Paul L. Williams

By \_\_\_\_\_

Paul L. Williams

STATE OF KANSAS)  
SEDGWICK COUNTY) SS

BE IT REMEMBERED that on this 11<sup>th</sup> day of October, 1993  
came Paul L. Williams  
to me personally known to be the same person \_\_\_ who executed the  
foregoing instrument of writing, and said person \_\_\_ duly acknowledged  
the execution thereof.

1993 Dated at Wichita, Kansas, this 11<sup>th</sup> day of October,

Lynda J. Brittingham  
Notary Public

My Commission expires June 1, 1994

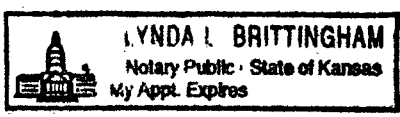

STATE OF KANSAS)  
SEDGWICK COUNTY) SS

BE IT REMEMBERED that on this \_\_\_\_\_ day of \_\_\_\_\_,  
came \_\_\_\_\_  
to me personally known to be the same person \_\_\_ who executed the  
foregoing instrument of writing, and said person \_\_\_ duly acknowledged  
the execution thereof.

Dated at Wichita, Kansas, this \_\_\_\_\_ day of \_\_\_\_\_,  
19\_\_.

\_\_\_\_\_  
Notary Public

My Commission expires \_\_\_\_\_



THE CITY OF WICHITA

OFFICE OF: CENTRAL INSPECTION

DATE: February 7, 1989

TO: Vicki Huang, Subdivision Engineer

FROM: Mike Gable, Permit Examiner 

SUBJECT: Rainbow Lakes West  
3rd Addition

Engineering requested on August 3, 1988, that no permits be issued in Rainbow Lakes West 3rd until new street, water and sewer petitions are presented to the City.

Our understanding is that these petitions have been presented and services will be provided by June/July 1989 or sooner on the following:

Lots 27-32, Block 4  
Lots 11-15, Block 5

Therefore, building permits may be issued for these lots only. If this information is incorrect, please let me know.

MG:eh

THE CITY OF WICHITA

OFFICE OF CENTRAL INSPECTION

DATE: August 22, 1990

TO: Michael E. Lindebak, P.E., City Engineer

FROM: Monty H. Robson, Superintendent of Central Inspection *MHR*

SUBJECT: Building Permits -  
Rainbow Lakes West 3rd Add.

When the plat was reviewed for this area it was noted that water wells serving a house are prohibited by the plat. From your memo of 16, August 1990, we understand water petitions have not been received by City Council.

The question arises that if City Council & CPO rejects the petition or projects, how is the house(s) to be served with water until future line extensions? Article 10 of Subdivision Regulations would require the governing body (City Council) to waive any plat requirements. Therefore if CID is to issue the permit early (prior to Council acceptance, etc.), we need some judgment from you that no problems will arise with the approval and processing of the water petitions.

When the petitions are accepted, is CID's understanding correct that building permits may be issued on all lots in this group. If this is incorrect please let us know.

We have been in contact with the builder, owner and Realtor and they are very anxious to start construction. Please advise at your earliest convenience.

MHR:MG:bp

*John Lindsey*  
*722-7227*

THE CITY OF WICHITA

OFFICE OF PUBLIC WORKS - ENGINEERING

DATE August 3, 1988

TO Monty Robson, Superintendent of Central Inspection

FROM Mike Lindebak, City Engineer

 SUBJECT Building Permits - Rainbow  
Lakes West Third Addition

Rainbow Lakes West Third Addition is located in the quarter section north of Maple and east of 135th Street West. The plat was approved in 1979 when this area was outside the city limits. At that time paving petitions for the streets within the subdivision were submitted to the County Engineer, and water and sanitary sewer petitions were submitted to the City.

Public services (streets, sanitary sewer and water) were eventually extended to serve an initial phase of development of the plat. However, complete development of the plat did not and has not occurred. Apparently financial problems beset one or more developers or builders resulting in many of the undeveloped lots being sold at a tax sale last year. This has resulted in a situation where a number of lots are owned by individuals that have expressed an interest to this office to extend City of Wichita services so the lots can be developed.

Because many of the undeveloped lots are now owned by numerous parties, and because paving petitions initially submitted to the County Engineer are no longer valid, it will be virtually impossible for many of the lots to be developed without new petitions for streets, water and sewer. Therefore, it is requested that you issue no building permits in this addition until such time that new petitions and financial guarantees are submitted. Requests for building permits in this area should be referred to the City Engineer's office so that the proper petitions can be prepared.

If you have any questions, please contact me.

ML:GR:cp/7060p

cc: Steve Lackey, Director of Public Works



# THE CITY OF WICHITA



March 9, 1988

DEPARTMENT OF PUBLIC WORKS  
ENGINEERING DIVISION  
CITY HALL — SEVENTH FLOOR  
455 NORTH MAIN STREET  
WICHITA, KANSAS 67202  
(316) 268-4501

David Spears  
Director of Public Works  
Sedgwick County  
1250 South Seneca  
Wichita, KS 67213

Dear David:

As you know, Rainbow Lakes West Third Addition has been annexed in to the City.

I have become aware that you have paving plans for the area. There appears to be interest in developing the lots in Rainbow Lakes West Third Addition. Could you please forward the plans to this office.

Our interest is to save the property owners the cost of developing complete street plans.

Thanks for your consideration.

Sincerely,

Mike Lindebak, P.E.  
City Engineer

ML:cp/0103p

August 14, 1978

Mr. K. O. Taylor  
1542 S. St. Francis  
Wichita, Kansas 67211

Re: S/D 77-108 - Final Plat of Rainbow Lakes West 3rd Addition

Dear Mr. Taylor:

At the regular meeting of the Subdivision Committee of the Metropolitan Area Planning Commission, August 10, 1978, the above captioned plat was considered. The action of the Committee was to recommend that this plat be approved, subject to:

- A. The applicant and/or his engineer shall contact the City and County Public Works Department relative to streets to be indicated on the final plat.
- B. The applicant shall, by petition, guarantee the installation of City of Wichita sanitary sewer and domestic water service for each lot being platted.
- C. The minimum pad elevations approved for subject property shall be indicated on the face of the plat.
- D. At such time as the written approval of the submitted drainage plan has been given by the City Department of Public Works, the final plat will be forwarded to the Planning Commission.
- E. The plattor's text on the final plat indicates that drainage easements are being granted covering all of Lot 68, Block 4 and all of Lot 30, Block 5. These two lots then should not be platted as lots and it is recommended that they be platted as either drainage easements or drainage reserves.
- F. The applicant shall guarantee all drainage improvements required for this plat.
- G. The applicant shall guarantee the paving of all streets within the addition to City of Wichita Standards. The appropriate plans and profiles for said streets, when

8-14-78

designed, shall be submitted to the City Engineer for approval and a copy of the approved plans and profiles shall be submitted to the County Engineer.

- H. The applicant shall guarantee the construction of sidewalks on both sides of all streets within the plat.
- I. The applicant shall submit a plan indicating on which side of the 28 streets parking will be permitted. The applicant shall also submit a restrictive covenant which shall indicate on which of said streets parking is limited to one side, and a covenant stating that 4 off-street parking spaces will be provided on each lot adjoining the 58 foot street.
- J. Any raising or lowering, relocation or encasement of either the Phillips Petroleum or Cities Service pipe line crossing this property, as a result of the requirement improvements associated with this plat, shall be at the sole expense of the applicant.
- K. The applicant shall submit a Homeowners Association which provides for the continued maintenance of the lakes and all other common open space. Said association agreement shall also contain a provision or clause which will assure that the governing body can, upon proper notice and hearing, cause necessary maintenance to be done to said areas and the cost thereof assessed to the benefiting properties in the event the Homeowners Associations fails to do so.
- L. Easements as shown on the marked "engineer's copy" of the final plat shall be indicated on the final plat tracing.
- M. Recording of the plat within 30 days after approval of the plat by the Board of City Commissioners.

Enclosed with the applicant's copy of this letter is a list of the five methods which have been adopted as being acceptable for guaranteeing improvements required in the approval of plats. Forms for the bond and irrevocable letter of credit are available from this office.

The enclosed "marked" copy of the final plat is for your information and files.

This matter will be forwarded to the Planning Commission for its consideration on Thursday, August 17, 1978, at 1:30 p.m. If you should have any questions concerning this matter, please call.

Sincerely,

  
Curtis Newby  
Junior Planner

CN:bh

Encl.

K. O. Taylor - Page 3  
8-14-78

cc: L. U. Bell, 360 N 135th St., 67235  
Dean Sellers, Assistant City Engineer  
Chris Brennenstuhl, County Engineering

WICHITA - SEDGWICK COUNTY

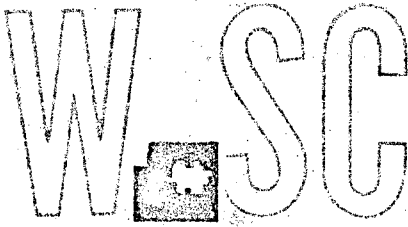

METROPOLITAN AREA PLANNING  
DEPARTMENT

CITY HALL — TENTH FLOOR  
455 NORTH MAIN STREET  
WICHITA, KANSAS 67202  
(316) 268-4561

March 27, 1978

K. O. Taylor  
1542 S. St. Francis  
Wichita, Kansas 67211

Subject: S/D 77-108 - Revised Preliminary Plat of Rainbow  
Lakes West Third Addition

Dear Mr. Taylor:

At their regular meeting of March 23, 1978, the Subdivision Committee of the Planning Commission considered the above referred to case. The action of the Committee was to approve the revised preliminary plat and authorize the submission of a final plat subject to the following conditions:

- A. Blocks 1 and 2 shall either be redesigned to eliminate the 50 foot wide tract of land adjacent to the southerly line of said blocks, or the lot lines in said blocks shall be extended to the southerly line of the 50 foot tract.
- B. This property is within the urban growth area, is being designed as an urban plat, and therefore must have municipal sewer and water systems and paved streets. Before submitting a final plat, definite arrangements shall be made for the sewer and water systems to serve each lot. The applicant has requested that subject property be annexed to the City of Wichita.
- C. Before submitting a final plat, the applicant or his engineer shall contact the City Department of Public Works regarding street names to be shown on the final plat.
- D. The applicant shall work with the Flood Control Office regarding the proposed lake system. Any drainage improvements required by the platting of this property shall be guaranteed by the applicant. Before submission of a final plat, the applicant shall obtain a memo from the Flood Control Office stating that the lake and drainage systems have been reviewed and will be acceptable.

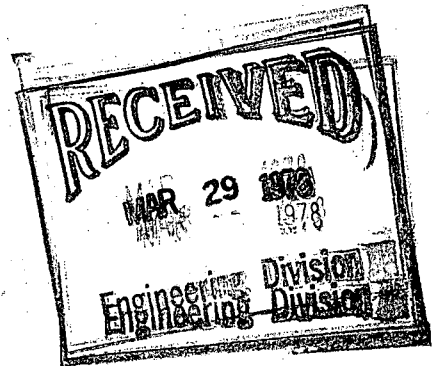

WICHITA - SEDGWICK COUNTY

- E. Any raising or lowering, relocation or encasement of either the Phillips Petroleum or Cities Service pipe lines crossing this property, as a result of the required improvements associated with this plat, shall be at the sole expense of the applicant.
- F. The applicant shall establish a Homeowners Association which provides for the continued maintenance of the lakes and all other common open space. Said association agreement shall also contain a provision or clause which will assure that the governing body can, upon proper notice and hearing, cause necessary maintenance to be done to said areas and the cost thereof assessed to the benefiting properties in the event the Homeowners Associations fails to do so.
- G. The area at the north line of the plat on the east side of Rainbow Lake Road on which appears the notation "to be platted into a lot with property north" shall be included as a lot with this plat.
- H. Sidewalks will be required on both sides of all streets except Maple.
- I. The applicant and/or his surveyor shall contact Tim Cain of the Department of Public Works relative to the appropriate street names to be indicated on the final plat.
- J. Requirements for a final plat (see pages 20-25, Part 4, Article 5 of the MAPC Subdivision Regulations).

If you have any questions concerning this matter, please call.

Sincerely,

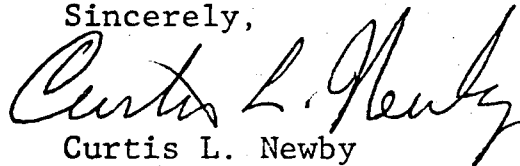

Curtis L. Newby  
Junior Planner

CLN:jm

cc: L. U. Bell, 360 N. 135th St. W., 67235

June 30, 1981

Mr. Joe Freeman  
Assistant Director of Public Works  
Sedgwick County  
1015 Stillwell  
Wichita, Kansas 67213

Dear Mr. Freeman:

This is a letter of inquiry regarding my letter to you of May 19, 1981 regarding "Subdivision Regulations" and to Mr. Schneider's letter to you of May 22, 1981 regarding Rainbow Lakes West 3rd Addition Lift Station Requirements" (copies of these letters are enclosed for your reference).

Would it be possible for you and Mr. Shelor to discuss this matter with myself and Don Schneider at an early date.

Yours truly,

  
Paul B. Graves, P. E.  
Chief Engineer

PBG:gr

cc: Claud Shelor, Director of Public Works, Sedgwick County  
John Dekker, Director of Law  
John Wynkoop, Director of Water & Water Pollution Control  
Robert Lakin, Director of Planning  
R. W. Bruggeman, Director of Engineering  
Don Schneider, Sanitary Engineer

# THE CITY OF WICHITA



DEPARTMENT OF ENGINEERING  
CITY HALL — SEVENTH FLOOR  
455 NORTH MAIN STREET  
WICHITA, KANSAS 67202  
(316) 268-4501

May 22, 1981

Mr. Joe D. Freeman, P.E.  
Deputy Director of Public Works  
Sedgwick County Dept. of Public Works  
1015 Stillwell  
Wichita, KS 67213

Dear Mr. Freeman:

Subject: Generator Unit Submittal - Rainbow Lakes West 3rd

I have reviewed the above proposed submittal and note the following:

1. The submittal seems to provide a gasoline engine powered unit instead of natural gas as required by specifications.
2. The proposed weather-protective housing does not appear to conform to specification requirements. It appears the specifications require a partially buried enclosure such as the Power-Pac Series 2000 as manufactured by Stannard Power or an approved equal.
3. The specifications also require various accessory equipment. I am not able to ascertain from this submittal whether or not all of the required accessory equipment is included.

Please contact me if you have any questions.

Very truly yours,

Donald E. Schneider, P.E.  
Sanitary Engineer

DES/dla

cc: Paul B. Graves, Chief Engineer y

pas  
F

May 19, 1981

Mr. Joe Freeman  
Assistant Director of Public Works  
Sedgwick County  
1015 Stillwell  
Wichita, Kansas 67213

Dear Mr. Freeman:

Enclosed are copies of the following documents concerning sanitary sewer extensions beyond Wichita City Limits but within the "three mile limit" that eventually connect to the City's sanitary sewer facilities:

1. City of Wichita, Department of Engineering letter dated April 6, 1981, signed by Don Schneider, Sanitary Engineer, requesting certain changes to be accomplished within "Plans and Specifications" regarding the sewer to serve Deer Lakes Estates (Oaklawn Improvement District).
2. Response from Reiss & Goodness Engineers to the above letter, signed by A. E. Reiss, P. E., dated May 1, 1981, indicating some approval of our request, but basically advising that "Oaklawn" did not believe Wichita approval was required.
3. Another letter dated May 1, 1981, signed by A. E. Reiss, P. E., Reiss & Goodness Engineers, advising that, for inspection approval, "Oaklawn does not feel that obtaining your approval is necessary because they are to maintain their own system." Mr. Reiss further indicated that construction was to begin by approximately May 8, 1981.

Mr. Morris Dingler, of Reiss & Goodness Engineers, has verbally advised me via telecon that neither "Oaklawn" nor "Bel Aire" Improvement Districts required any jurisdictional approval (City and/or County) because the districts were incorporated districts.

Mr. Joe Freeman  
Assistant Director of Public Works  
Sedgwick County

May 19, 1981

The Subdivision Regulations indicate only two approval agencies - City of Wichita and Sedgwick County. In addition, the City of Wichita has "prior contracts or agreements" with both improvement districts that suggest "plan and specification" approval by the City of Wichita.

We would appreciate receiving your thoughts, comments and recommendations.

Yours truly,



Paul B. Graves  
Chief Engineer

PBG:gr

Enclosures

cc: Claud Shelor, Director of Public Works, Sedgwick County  
R. W. Bruggeman, Director of Engineering  
John Dekker, Director of Law  
Robert Lakin, Director of Planning  
John Wynkoop, Director of Water & Water Pollution Control



REISS & GOODNESS ENGINEERS  
2160 WEST 21<sup>ST</sup> STREET - WICHITA, KANSAS 67203 (316) 832-0213

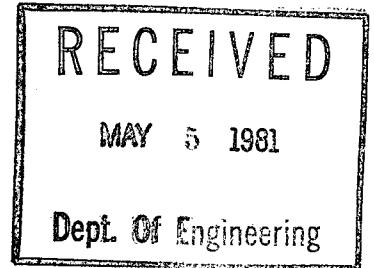

May 1, 1981

Mr. Paul Graves  
City Engineer  
7th Floor, City Hall  
455 N. Main  
Wichita, Kansas 67202

RE: Deer Lake Estates  
Oaklawn Improvement District

Dear Mr. Graves:

We have been requested by Don Schneider of your office to request your approval to do the inspection work for the Sanitary Sewer Extension in Oaklawn Improvement District.

The District does not feel that obtaining your approval is necessary because they are to maintain their own system.

The contractor is planning to start construction the end of this week.

If you want your department to spot check the work, Oaklawn is agreeable with this.

Sincerely,

REISS & GOODNESS ENGINEERS

  
A. E. Reiss, P.E.

AER/MED/cr

cc; Oaklawn Improvement District -

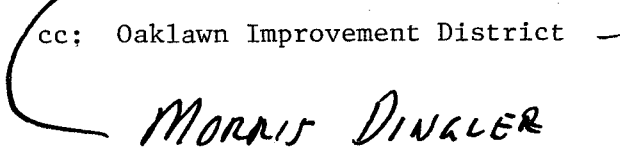
  
MORRIS DINKLER



REISS & GOODNESS ENGINEERS  
2160 WEST 21<sup>ST</sup> STREET - WICHITA, KANSAS 67203 (316) 832-0213

May 1, 1981

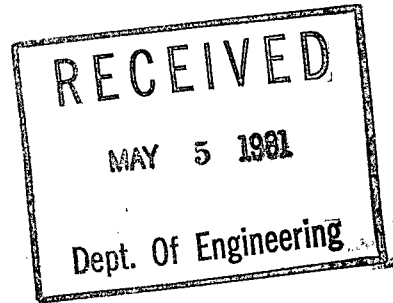

Mr. Don Schneider, P.E.  
Sanitary Engineer  
City Hall - 7th Floor  
455 N. Main  
Wichita, Kansas 67202

RE: Sanitary Sewer Extensions  
Deer Lakes Estates

Dear Mr. Schneider:

In regard to your letter of April 6, 1981, Oaklawn Improvement District offers the following in reply to your numbered comments:

1. The Contractor plans to use PVC pipe and poured-in-place manholes meeting the specifications in the Specifications Booklet and as shown on the detailed plans.
2. Oaklawn does not install stubs due to the potential for infiltration problems caused by leaking stubs.
3. Oaklawn will raise the drop of the manholes above the 100 year Flood elevation as requested.
4. The inspector will coordinate all easements with the Contractor.
5. Poured-in-place manholes will be used.
6. Oaklawn has had poor experience with brick manholes allowing infiltration to enter into the system after they have been in service for 15 to 20 years and since the City of Wichita charges Oaklawn on a gallonage figure each month Oaklawn is going to use poured-in-place manholes so that the District can provide better infiltration protection than can be provided with brick manholes.
7. The plans show adequate dimensions for the inspector to stake the lines.
8. The manhole standards only allow a 2' maximum inside drop. All drops over 2' will be outside drops.
9. Oaklawn sees no reason for requiring a double line on Jonquil Street and therefore will not change the design.
10. We will field change the plans to eliminate a high velocity section of line.
11. The sewer line is designed to be installed in a platted easement and not in street right-of-way.

Page Two  
Mr. Don Schneider, P.E.  
May 1, 1981

12. There is 60 Lin. Ft. of aerial crossing and 3 piers specified with 20 foot joints. There will be a support at every joint.

13. The City of Wichita specifications shall govern where there is a conflict between the two except that a backhoe may be used on the project and sand backfill will be used only where specified on the plans.

14. The Contractor is to make the arrangements for the air testing and television inspection.

15. Oaklawn Improvement District prefers to have our firm do the inspection.

The Contract between the City and Oaklawn does not require the City to do the inspection. But as requested we will request this permission from the City Engineer.

Very truly yours,

REISS & GOODNESS ENGINEERS

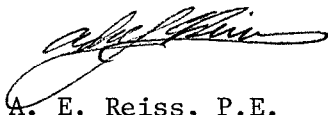

A. E. Reiss, P.E.

AER/MED/rmk

cc: Oaklawn Improvement District

*Deer Lakes  
Sewer Plan.*

*file*

# THE CITY OF WICHITA



DEPARTMENT OF ENGINEERING  
CITY HALL — SEVENTH FLOOR  
455 NORTH MAIN STREET  
WICHITA, KANSAS 67202  
(316) 268-4501

April 6, 1981

Mr. Al Reiss, P.E.  
Reiss & Goodness, Engineers  
2160 West 21st Street  
Wichita, Kansas 67204

Subject: Review of Plans and Specifications for Sanitary Sewer  
Extensions to Deer Lakes Estates

Dear Mr. Reiss:

I have reviewed the plans and specifications for the above noted project and my comments are as follows:

1. Plans do not indicate type of pipe or type of manholes which will be permitted.
2. Plans must indicate where stubs must be installed in manholes to facilitate future connection of building sewers.
3. It is imperative that tops of manholes be set to match proposed finished grades. Plans indicate specific elevations for tops of manholes at some locations. Required top of manhole elevations at other locations are vague. It is City policy to set tops of manholes to elevations which will preclude entrance of extraneous storm water into the sanitary system. Our present policy is to set tops of manholes above the 100 year flood elevation or 0.4' above finished grade, whichever of these elevations is the highest. Manhole tops set below the 100 year flood elevation must have water-tight covers.
4. Plans do not indicate what right of way exists to facilitate construction of this project for its entire alignment.
5. Only certain types of manholes can be used for depths exceeding 16'.
6. Only certain types of manholes can be used on lines larger than 8".
7. Plans do not dimension exact location of proposed sewer in many locations. At least one dimension shown on plans is not correct.

# THE CITY OF WICHITA

April 6, 1981

Mr. Al Reiss, Page 2

8. Plan and profile sheets should distinguish between outside drop connections and inside drop connections at such manhole locations.
9. Our policy does not permit installation of 4" or 6" service lines across street right of way to serve lots on the side of the street opposite from the side of the street on which the public sewer is located as shown on Main II along Jonquil.
10. The City and the State Health Department both require special construction to protect against high velocity erosion. Our policy is that sanitary sewers which could have velocities exceeding 8 feet per second require this special construction. Pipes which could have velocities in excess of 8 feet per second must be ductile iron pipe with a fused chemically inert polyethylene lining with nominal 40 mil thickness in conjunction with provisions to anchor the sewer pipe securely in place. Such pipe, however, cannot be used in locations where it is necessary to tap the line to facilitate connection of future building sewers.
11. It is our policy to reserve a 4' width adjacent to ultimate street right of way lines for use as sidewalk. Tops of manholes constructed in street right of way must not encroach within this 4' width. We prefer to show the centerline of such manholes as being 2' outside the walk area.
12. City and State Health Department minimum standards require that all joints in pipes utilized for aerial crossings be supported.
13. Technical specifications are vague as to which specifications actually are applicable. Sewers which discharge into the City of Wichita sanitary sewer must be installed in conformance with City of Wichita specifications and minimum standards.
14. Arrangements must be made with John Kraus, Construction Engineer with this Department, for the air testing and television inspection of the completed sewer lines.
15. Normally all new sewer construction which discharges to the City of Wichita system is inspected by City employees. However, such construction may be inspected by consulting engineers with written approval from the City Engineer of the City of Wichita. It appears that your firm will be doing the construction inspection on this project, and therefore you should make a written request for approval to the City Engineer.

My approval of these plans and specifications at this time, subject to the above comments, should not be misconstrued as a blanket certification as to their accuracy, completeness, and conformance to required standards. Should other errors, omissions, and non-conformance to required standards in the plans and specifications become evident in the future, these items should be corrected by the usual and accepted methods.

# THE CITY OF WICHITA

April 6, 1981

Mr. Al Reiss, Page 3

We will require one set of reproducible sheets of the completed plan for our permanent file.

Very truly yours,

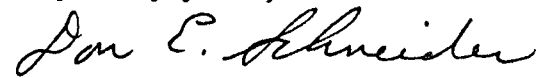

Don E. Schneider, P.E.  
Sanitary Engineer

DES:md

cc: Darrell Brewer  
Paul Graves

THE CITY OF WICHITA

OFFICE OF ENGINEERING

DATE SEPTEMBER 4, 1981

TO JOHN KRAUS, CONSTRUCTION ENGINEER

FROM DONALD E. SCHNEIDER, SANITARY ENGINEER

SUBJECT LIFT STATION AND FORCE MAIN  
PROJECT IN RAINBOW LAKES  
WEST 3RD ADDITION

I wish to document to you that when the standby power module is installed by the contractor for the above noted project it will be necessary to slightly tilt the module such that the floor in the module will drain to the sump pump.

Donald E. Schneider, P.E.  
Sanitary Engineer

/dla

cc: Susan Moeder, Utility Contractors, Inc.



SEDGWICK COUNTY COURTHOUSE

**COUNTY OF SEDGWICK**  
**DEPARTMENT OF PUBLIC WORKS**

1250 S. SENECA  
WICHITA, KANSAS 67213

PHONE 268-7901

**Claud S. Shelor, P.E.**  
County Engineer/Director of Public Works

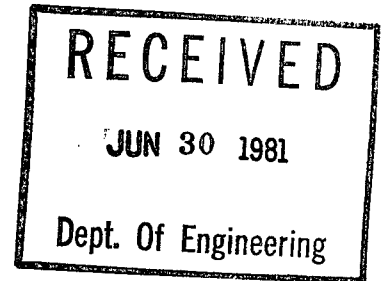

June 29, 1981

Engineering Department  
City of Wichita  
Mr. Paul Graves  
455 North Main  
Wichita, KS 67202

RE: Rainbow Lakes West 3rd Addition,  
Sanitary Sewers

Dear Mr. Graves:

Attached for your records one copy of:

1. Permit #16408 for extension of sanitary sewers for the referenced project.
2. Approved specifications for sanitary sewer extensions for the referenced project.
3. Approved specifications for the pump station and force main for the referenced project.

We also have and will retain in our file an approved title sheet for both sets of plans for this project.

Yours very truly,

Joe D. Freeman, P.E.  
Deputy Director of Public Works

attachment

cc: A. J. Harkness

JDF/y1s



STATE OF KANSAS  
DEPARTMENT OF HEALTH AND ENVIRONMENT  
DIVISION OF ENVIRONMENT  
APPROVAL OF PLANS AND SPECIFICATIONS

PERMIT NO. 16408 AND FOR EXTENSION OF A SANITARY SEWER

In accordance with the provision of K.S.A. 65-165 and K.S.A. 65-166 as amended, the Division of Environment has granted approval\* to the Plans and Specifications

for Rainbow Lakes West 3rd Addition and hereby grants permission to  
(Sewer District, Subdivision or Other)

A. J. Harkness, Sewer and Stream Maintenance, 1250 South Seneca, Wichita, Kansas 67213  
(Name of Municipality, District, Institution, Corporation of Person, and Mailing Address)

to discharge sewage from sewer extensions serving Rainbow Lakes West 3rd Addition  
(Sewer District, Subdivision or Other)

into City of Wichita, and thence treated into  
(Name of Receiving Sewer System)

Arkansas River in compliance with Kansas Water Pollution  
(Name of Receiving Stream or Lake)

Control Permit No. M-AR49-I001, effective August 1980.

\*Subject to the following conditions and requirements: \_\_\_\_\_

We have noted that the project references approved specifications currently on file with our office entitled: \_\_\_\_\_

We are returning: Four (4) plan cover sheets and four (4) specification cover sheets.

Continuous engineering observation of the construction of the proposed improvements, (observation of building sewer connections shall be the responsibility of the owner unless otherwise specified in contract documents), shall be provided in accordance with Kansas Department of Health and Environment Regulation 28-16-55 and as defined in Water Quality Policy Memorandum #2-78, effective January 18, 1978.

Notification that the project has been completed in substantial accordance with the approved plans and specifications must be reported to the Division of Environment with the attached form.

For the Secretary, Department of Health and Environment.

Done at Topeka, this 9th day of June 19 81

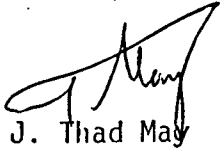
  
J. Thad May  
Environmental Engineer  
Water Pollution Control

S P E C I F I C A T I O N S  
FOR  
SANITARY SEWER EXTENSIONS  
RAINBOW LAKES WEST THIRD ADDITION  
SEDGWICK COUNTY, KANSAS

1980

**RECEIVED**

JUN 1 1981

**DIVISION OF  
ENVIRONMENT**

16408

STATE OF KANSAS  
APPROVED  
DIVISION OF ENVIRONMENT

JUN 9 1981

*C. May*

TOPEKA, KANSAS ENG

REISS & GOODNESS ENGINEERS  
2160 WEST 21st STREET  
WICHITA, KANSAS 67203



**RECEIVED**

SPECIFICATIONS JUN 1 1981

FOR  
SANITARY SEWER EXTENSION  
PUMPING STATION & FORCE MAIN  
RAINBOW LAKES WEST THIRD ADDITION  
SEDGWICK COUNTY, KANSAS

**DIVISION OF ENVIRONMENT**

16408

1981

STATE OF KANSAS  
**APPROVED**  
DIVISION OF ENVIRONMENT

JUN 9 1981

*May*  
TOPEKA, KANSAS ENG

REISS & GOODNESS ENGINEERS  
2160 WEST 21st STREET  
WICHITA, KANSAS 67203

CHARLES B. GOODNESS  
LICENSED  
2733  
KANSAS  
PROFESSIONAL ENGINEER  
*Charles B. Goodness*



STATE OF KANSAS  
DEPARTMENT OF HEALTH AND ENVIRONMENT  
DIVISION OF ENVIRONMENT  
APPROVAL OF PLANS AND SPECIFICATIONS  
AND

PERMIT NO. 16408 FOR EXTENSION OF A SANITARY SEWER

In accordance with the provision of K.S.A. 65-165 and K.S.A. 65-166 as amended, the Division of Environment has granted approval\* to the Plans and Specifications

for Rainbow Lakes West 3rd Addition and hereby grants permission to  
(Sewer District, Subdivision or Other)

A. J. Harkness, Sewer and Stream Maintenance, 1250 South Seneca, Wichita, Kansas 67213  
(Name of Municipality, District, Institution, Corporation of Person, and Mailing Address)

to discharge sewage from sewer extensions serving Rainbow Lakes West 3rd Addition  
(Sewer District, Subdivision or Other)

into City of Wichita, and thence treated into  
(Name of Receiving Sewer System)

Arkansas River in compliance with Kansas Water Pollution  
(Name of Receiving Stream or Lake)

Control Permit No. M-AR49-I001, effective August 1980

\*Subject to the following conditions and requirements:  
\_\_\_\_\_  
\_\_\_\_\_  
\_\_\_\_\_

We have noted that the project references approved specifications currently on file with our office entitled: \_\_\_\_\_

We are returning: Four (4) plan cover sheets and four (4) specification cover sheets.

Continuous engineering observation of the construction of the proposed improvements, (observation of building sewer connections shall be the responsibility of the owner unless otherwise specified in contract documents), shall be provided in accordance with Kansas Department of Health and Environment Regulation 28-16-55 and as defined in Water Quality Policy Memorandum #2-78, effective January 18, 1978.

Notification that the project has been completed in substantial accordance with the approved plans and specifications must be reported to the Division of Environment with the attached form.

For the Secretary, Department of Health and Environment.

Done at Topeka, this 9th day of June 19 81

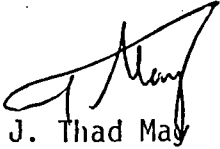
  
J. Thad May  
Environmental Engineer  
Water Pollution Control

S P E C I F I C A T I O N S  
FOR  
SANITARY SEWER EXTENSIONS  
RAINBOW LAKES WEST THIRD ADDITION  
SEDGWICK COUNTY, KANSAS

1980 **RECEIVED**  
JUN 1 1981

**DIVISION OF ENVIRONMENT**

16408

STATE OF KANSAS  
APPROVED  
DIVISION OF ENVIRONMENT

JUN 9 1981  
*C. May*  
\_\_\_\_\_  
TOPEKA, KANSAS ENG'.

REISS & GOODNESS ENGINEERS  
2160 WEST 21st STREET  
WICHITA, KANSAS 67203

*Charles W. Goodness*  
**CHARLES W. GOODNESS**  
**LICENSED**  
**KANSAS**  
**PROFESSIONAL ENGINEER**

**RECEIVED**

SPECIFICATIONS JUN 1 1981

FOR  
SANITARY SEWER EXTENSION  
PUMPING STATION & FORCE MAIN  
RAINBOW LAKES WEST THIRD ADDITION  
SEDGWICK COUNTY, KANSAS

**DIVISION OF ENVIRONMENT**

16408

1981

STATE OF KANSAS  
APPROVED  
DIVISION OF ENVIRONMENT

JUN 9 1981

*May*  
TOPEKA, KANSAS ENG.

REISS & GOODNESS ENGINEERS  
2160 WEST 21st STREET  
WICHITA, KANSAS 67203

CHARLES E. GOODNESS  
LICENSED  
KANSAS  
PROFESSIONAL ENGINEER  
*Charles E. Goodness*



Thurman Smith  
11216 West Maple  
Wichita, Kansas 67209

20 March 1981

Mr. John Wynkoop  
Director of Water & Water Pollution Control  
City Hall  
455 North Main  
Wichita, Kansas 67202

Re: Rainbow Lakes West 3rd Addition

Dear Mr. Wynkoop:

At the request of the City of Wichita, Engineering Department, Inspection Division, I have retained Allied Laboratories Department of Professional Engineering Consultants, P.A. to locate, place and/or replace all property corners necessary for construction of the improvements and utilities in the referenced subdivision.

Transmitted herewith is a color coded copy of the final plat, on which I have marked all irons they have found (38 each) and those set (84 each), as well as some apparent location errors for 3 of the irons found. You will receive a copy of my letter to the Sedgwick County Director of Public Works concerning my request for his determination as to what to do regarding the irons that appear to be misplaced.

It is my understanding that your Department will be the Contract Administrator as well as the inspector for the water line improvements.

As owner of this development, I am requesting your assistance in maintaining all of the irons as shown on the attached drawing and to verify that they are in place and correctly located on completion of construction.

As I have discussed with other City officials in the past, there is considerable expense in the installation of these irons and it seems only fair that verification that they are still in place is an appropriate part of the final phase of any construction project.

I thank you in advance for any assistance you may be able to give.

Very truly yours,



Thurman Smith

csa

cc: SCDPW

cc: Bruggeman

Thurman Smith  
11216 West Maple  
Wichita, Kansas 67209

23 March 1981

Claud S. Shelor, P.E.  
Director of Public Works  
Sedgwick County Department of Public Works  
1248 South Seneca  
Wichita, Kansas 67213

Attention: Joe Freeman, P.E.

Re: Rainbow Lakes West 3rd Addition

Dear Mr. Shelor:

I have recently had Allied Laboratories Department of Professional Engineering Consultants, P.A. locate, place and/or replace the property corners shown on the enclosed drawing so that construction of the sanitary sewers for the subject project could proceed. Please note that 38 irons were found, and that 84 new irons had to be set. In addition, please note that three of the irons found appear to be in the wrong location. The north-east iron in Forestview Circle will be pulled as a part of the staking for Rainbow Lakes West Fifth Addition, and as such should be no further problem. The two irons on the west side of Angela, though, would appear to be a problem for street construction and street right-of-way. Allied Laboratories has advised me that they are reluctant to move or change these two particular irons without authorization or direction from the appropriate governing body.

Would you please review this problem and advise me what I should do, if anything? If your Department is to take independent action to correct this situation, I would be pleased if you would keep me advised so correct control pins will be used for the other utilities to be installed.

As part of this overall property corner situation, I have spent considerable money to have all the necessary property pins located and flagged up. It is my understanding that the City of Wichita is to inspect the sanitary sewer, street and storm drain construction as a part of Contracts to be administrated by your office. Would you please see that these irons are maintained and in their proper location on completion of the construction? I have sent letters to both Mr. Bruggeman and Mr. Wynkoop in this regard, copies of which are attached, and hope you will understand my concern. It seems to me that replacement or protection of these irons should be as much a part of a benefit district construction project as the protection and maintenance of any other improvement on private or public property. I would hope your views on this matter are the same as mine, and would be pleased to discuss this with you if you believe it would help.

Rainbow Lakes West 3rd Addition

23 March 1981

Page 2

I thank you in advance for any assistance you may be able to give relative to this problem.

Very truly yours,

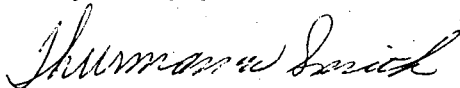

Thurman Smith

csa

enclosures

cc: J. Wynkoop

R. W. Bruggeman

**THE CITY OF WICHITA**

**OFFICE OF** ENGINEERING DEPARTMENT  
Construction/Survey

**DATE** February 9, 1981

**TO** R. W. Bruggeman, Director of Engineering/City Engineer

**FROM** John Kraus, Construction Engineer

**SUBJECT** Pre-Construction Conference -  
Sanitary Sewer to serve Rainbow Lakes  
3rd Addition

This is to inform you that a pre-construction conference will be held.

**Subject:** Sanitary Sewer to serve Rainbow Lakes  
3rd Addition

**Time:** Wednesday, February 18, 1981, 1:30 p.m.

**Location:** Department of Engineering Conference Room,  
7th Floor, City Hall, 455 N. Main.

I hope you will be able to attend the pre-construction. If you have any questions, please don't hesitate to contact me at 268-4450.

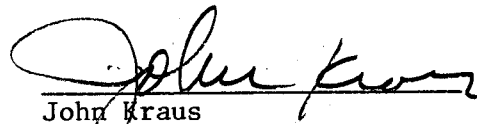
  
John Kraus  
Construction Engineer

GF/02/04

**THE CITY OF WICHITA**

**OFFICE OF ENGINEERING DEPARTMENT**

**DATE** December 4, 1980

F

**TO** R. W. Bruggeman, Director of Engineering

**FROM** Paul B. Graves, Chief Engineer

**SUBJECT** Meeting of November 25, 1980 with  
Thurman Smith Re. Rainbow Lakes 3rd  
Addition Sewer System

On November 25 and once again on November 26, staff members Don Schneider, Darrell Brewer, Mike Lindebak and myself met at the request of Thurman Smith to discuss some of the problems that he was encountering involving the Rainbow Lakes 3rd Addition Sewer System.

The first meeting occurred on November 25 with those present being Gary Wiley, PEC; Don Schneider; Darrell Brewer; Mike Lindebak; Thurman Smith and myself with the meeting beginning at approximately 3:00 p.m. Discussion largely concerned the gravity and force main system plus the lift station. Thurman Smith expressed his concern about getting the project under construction at an early date and, also, as to whether the system was being designed to provide for the developable area which is larger than the established benefit district (benefit district established by Sedgwick County Resolution). Thurman Smith also indicated that he was concerned that the Consulting Engineers, Reiss & Goodness, were not processing the plans at a rapid enough pace and inquired as to what the City might do in order to expedite the plan completion. Don Schneider indicated that the plans on the gravity lines were almost complete and he was waiting for a final revision to be completed by the Consultant. Don said that the existing plan size of the force main (8-inch) was adequate but that the lift station was under-sized with regard to pumping capacity.

Thurman Smith inquired also about possible annexation of the area by the City of Wichita and having the City take over the paving and storm sewers design and construction. It was noted at this point, however, that all the paving plans have been completed and, also, the storm sewer plans completed by Reiss & Goodness. So the net result, was that this work already having been completed, that little could be gained by the City of Wichita becoming involved at this late date.

Going back to the size of the lift station regarding pumping capacity, it was estimated on this date that there were 583 dwelling units contained within the Standard quarter, Rainbow Lakes 3rd and 4th Addition plus the proposed 5th Addition. There are also a remaining number of unknown dwelling units that would be contained with the Murray 80-acre trac (At our meeting on the 26th of November, 1980, it was determined that dwelling use on the Murray 80-acre trac would be 287). It was indicated by Thurman Smith that he had an additional 160 acres that he

Dum

R. W. Bruggeman, Director of Engineering  
Subject: Meeting of November 25, 1980 with  
Thurman Smith Re. Rainbow Lakes 3rd  
Addition Sewer System

December 4, 1980

Page 2

might add in future development which would be above and beyond the present benefit district as defined by the County. If the developable area, as indicated, were to be developed then Don Schneider indicated that probably a 10-inch force main would be a requirement also providing for additional pumping capacity. Thurman Smith indicated that he is considering the future development of the additional 160 acres.

Mr. Smith indicated as the meeting came to close that he may proceed to seek annexation and he also expressed his concern about the possibility of the City of Wichita (upon annexation) would have the sidewalks installed by a City petition. It also appeared best to proceed with the sewers and paving under County control and County plans. Mr. Smith and his Associate, Gary Wiley, indicated that they plan to visit with County Engineer, Joe Freeman, about expediting a plan completion and would get back in touch with us on the following date. Prior to their leaving the meeting, they asked if we, the City, would consider meeting with them and the County representatives on the 26th of November and we indicated we would do so. Don Schneider also pointed out that requirements on the pump station would have to have a secondary source of power and stated that the original plans as presented by the Consultant did provide by the second source of power - apparently the most recent set of plans that Don had seen did not contain that item...

On the following day, November 26, the following persons met again to discuss Rainbow Lakes 3rd Addition. Those being present were Gary Wiley, PEC; Andy Harkness, Sedgwick County; Joe Freeman, Sedgwick County; Mike Lindebak; Don Schneider and myself. Mr. Schneider indicated, since yesterday, some additional information and study that the pumps should provide for at least 600 gallons per minute with an 8-inch suction line and an 8-inch force main. However, if the additional 160 acres were to be placed on the lift station, the pumping requirement would be 940 gallons per minute (which could be provided by additional horse power motor and larger impellers). Don also indicated that he would recommend a 10-inch force main be used which would in turn reduce somewhat the power requirements and pumping requirements by providing for a larger force main.

Joe Freeman from the County indicated that probably the plans for the gravity system would be ready to advertise for bid approximately December 24, 1980.

R. W. Bruggeman, Director of Engineering  
Subject: Meeting of November 25, 1980 with  
Thurman Smith Re. Rainbow Lakes 3rd  
Addition Sewer System

December 4, 1980  
Page 3

The meeting concluded at this point with Joe Freeman indicating he would contact the Consultant and advise him to proceed as rapidly as possible with plan completion. Today's date is December 4 and I have heard nothing further from Mr. Freeman or Mr. Smith so I can only assume that things are proceeding according to the agreed upon procedure.

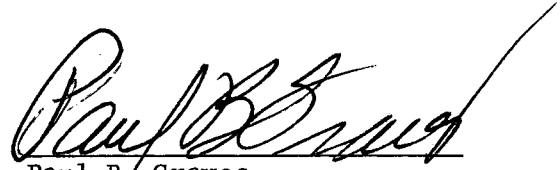

Paul B. Graves  
Chief Engineer

PBG:gf

- cc: Mike Lindebak, Program Development Engineer
- Don Schneider, Sanitary Sewer Engineer
- Darrell Brewer, Sewer Maintenance
- Joe Freeman, Sedgwick County Public Works Department
- Andy Harkness, Sedgwick County Public Works Department
- Gary Wiley, Professional Engineering Consultants
- Thurman Smith, Developer

F  
PSS

March 30, 1981

Mr. W. C. Payne, P.E.  
Chief Engineer  
Sedgwick County  
Department of Public Works  
1250 S. Seneca  
Wichita, KS 67213

Subject: Sanitary Sewer Project for Rainbow Lakes West 3rd Addition

Dear Mr. Payne:

It appears revised plan sheets are necessary on the above noted project due to replatting of a portion of the area. This replatting makes it necessary to revise plan sheets numbers 2 and 4.

Information provided to me by the Planning Department indicates that Rainbow Lakes West 6th Addition is not final platted, therefore, easement does not exist for the proposed line to serve Lot 2 in said 6th Addition. Right of way for this line must be dedicated by separate instrument if it is desired to construct this line before Rainbow Lakes West 6th Addition plat is finalized.

Please contact me if you have any questions.

Very truly yours,

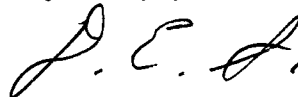

Don E. Schneider, P.E.  
Sanitary Engineer

GF/01/01

cc: Paul Graves, Chief Engineer  
John Kraus, Construction Engineer



SEDGWICK COUNTY COURTHOUSE

# COUNTY OF SEDGWICK

DEPARTMENT OF PUBLIC WORKS

1250 S. SENECA  
WICHITA, KANSAS 67203

PHONE 268-7901

MAR 30 1981

Office of the City Manager

SH \_\_\_\_\_

RGF \_\_\_\_\_  DF \_\_\_\_\_

RT \_\_\_\_\_  MEC \_\_\_\_\_

Copies To \_\_\_\_\_

Send To \_\_\_\_\_

File \_\_\_\_\_

March 27, 1981

Don E. Schneider, Sanitary Engineer  
 City of Wichita  
 Department of Engineering  
 455 North Main, 7th Floor  
 Wichita, KS 67202

Re: Rainbow Lakes West Third  
 Sanitary Sewer Improvements

Dear Mr. Schneider:

Transmitted herewith is a drawing covering the changes necessitated by the replat of Rainbow Lakes West Sixth Addition.

Very truly yours,

  
 W. C. Payne, P.E.  
 Chief Engineer

WCP/dn

Enclosure

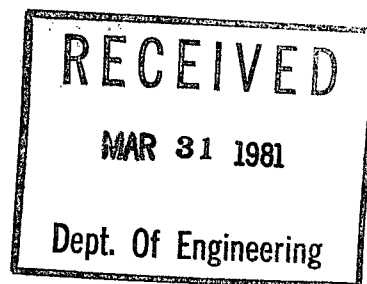

# SANITARY SEWER EXTENSIONS

RAINBOW LAKES WEST THIRD ADDITION  
TO SEDGWICK COUNTY, KANSAS

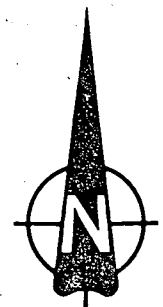
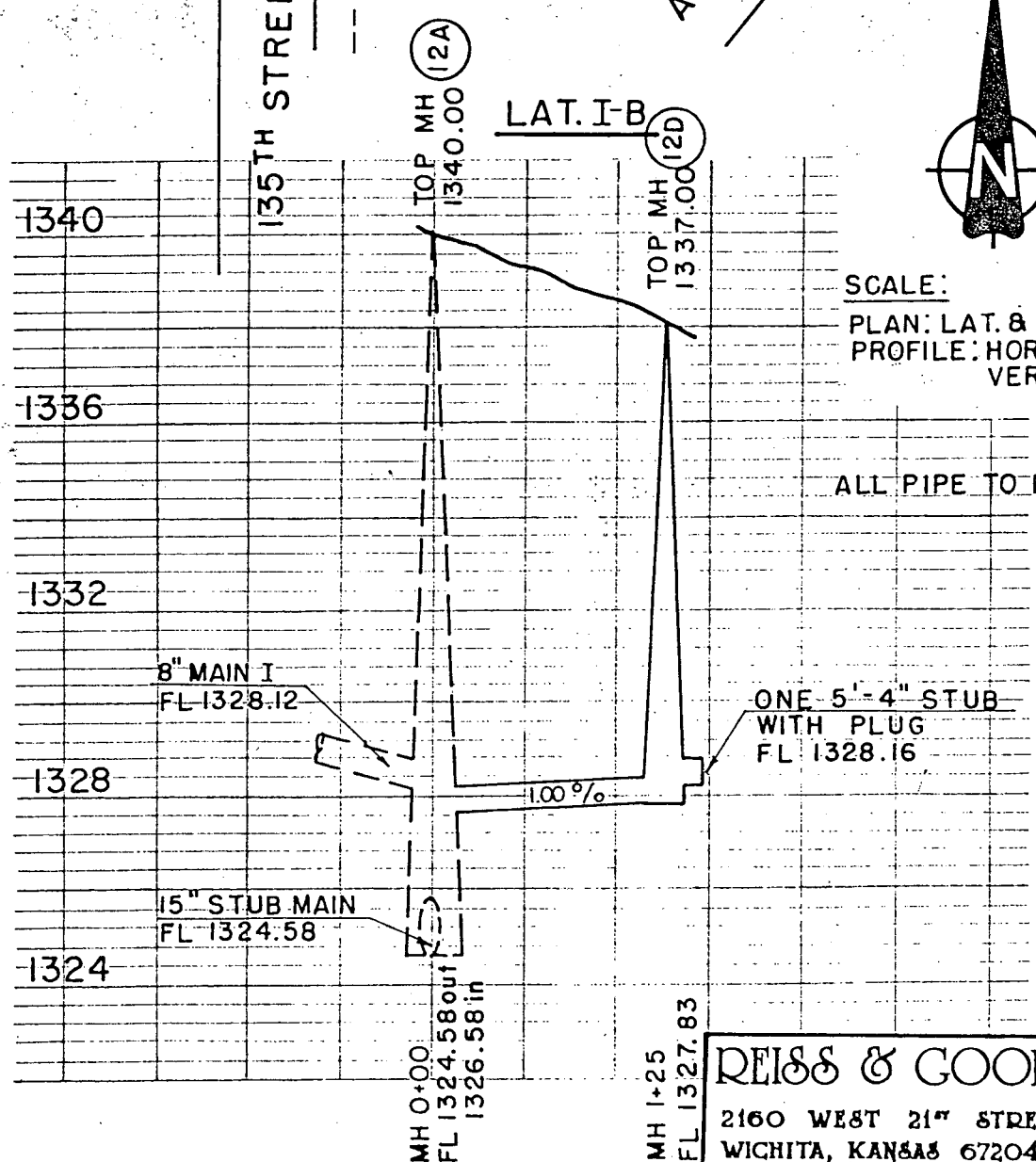
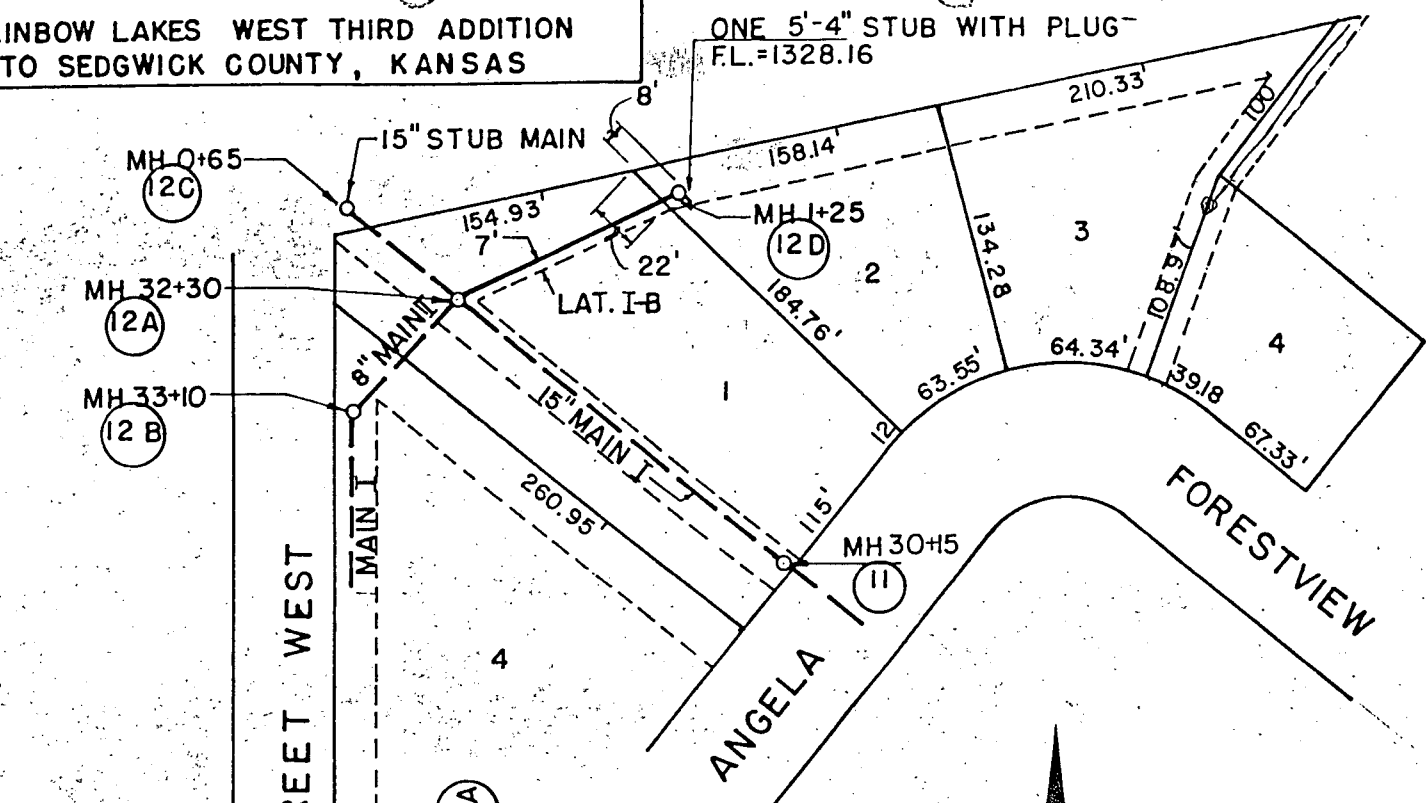

SCALE:  
 PLAN: LAT. & LONG. — 1" = 100'  
 PROFILE: HORIZ. — 1" = 100'  
 VERT. — 1" = 4'

ALL PIPE TO BE 8"

REISS & GOODNESS ENGINEERS

2160 WEST 21<sup>ST</sup> STREET  
 WICHITA, KANSAS 67204  
 (316) 832-0212



# SANITARY SEWER EXTENSIONS

RAINBOW LAKES WEST THIRD ADDITION  
TO SEDGWICK COUNTY, KANSAS

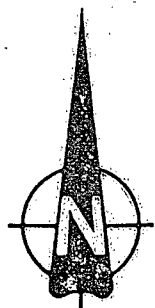
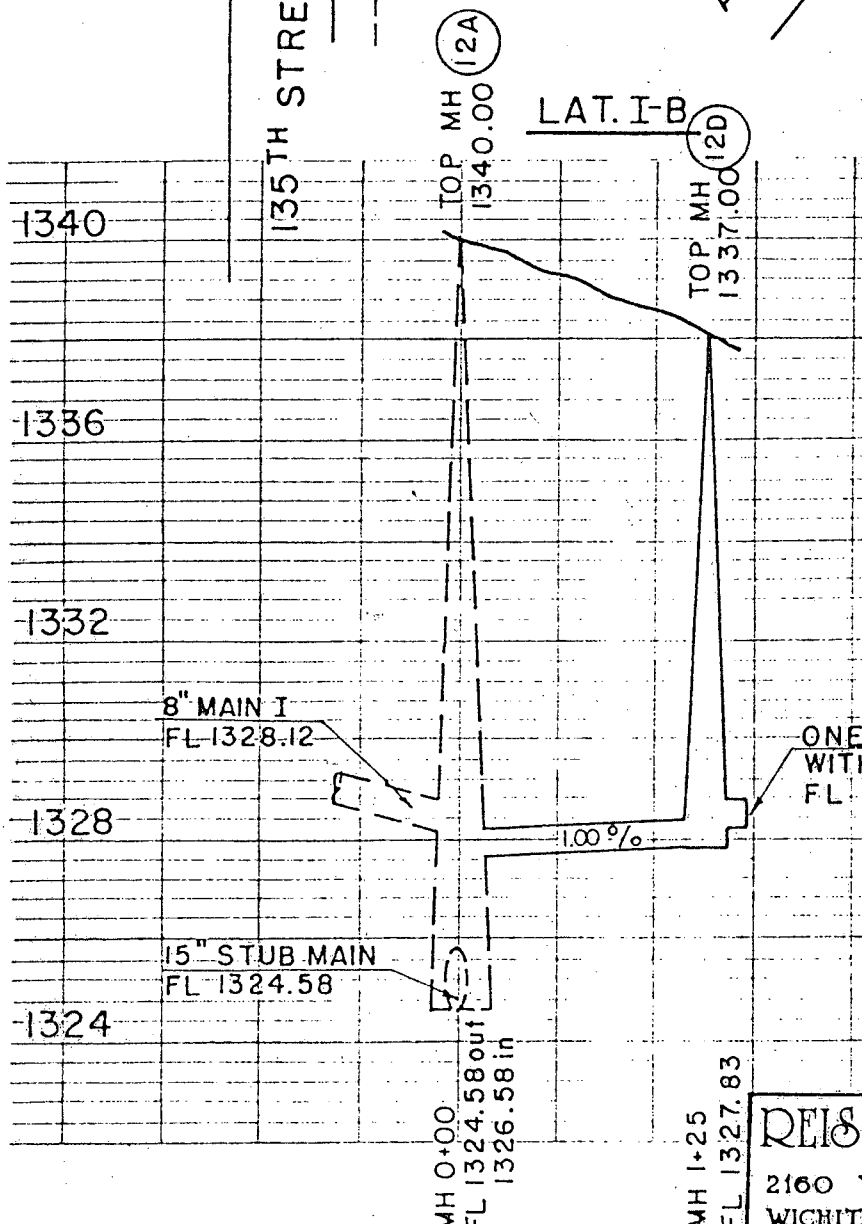
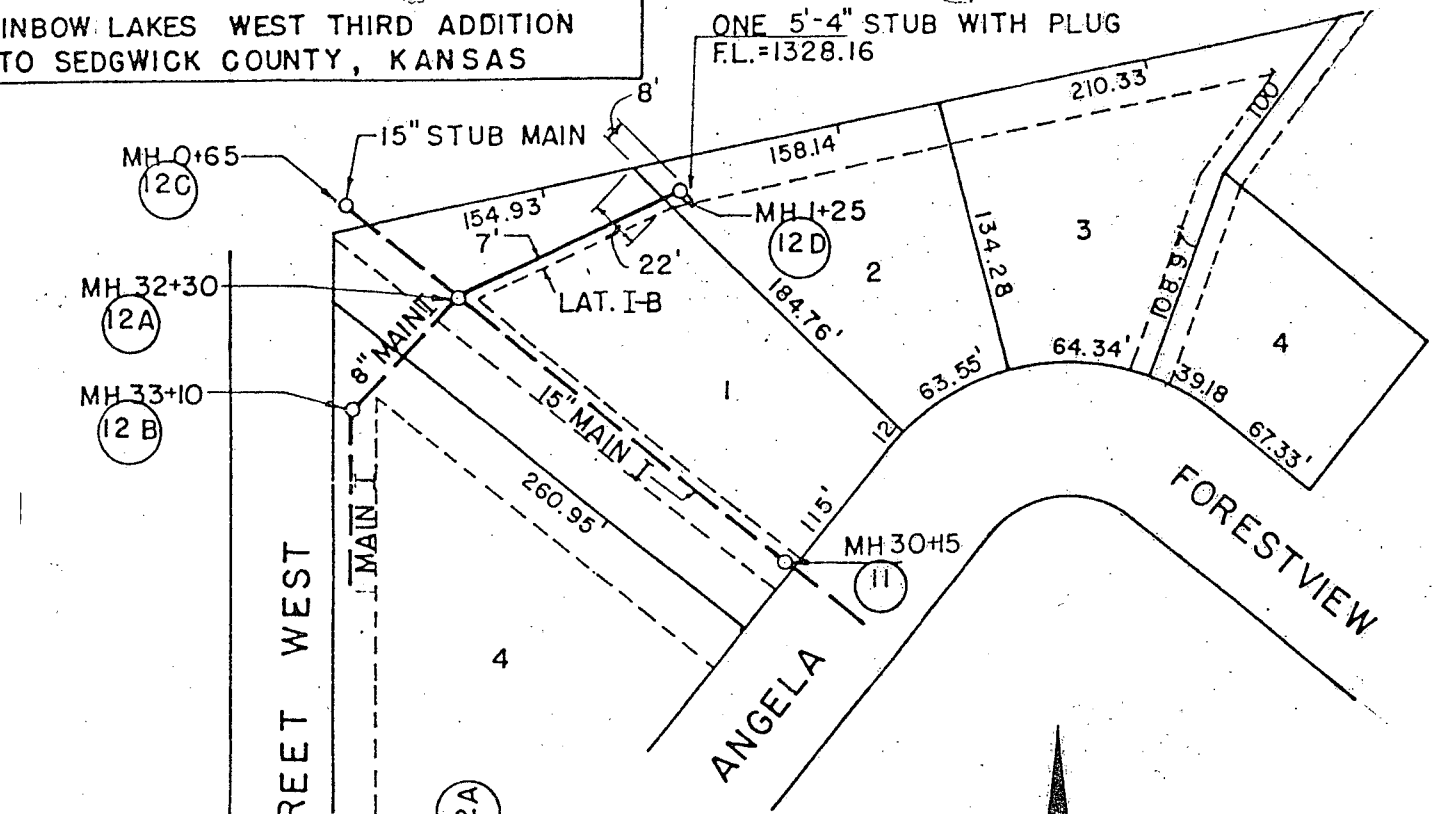

SCALE:  
 PLAN: LAT. & LONG. — 1" = 100'  
 PROFILE: HORIZ. — 1" = 100'  
 VERT. — 1" = 4'

ALL PIPE TO BE 8"

**REISS & GOODNESS ENGINEERS**

2160 WEST 21<sup>ST</sup> STREET  
 WICHITA, KANSAS 67204  
 (316) 832-0213



# THE CITY OF WICHITA



DEPARTMENT OF ENGINEERING  
CITY HALL — SEVENTH FLOOR  
455 NORTH MAIN STREET  
WICHITA, KANSAS 67202  
(316) 268-4501

May 22, 1981

Mr. Joe D. Freeman, P.E.  
Deputy Director of Public Works  
Sedgwick County Dept. of Public Works  
1015 Stillwell  
Wichita, KS 67213

Dear Mr. Freeman:

Subject: Generator Unit Submittal - Rainbow Lakes West 3rd

I have reviewed the above proposed submittal and note the following:

1. The submittal seems to provide a gasoline engine powered unit instead of natural gas as required by specifications.
2. The proposed weather-protective housing does not appear to conform to specification requirements. It appears the specifications require a partially buried enclosure such as the Power-Pac Series 2000 as manufactured by Stannard Power or an approved equal.
3. The specifications also require various accessory equipment. I am not able to ascertain from this submittal whether or not all of the required accessory equipment is included.

Please contact me if you have any questions.

Very truly yours,

Donald E. Schneider, P.E.  
Sanitary Engineer

DES/dla

cc: Paul B. Graves, Chief Engineer

# THE CITY OF WICHITA



DEPARTMENT OF ENGINEERING  
CITY HALL — SEVENTH FLOOR  
455 NORTH MAIN STREET  
WICHITA, KANSAS 67202  
(316) 268-4501

April 28, 1981

Mr. Maurice E. Dingler, P.E.  
Reiss & Goodness Engineers  
2160 West 21st Street  
Wichita, KS 67203

Dear Mr. Dingler:

Subject: Rainbow Lakes West Third Sanitary Sewer System

I received the prints of the revised plan sheets for the field change on the above noted project.

We need reproducible sheets of these revised prints so they can be inserted in the plan in our permanent file.

Very truly yours,

Donald E. Schneider, P.E.  
Sanitary Engineer

DES/dla

cc: Paul B. Graves, Chief Engineer

# THE CITY OF WICHITA



DEPARTMENT OF ENGINEERING  
CITY HALL — SEVENTH FLOOR  
455 NORTH MAIN STREET  
WICHITA, KANSAS 67202  
(316) 268-4501

January 29, 1981

Mr. Al Reiss, P.E.  
Reiss & Goodness  
Consulting Engineers  
2160 West 21st Street  
Wichita, KS 67203

Dear Mr. Reiss:

Subject: Sanitary Sewer for Rainbow Lakes West Third

I reviewed a sanitary sewer plan recently for a single family residential development which was prepared by a consulting engineer. The profile on this plan specified top of manhole elevations to the nearest one hundredth of a foot. I assumed, during my review of the plans, that since the tops of manhole elevations were specified to the nearest one hundredth the consultant had made an in-depth study of the finished grades in the plat and had set tops of manholes accordingly. Now that the project has been completed and the area has been partially graded to finished grade it is obvious that my earlier assumption was not correct. Very few of the manholes match the grading as completed and most manholes are 6" to 4' too low.

My concern presently, however, is top of manhole elevations in Rainbow Lakes West Third. I noted that your plan for the sanitary sewer construction in this area also called out top of manhole elevations on the profile to hundredths of a foot and when I reviewed the plan I made the same assumption as on the other project.

Should my assumption be correct, we should not have a problem. However, if my assumption is not correct, we could have a significant problem. Obviously it is very expensive to go back later and adjust a large number of manholes to match an established finished grade.

I realize it is sometimes very difficult to know what elevation to set tops of manholes to, but we always anticipate that it has been done in accordance with the best information available. Obviously the elevations of manhole tops constructed in close proximity of proposed streets will be controlled by the street elevation.

# THE CITY OF WICHITA

Al Reiss, P.E.  
Page 2  
January 29, 1981

Please advise me as to what basis was used to establish tops of manhole elevations for the proposed construction of sanitary sewers in Rainbow Lakes West Third Addition.

Very truly yours,

Donald E. Schneider, P.E.  
Sanitary Engineer

DES/dla

cc: Paul B. Graves, Chief Engineer

# THE CITY OF WICHITA



DEPARTMENT OF ENGINEERING  
CITY HALL — SEVENTH FLOOR  
455 NORTH MAIN STREET  
WICHITA, KANSAS 67202  
(316) 268-4501

January 29, 1981

Mr. Al Reiss, P.E.  
Reiss & Goodness  
Consulting Engineers  
2160 West 21st Street  
Wichita, KS 67203

Dear Mr. Reiss:

Subject: Sanitary Sewer for Rainbow Lakes West Third

I reviewed a sanitary sewer plan recently for a single family residential development which was prepared by a consulting engineer. The profile on this plan specified top of manhole elevations to the nearest one hundredth of a foot. I assumed, during my review of the plans, that since the tops of manhole elevations were specified to the nearest one hundredth the consultant had made an in-depth study of the finished grades in the plat and had set tops of manholes accordingly. Now that the project has been completed and the area has been partially graded to finished grade it is obvious that my earlier assumption was not correct. Very few of the manholes match the grading as completed and most manholes are 6" to 4' too low.

My concern presently, however, is top of manhole elevations in Rainbow Lakes West Third. I noted that your plan for the sanitary sewer construction in this area also called out top of manhole elevations on the profile to hundredths of a foot and when I reviewed the plan I made the same assumption as on the other project.

Should my assumption be correct, we should not have a problem. However, if my assumption is not correct, we could have a significant problem. Obviously it is very expensive to go back later and adjust a large number of manholes to match an established finished grade.

I realize it is sometimes very difficult to know what elevation to set tops of manholes to, but we always anticipate that it has been done in accordance with the best information available. Obviously the elevations of manhole tops constructed in close proximity of proposed streets will be controlled by the street elevation.

F  
SAN SEWER

# THE CITY OF WICHITA

Al Reiss, P.E.  
Page 2  
January 29, 1981

Please advise me as to what basis was used to establish tops of manhole elevations for the proposed construction of sanitary sewers in Rainbow Lakes West Third Addition.

Very truly yours,

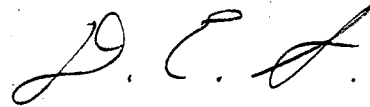

Donald E. Schneider, P.E.  
Sanitary Engineer

DES/dla

cc: Paul B. Graves, Chief Engineer ✓

# THE CITY OF WICHITA



DEPARTMENT OF ENGINEERING  
CITY HALL — SEVENTH FLOOR  
455 NORTH MAIN STREET  
WICHITA, KANSAS 67202  
(316) 268-4501

January 29, 1981

Mr. Mike Thompson, P.E.  
Poe & Associates, Inc.  
Consulting Engineers  
1720 East Morris  
Wichita, KS 67211

Dear Mr. Thompson:

Subject: Sanitary Sewer Construction - Lisa Cole Addition

Sometime back I reviewed a plan prepared by your firm for construction of sanitary sewer in the above noted addition. These plans indicated top of manhole elevations to hundredths of a foot. I assumed that your firm had made an in-depth study of what these elevations should be and had specified them accordingly.

This project is now constructed and the area is partially graded to finished grade. It has been called to my attention now that very few of the manhole tops come close to being where they need to be to match the finished grade as now indicated by the partially graded site. One location in particular has a manhole approximately 20' $\pm$  from a paved street, but yet the top of the manhole is approximately 2.5' $\pm$  below the top of curb of the street and 6' $\pm$  below the present ground elevation which has been established at the manhole.

My purpose now is to bring this to your attention so that some procedure can be adopted to minimize these happenings in the future. Obviously it is very expensive to adjust manhole tops to a new elevation after they are constructed.

I am curious as to what basis your firm used on this project to establish top of manhole elevations and I would like to discuss this subject with you personally at your convenience.

Very truly yours,

Donald E. Schneider, P.E.  
Sanitary Engineer

DES/dla

cc: Paul B. Graves, Chief Engineer X

# THE CITY OF WICHITA



DEPARTMENT OF ENGINEERING  
CITY HALL — SEVENTH FLOOR  
455 NORTH MAIN STREET  
WICHITA, KANSAS 67202  
(316) 268-4501

December 2, 1980

Mr. W. C. Payne, P.E.  
Chief Engineer  
Sedgwick County Dept. of Public Works  
1015 Stillwell  
Wichita, KS 67213

Dear Mr. Payne:

Subject: Rainbow Lakes Third Addition Sanitary Sewer Improvements

I have reviewed the latest copy of the specifications and my comments are as follows:

- 1.) Bid Schedule Item No. 5 indicates manholes will be paid for by the lineal foot. Plan Sheet #10 (Brick Manhole Details) indicates pay item will be per each manhole constructed for the various types specified. Section 18 of the specifications (Manholes - Type "C") also indicates the pay item will be per each Type "C" Manhole constructed.
- 2.) It appears to me that Bid Schedule Item No. 15 should be shown as lineal feet of 4" Riser Pipe.
- 3.) It appears to me that Bid Schedule Item No. 19 (Wet Well for Pumping Station) should be deleted from this contract and included in the contract for construction of the lift station and force main. This is only a recommendation which might eliminate subsequent problems.
- 4.) Vertical Riser Detail Plan Sheet No. 13 indicates that installation of risers will be paid for at the unit price bid for the 4" or 6" pipe and reinforced concrete encasement for the various main sewer pipe sizes indicated. This note requires a reinforced concrete encasement bid item for each size of main line sewer pipe where risers might be required.

The specifications have our approval except as noted above. Please contact me if you have any questions.

Very truly yours,

Donald E. Schneider, P.E.  
Sanitary Engineer

DES/dla

# THE CITY OF WICHITA



## DEPARTMENT OF PUBLIC WORKS

ENGINEERING DIVISION  
CITY HALL — SEVENTH FLOOR  
455 NORTH MAIN STREET  
WICHITA, KANSAS 67202  
(316) 268-4501

November 18, 1980

Mr. W.C. Payne, P.E.  
Chief Engineer  
Sedgwick County Dept. of Public Works  
1015 Stillwell  
Wichita, KS 67213

Dear Mr. Payne:

Subject: Rainbow Lakes III Addition Sanitary Sewer Improvements

We see no problem with letting the contracts for the above noted project in phases for the collection system and the pumping system. We anticipate that final plans on both phases will be submitted to us for approval prior to advertising for bids.

Very truly yours,

Donald E. Schneider, P.E.  
Sanitary Engineer

DES/dla

WICHITA — SEDGWICK COUNTY

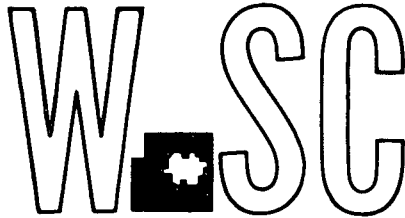

METROPOLITAN AREA PLANNING  
DEPARTMENT

CITY HALL — TENTH FLOOR  
455 NORTH MAIN STREET  
WICHITA, KANSAS 67202

1310 288-457  
**Dale Fair, Attorney**

**Page Court**

**Wichita, Kansas 67202**

May 8, 1979

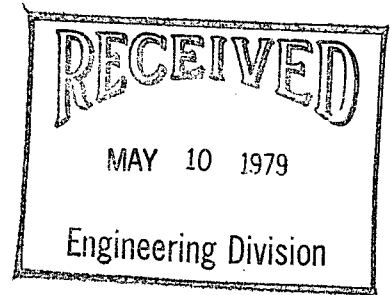

**SUBJECT: SD 77-108 and SD 78-61 - Rainbow Lakes Plats**

The Board of County Commissioners, at their meeting of May 2, approved paving petitions for certain of their Rainbow Lakes Plats. Specific information was never provided to me on this, so I am not sure whether this is the Rainbow Lakes West Fourth Addition or the Rainbow Lakes West Third Addition, or both. At the same time, the County Commission approved lateral sanitary sewer petitions for the same area. The approval was conditioned that no building permits were to be issued until the issue of where the sanitary sewer discharge is to be made.

At the meeting, Mr. Reiss submitted a cost-estimate for extending the sewer to the Frontier Land lagoons. This is an alternate, which if accepted, I believe must be concurred in by the Engineer for the City of Wichita; including Mr. Wynkoop and Mr. Linn (inasmuch as this will ultimately be in the Wichita system), as well as Mr. McClure, Mr. Aiken, and the State Department of Health and Environment (with Mr. Mel Gray approving). As you are aware, the City Engineer had prepared other alternates for service for this area which seemed to him, to fit into a general plan to extend services in this area. None of these plans (Mr. Reiss's or Mr. Linn's) appear to have been detailed in any degree. We obviously have different opinions of two or more engineers on this issue.

Remembering that we still have to get a plat approved by of City Commissioners, and that recommendations from City department heads will be made to them at the time the plats are submitted. I would encourage you to have Mr. Reiss furnish his report entitled "Planning Report Rainbow Lakes

Page 2  
May 8, 1979  
Dale Fair

addition", dated April 25, 1979, to the above mentioned persons as well as this office. I would then encourage a meeting be called by your engineers with the above personnel and our office to see if we can resolve what alternate can be mutually agreed on by all in taking this plat forward for final approval.

At the Commission meeting of May 2, we were also informed that it was the plators intent to utilize individual water wells for water service to this area. Please be advised that the County Zoning Resolution contains a qualifying clause for the "AA" district for which your clients have applied, and that both water and sewer of a municipal type is required. I would also refer you to our plat approval letters for these additions in which municipal water service was a "condition" of plat approval. For this condition to be removed, it would be necessary for the City Commission to waive this requirement. Again, I am doubtful that departments involved, nor our department, will be supportive of waiving the water requirement for urban-type plats. If water is not extended into these areas for fire service and for local service at the time of development, it then begins to be very difficult to continue making overall system improvements, and to provide that service at a later date. I think it is important that everyone, when they go into urban development, provide the services at that time, and not defer those costs on future owners/ users of service.

I would strongly urge you to discuss this matter with the Director of Water and Water Pollution Control, as I am sure he will be wanting to make a specific recommendation on this item to the Board of City Commissioners.

Sincerely,



Robert A. Lakin  
Director of Planning

RAL:vn

cc: John Wynkoop, Director of Water and Water Pollution Control  
Ray Bruggeman, Director of Public Works, City of Wichita  
✓ Richard Linn, City Engineer, City of Wichita  
Jack H. Galbraith, Chief Planner, Current Plans Division, MAPD  
Willard L. Stockwell, Chief Planner, Advance Plans Division, MAPD  
John Fry, 332 Wheatland Place, 67235  
L. V. Bell, 360 North 135th Street West, 67235  
Adolf Reiss, Reiss & Goodness Engineers  
Grover McClure, Director of Public Works, Sedgwick County  
Theodore H. Hill, Sedgwick County Counselor



REISS & GOODNESS ENGINEERS  
2160 WEST 21<sup>ST</sup> STREET - WICHITA, KANSAS 67203 (316) 832-0213

April 30, 1979

Mr. Everett Patrick  
Commissioner - 3rd District  
525 N. Main  
Wichita, Kansas 67202

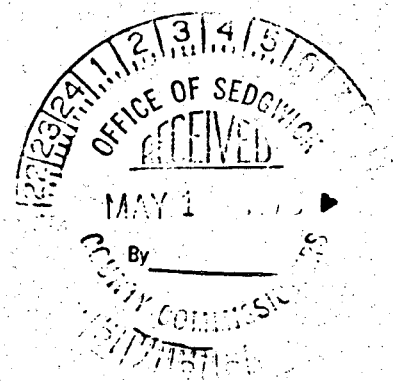

Re: Cost - Sedgwick County West Sewer District

Dear Mr. Patrick:

In line with the discussion that we had on the morning of April 27, 1979 the following cost estimates have been prepared by my office. We are suggesting to follow Alternate #1 as set out in the report entitled PLANNING REPORT RAINBOW LAKES ADDITION dated April 25, 1979.

The estimate of cost to serve Rainbow 3rd, 4th, and 5th Addition (1215 P.E.):

1	Unit	Pumping Station & 6" Force Main	\$ 60,000.00
1	Unit	Treatment Plant Modifications	22,000.00
		Estimated Construction Cost	<u>82,000.00</u>
		Engineering, Legal, & Misc.	<u>20,500.00</u>
		<b>TOTAL ESTIMATED COST</b>	<b>\$102,500.00</b>

To add Wheatridge Addition into the same plant (280 P.E.) the following estimate will apply:

1	Unit	Treatment Plant Modifications	\$ 6,000.00
---	------	-------------------------------	-------------

NOTE: This is the only additional cost incurred to enlarge the plant to pick up the necessary 280 additional population equivalent. However at this point there should be money set aside for enlargement of plant again at a future date so that everyone will participate equally in the plant cost. An additional cost to the Wheatridge Addition will be their own lateral sewer system and pumping station. Pumping Station with 4" Force Main would run \$26,000.00. If Wheatridge desires sewer in the future we will be glad to make up preliminary estimates.

I recommend this procedure as a step analysis progressively building up the basin until ultimately the City of Wichita will have built the main outfall sewer line so that all of this may drain into the main sewer plant for the City of Wichita.

Since  
REISS & GOODNESS ENGINEERS  
A. E. REISS P.E.

## METROPOLITAN AREA PLANNING DEPARTMENT

May 2, 1979

TO Board of County Commissioners

FROM Robert A. Lakin, Director of Planning

SUBJECT Re: Paving and Sewer Petition - Rainbow Lakes

Background

The Board of County Commissioners have received petitions for paving and sanitary sewer for plats in an area known as Rainbow Lakes. This is an area generally located east of 135th Street West and north of Maple. The plats are processing through MAPC and the Board of City Commissioners for approval. As a condition of approval, the owner of the plats must be able to guarantee the installation of sewer and municipal water. This can be accomplished by cash guarantee or a petition to a unit of general government.

Sewer Service on the Cowskin

Outlined in The Next Thirty Years was the general identification of sewer service within the Metropolitan Wichita area. Some areas were dealt with in more detail than others. As an example, the 4-mile Creek area was identified as an area which Sedgwick County would provide sewer service. Due to gravity flows and the existence of an initial pickup system, the Cowskin area was identified as being developed as a part of the Wichita system. This, however, is not as easy as it seems as there are existing developments with sewer (West Millbrook and Miles Westwind Lakes Estates); without sewer and needing sewer (C. Pate Wheatridge); and new areas desiring sewer service such as Murry's and Bell's. No detail work has been done on the development of a system. A number of organization alternates exist for bringing about the development of such a system. These include:

- 1) City of Wichita extension of service.
- 2) General Improvement Districts (such as West Millbrook).
- 3) County Sewer Districts with subsequent joint and lateral sewer districts therein.
- 4) Joint City and County Sewer District.

Bell Alternates

The change in City policy on outside utility service set aside the original plan to service the Bell and Murry

Page 2

May 2, 1979

Board of County Commissioners

Re: Paving & Sewer Petition-Rainbow Lakes

areas with connections to the City system. This plan was to tie into the Wichita system by building a permanent and temporary pipe in Maple eastward to soon to be laid sewer pipe. The City Engineer prepared a general layout for sewer service for what MAPD considered the developing area along the Cowskin. However, until some areas are annexed and others propose to develop, immediate construction was not considered practical. Accordingly, an interim solution was offered wherein some permanent line would be built in Maple along with temporary lines hooking back to the sewer at Maple and the Cowskin. The recent revision in City policy would now allow this to occur as originally proposed. I believe this solution was concurred in by both City and County staff. The only difference is that 100% of the cost of the sewer would now have to be paid by the plattor.

or

The Bell properties could tie into an existing plant, subject to:

- 1) Plant capacity existing.
- 2) Plant being capable of being modified to be able to accept the Addition.
- 3) The State and EPA granting approval.

or

Plants in the area which might be modified are the West Millbrook and/or Frontier Village facilities.

or

Another alternate would be to build a new facility either on-site or at some other site acceptable to the State, EPA, and the County. Both a new plant and the use of an existing plan (modified) should be considered temporary until the Sewer Plan is updated and a more detailed study of the Cowskin is made.

#### Water Extension

Currently, there is no public water supply in the area. The four alternates are:

- 1) Wichita extension of service. Lines will be extended to one-half mile of this site. Current policy based on 100% developer cost would make this alternate quite feasible.

May 2, 1979

Board of County Commissioners

Re: Paving & Sewer Petition-Rainbow Lakes

- 2) Goddard extension. Goddard water is one mile to the south. Capacity is limited without new wells. An existing agreement between Wichita and Goddard limits the extension of Goddard water in this area without consultation between the two governing bodies.
- 3) Creation of a County Water Department. This would necessitate the County obtaining water appropriation rights from the Chief Engineer, Division of Water Resources, Department of Agriculture. Involved would be all of the treatment, monitoring and testing of a public water supply under the Federal Clean Water Act.
- 4) Authorization of individual wells by the Health Department and the waiver of the public water supply requirement by the MAPC and the Board of City Commissioners.

#### Long Range Studies

It is believed all agree that additional long range studies need to be undertaken as to specific service needs for the urban growth area on the west side. The growth area for planning purposes (pro-rata of estimated future population assigned to geographical limits) is smaller than the natural gravity flow area. Also, some of this growth will occur in neighboring drainage basins. It is recommended that the work item in MAPD's work program be initiated as soon as money is available.

McLure and Wynkoop have indicated money is available. Possible EPA grants are also available to assist. If agreed by the governing bodies, an overall update of the Sewer Plan (Countywide) should be undertaken. Examined would be the needs of the City and the County; need and location for new lines, treatment needs, location for treatment facilities and assessment of new technology likely to be available in the next 20-30 years. This study would provide answers to existing capacity problems on the City's west side. As a sub-element, the Cowskin could be examined in greater detail much as the 4-Mile Creek is now being studied. The problems of temporary systems, phasing, and suggested cost allocation could be examined and alternatives provided.

May 2, 1979

Board of County Commissioners

Re: Paving & Sewer Petition-Rainbow Lakes

Short Term Alternatives - Bell Properties

Based on the revised City water (and sewer) extension policy, it is strongly urged that the plat be submitted to the City with:

- 1) Request for outside water and sewer service.
- 2) Petition for water and sewer laterals under KSA 12-6a01 et. seq.
- 3) Guarantees other than petitions for any temporary lines.

or

Another alternate would follow the model established by the County in Park Meadows Addition, and:

- 1) Have the developer provide pre-engineering as to treatment type and location with preliminary estimates for plant construction and for O&M costs.
- 2) Provide, at the time of approval, fiscal guarantees other than special assessments for plant construction.
- 3) Provide water services as outlined in the preceeding report.
- 4) Receive and file the sewer petition and return for action with the information obtained in item 1.

or

- 1) Approve and file the petitions and instruct the Director of Public Works to proceed to determine how to serve the area.

In any event, the Commission should authorize MAPD to prepare preliminary scope of services for the updating of the areawide sewer plan, to submit estimated funding requirements and return to both governing bodies for concurrence and authorization to request either funding assistance from EPA or solicit requests for proposals from consultants to perform the work.



Robert A. Lakin  
Director of Planning

Page 5

May 2, 1979

Board of County Commissioners

Re: Paving & Sewer Petition-Rainbow Lakes

cc: Ted Hill, County Counselor  
Grover McLure, Director County Public Works  
L.U. Bell, 360 N. 135th St. West 67207  
Al Reiss, Reiss & Goodness Engineers, 2160 W. 21st 67203  
Jim Aiken, Director Environmental Health  
John Wynkoop, Director, Water Department

Rainbow Lakes West 3<sup>rd</sup> Add'n

8/27/79

SWS at SE corner - 18" @ 1.6% is in error

only need .16% to carry 4.4 cfs

Should have enough drop to bring water from Linnel Circle to Box under Forest View.

Kenneth Hill of Reiss & Goodness 832-0213

1. The drainage plan is generally correct except some minor discrepancies in the amount of flow and pipe sizes.
2. There appears to be sufficient drop to bring the water from Linnel Circle directly to Box on Forest View & Maple
3. If storm water is not piped to Maple St., a drainage easement has to be obtained from property owner to the west. Also, a easement is required to the east all the way to the Box structure ~1090' east on Maple St.
4. The only storage capacity provided is the time of filling the lake from normal w.l. of 1320 to Design Water surface.
5. The improvement of down stream drainage from site to the Box structure in Maple should be provided.



# KANSAS STATE BOARD OF AGRICULTURE

TOPEKA, KANSAS 66612

DIVISION OF WATER RESOURCES  
GUY E. GIBSON, Chief Engineer  
1720 SOUTH TOPEKA AVENUE  
TOPEKA, KANSAS 66612

W. W. DUITSMAN  
Secretary  
State Office Building

May 23, 1979

Mr. John W. Fry, President  
Rainbow Lakes, Inc.  
322 Wheatland Place  
Wichita, Kansas 67212

Dear Mr. Fry:

Consideration has been given to your application for permit and approval of plans relating to your proposed site grading and channel change project, along a tributary of Cowskin Creek, at a location in the SW $\frac{1}{4}$  of Section 24, Township 27 South, Range 2 West, City of Wichita, Sedgwick County, Kansas.

In accordance with the provisions of K.S.A. 82a-301 to 305a, the Chief Engineer has approved the plans and issued the enclosed permit authorizing construction of the proposed channel change. In accordance with the provisions of K.S.A. 24-126, the Chief Engineer has approved the plans authorizing construction of the proposed site grading.

One set of the approved plans is enclosed. The second set will be retained in our files.

Very truly yours,

Keller Cordon  
Engineer

KC:srf  
Enclosure  
cc: Mr. A. E. Reiss

Flood Control

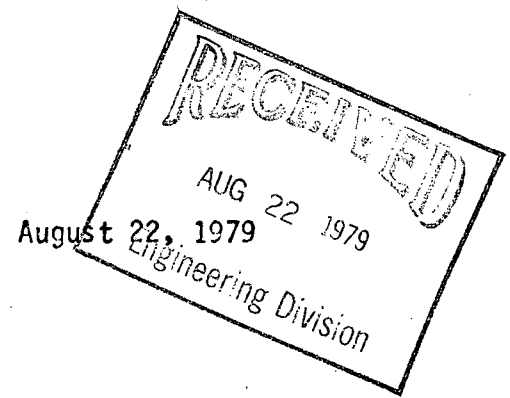

Louise Olivarez, Planning Department

Paul Johnston, Flood Control Engineer

Drainage Plan for Rainbow Lakes  
West 3rd - 135th and Maple

This is to inform you that we have reviewed the drainage system for Rainbow Lakes West 3rd and approve same in concurrence with the county subject to the following conditions being met:

1. The 90' right-of-way for the proposed channel on the north side of Maple shall be designated as additional road dedication.
2. A 90' easement shall be obtained from the property owner to the east along the north edge of Maple to the box structure under Maple.
3. Unless the storm water is directly piped to the structure north of Maple, a 30 foot easement will be required from the property owner to the west, same to be placed adjacent to but not within the existing Cities Service Pipeline Easement. This shall be designated reserve.
4. A Homeowners Association Agreement is required to insure maintenance on the lake and all reserves.
5. Guarantee the construction of or the costs associated with taking the drainage from the site to the box structure in Maple, same to be checked and approved by the county.
6. Review Design Water Surface in the lake to insure adequate minimum pad elevations being established if necessary.
7. Written approval from Cities Service approving proposed crossings based on actual layout of plat and guarantee the cost of any required encasement be borne by the developer.

Paul Johnston  
Flood Control Engineer

gc

cc: Rainbow Lakes West 3rd Addn. Plat File  
Kenny Hill/ Reiss & Goodness  
Yash Desai/Eng. ✓  
Phil Dietrich, Sedgwick County Engineers Office

THE CITY OF WICHITA

OFFICE OF ENGINEERING

DATE JUNE 20, 1979

TO DONALD C. GISICK, CITY CLERK

FROM YASH D. DESAI, DRAINAGE CHIEF ENGINEER

SUBJECT RAINBOW LAKES ADDITION PLAT

Please find attached State approved plans of Rainbow Lakes for Rainbow Lakes Addition Plat to be filed and recorded.

---

Yash D. Desai  
Drainage Chief Engineer

YDD/dla

Attachment



# KANSAS STATE BOARD OF AGRICULTURE

DIVISION OF WATER RESOURCES  
GUY E. GIBSON, Chief Engineer  
1720 SOUTH TOPEKA AVENUE  
TOPEKA, KANSAS 66612

W. W. DUITSMAN  
Secretary  
503 Kansas Avenue  
TOPEKA, KANSAS 66603

May 23, 1979

Mr. John W. Fry, President  
Rainbow Lakes, Inc.  
322 Wheatland Place  
Wichita, Kansas 67212

Dear Mr. Fry:

Consideration has been given to your application for permit and approval of plans relating to your proposed site grading and channel change project, along a tributary of Cowskin Creek, at a location in the SW $\frac{1}{4}$  of Section 24, Township 27 South, Range 2 West, City of Wichita, Sedgwick County, Kansas.

In accordance with the provisions of K.S.A. 82a-301 to 305a, the Chief Engineer has approved the plans and issued the enclosed permit authorizing construction of the proposed channel change. In accordance with the provisions of K.S.A. 24-126, the Chief Engineer has approved the plans authorizing construction of the proposed site grading.

One set of the approved plans is enclosed. The second set will be retained in our files.

Very truly yours,

*Keller Cordon*  
Keller Cordon  
Engineer

KC:srf  
Enclosure  
cc: Mr. A. E. Reiss