

**DRAINAGE CONCEPT
QUICKTRIP 7th ADDITION
WICHITA, SEDGWICK COUNTY, KANSAS**

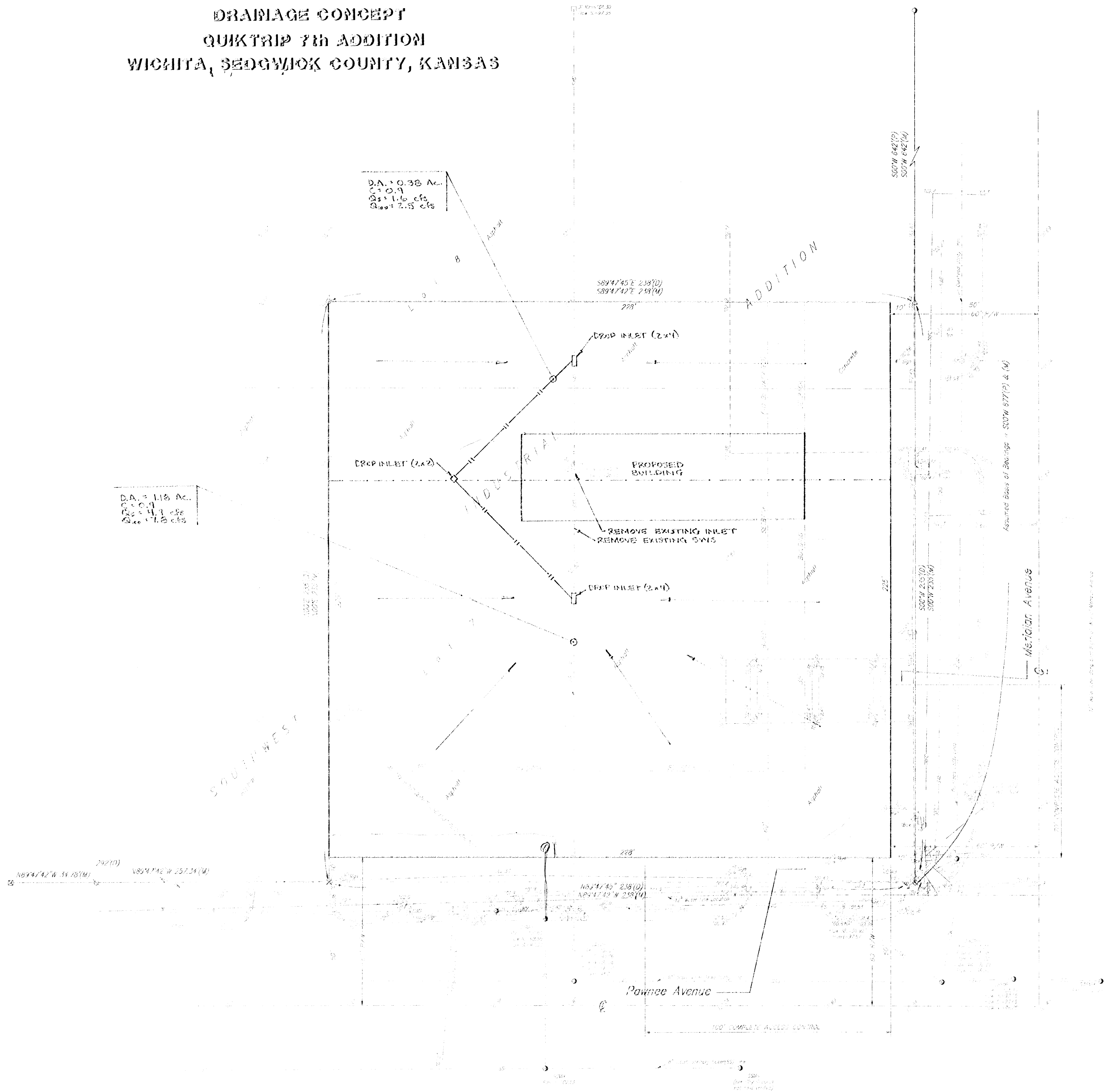

D.A. = 0.38 Ac.
C = 0.9
Q_s = 1.4 cfs
Q₁₀₀ = 2.5 cfs

D.A. = 1.18 Ac.
C = 0.9
Q_s = 1.1 cfs
Q₁₀₀ = 1.8 cfs

- LEGEND**
- Proposed Building
 - Proposed Drainage
 - Proposed Inlet
 - Proposed Street
 - Proposed Sidewalk
 - Proposed Utility
 - Proposed Easement
 - Proposed Right-of-Way
 - Proposed Access Control
 - Proposed Survey
 - Proposed Elevation
 - Proposed Slope
 - Proposed Area
 - Proposed Volume
 - Proposed Weight
 - Proposed Length
 - Proposed Width
 - Proposed Height
 - Proposed Depth
 - Proposed Diameter
 - Proposed Radius
 - Proposed Circumference
 - Proposed Area
 - Proposed Volume
 - Proposed Weight
 - Proposed Length
 - Proposed Width
 - Proposed Height
 - Proposed Depth
 - Proposed Diameter
 - Proposed Radius
 - Proposed Circumference

NOTES

1. All dimensions are in feet unless otherwise noted.
2. All bearings are true bearings unless otherwise noted.
3. All distances are in feet unless otherwise noted.
4. All areas are in acres unless otherwise noted.
5. All volumes are in cubic feet unless otherwise noted.
6. All weights are in pounds unless otherwise noted.
7. All lengths are in feet unless otherwise noted.
8. All widths are in feet unless otherwise noted.
9. All heights are in feet unless otherwise noted.
10. All depths are in feet unless otherwise noted.
11. All diameters are in feet unless otherwise noted.
12. All radii are in feet unless otherwise noted.
13. All circumferences are in feet unless otherwise noted.
14. All areas are in acres unless otherwise noted.
15. All volumes are in cubic feet unless otherwise noted.
16. All weights are in pounds unless otherwise noted.
17. All lengths are in feet unless otherwise noted.
18. All widths are in feet unless otherwise noted.
19. All heights are in feet unless otherwise noted.
20. All depths are in feet unless otherwise noted.
21. All diameters are in feet unless otherwise noted.
22. All radii are in feet unless otherwise noted.
23. All circumferences are in feet unless otherwise noted.

