

Site in South face of power pole of center of Dugan on North side of 76th.  
 Site in East face of power pole 850.0 ft. North of the North Line of 76th on the West side of Maple Lane.  
 1. Disc 33.7 ft. West and 34.3 ft. South of Quarter Section Corner of Dugan Road and Maple Street.

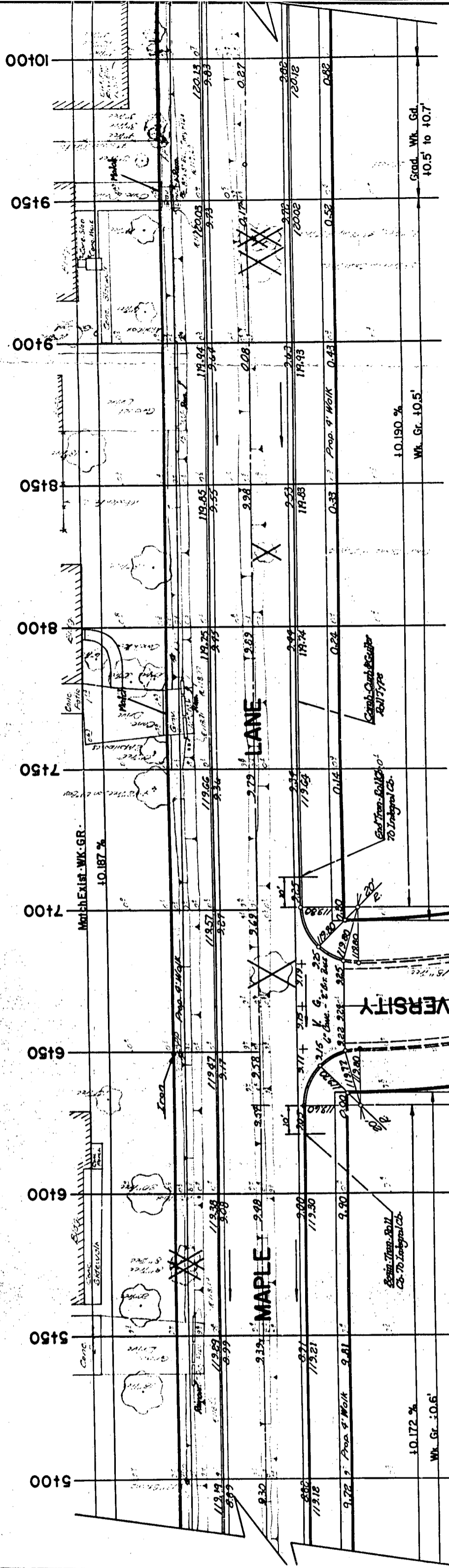

Note: Sidewalk Construction By Others

INTERSECTION QUANTITIES

64.7 S.Y.	Concrete Pavement
64.7 S.Y.	Asphaltic Conc. Pavement (6" Bituminous Base)
S.Y.	Bituminous Base
42.6 L.F.	Combined Curb & Gutter
42.6 L.F.	Integral Curb
S.F.	4" Wheelchair Ramp
S.F.	4" Walk
64.6 C.Y.	Excavation
64.6 C.Y.	Compacted Fill
71.9 Lbs.	Reinforcing Steel
S.Y.	Manipulation
Tons	Lime or Cement
64.9 S.Y.	V.G. Concrete & Asphaltic Concrete Base

S.L. Maple  
 972-76-295