

**PRELIMINARY PLAT  
OF  
PRAY - WOODMAN ADDITION  
SEDCWICK COUNTY, KANSAS**

U.S.D. # 266, Maize, Ks. - Owner / Subdivider

**LEGAL DESCRIPTION**

SW 1/4, SEC. 19, T.26S., R.1W. OF THE  
6TH P.M., SEDGWICK COUNTY, KANSAS,  
EXCEPT BEGINNING AT A POINT 179' SOUTH  
& 20' EAST OF THE NW CORNER OF SAID 1/4  
SECTION, THENCE EAST 35' TO A POINT,  
THENCE SOUTH 25' TO A POINT, THENCE  
WEST 35' TO A POINT, THENCE NORTH 25'  
TO THE POINT OF BEGINNING.  
  
(154.47 Ac. ±)

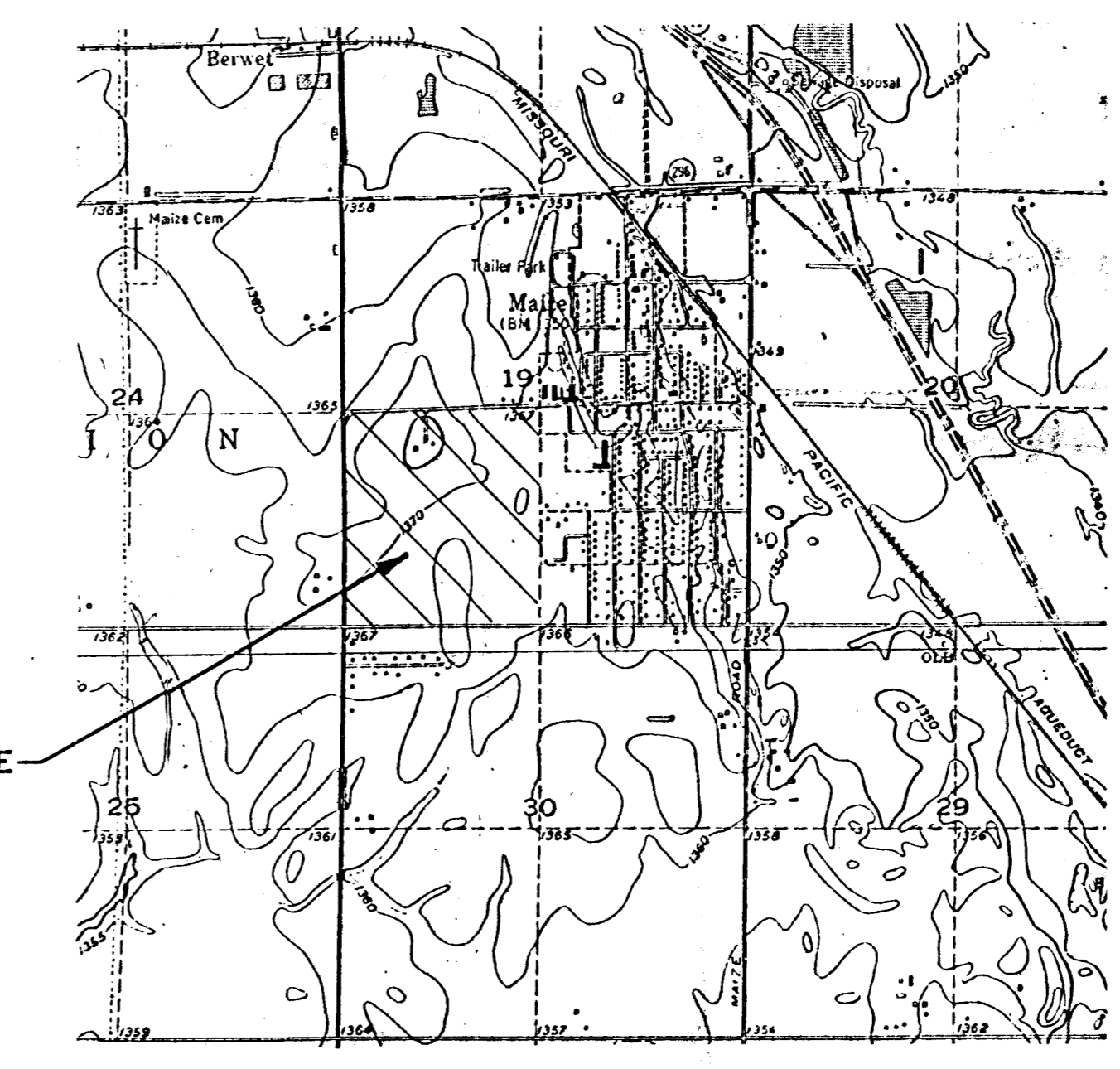

VICINITY MAP

Topographic Survey  
July, 1993.

- BENCHMARKS -**
- 60 d spike in utility pole, approx. 650' W. & 25' N. of NE Cor., SW 1/4 Sec. 19-26-1W. Elev. = 1367.36 M.S.L.
  - Spike step in telephone pole, approx. 100' W. & 20' N. of SE Cor., SW 1/4, Sec. 19-26-1W. Elev. = 1366.81 M.S.L.
  - R.R. spike in utility pole, SW Cor. of intersection of 119th St. West & 45th St. N. Elev. = 1366.71 M.S.L.

NOTE -  
C.A.C. = COMPLETE ACCESS CONTROL

**MOHRING & ASSOCIATES  
CONSULTING ENGINEERS  
WICHITA**  
AUGUST, 1993  
Revised Sept. 29, 1993  
Revised Oct. 27, 1993

