

PROJECT: Letters of Credit

Woodcrest

PROJECT #:

DATE: 01/08/87

TO: Ritchie Associates
8100 E. 22nd St. North
Building #500
Wichita, KS 67226

ATTN: Jack Ritchie

MID-KANSAS ENGINEERING
CONSULTANTS, P.A.
3500 N. Rock Road, #800
Wichita, KS 67226

The following project names and numbers are listed with the required letter of credit amount:

Sanitary Sewer Lateral 5, Main 24, W.I.S.
C.O.W. Project No. 468-76-245-81657-000-000-001
L.O.C. = \$50,400.00

Water Main
C.O.W. Project No. 448-76-245-88179-000-000-001
L.O.C. = \$28,350.00

Storm Water Sewer No. 330
C.O.W. Project No. 468-76-245-81658-000-000-001
L.O.C. = \$34,125.00

Pavement
C.O.W. Project No. 472-76-245-81624-000-000-001
L.O.C. = \$128,100.00

MID-KANSAS ENGINEERING CONSULTANTS, P.A.

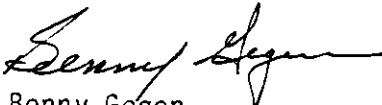
Benny Gegen

BG/dm

cc: Kevin Mullen

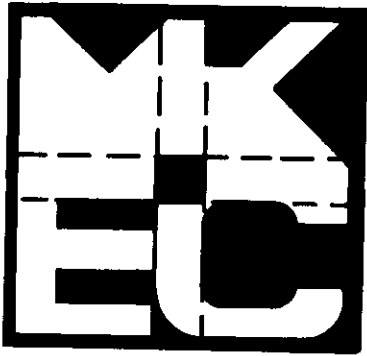

LETTER OF TRANSMITTAL

PROJECT: Woodcrest Addition

PROJECT #: _____ DATE: 02/19/87

MID-KANSAS ENGINEERING
CONSULTANTS, P.A.
3500 N. Rock Road, #800
Wichita, KS 67226

TO: Mr. Bill Morris
Engineering Department
455 N. Main, 7th Floor
Wichita, KS 67202

We are sending the following items: Attached
 Under separate cover via _____

Prints Specifications Legal Descriptions
 Tracings Petitions Correspondence Other

COMMENTS: Transmitted herewith are the Affidavits for the paving, storm sewer, sanitary sewer and water mains for the above referenced project.

For Your Approval As Requested
 For Your Use For Your Files
 Approved as Noted For Review and Comment

REMARKS:

Signed: Benny Gegen
Benny Gegen

BG/dh

cc: Kevin Mullen

TSM all

Carl *CHL*

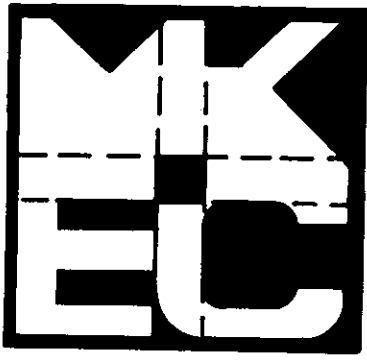

**MID-KANSAS ENGINEERING
CONSULTANTS, P.A.**
3500 N. Rock Road, #800
Wichita, KS 67226

PROJECT: Sidewalks within Lakepoint

PROJECT #: _____ DATE: 04/17/87

TO: Mr. Michael E. Lindebak
Engineering Department
455 N. Main, 7th Floor
Wichita, KS 67202

Per our meeting of Friday, April 10, 1987 it is our understanding that side-walks within the Lakepoint Development can be handled as shown on the enclosed exhibit.

We will work with Mr. Carl Gipson in amending the filed petitions to reflect the conclusions reached.

Your assistance in this matter is appreciated.

MID-KANSAS ENGINEERING CONSULTANTS, P.A.

Kenneth H. Bengtson

Kenneth H. Bengtson, P.E.

KHB/dh

cc: Jack Ritchie
Dave Ritchie
Jack Galbraith
Carl Gipson



*File in
Woodcrest
Plot Folder*

April 5, 1988

Ritchie Paving, Inc.
P.O. Box 8901
Wichita, KS 67208

ATTENTION STEVE ANDERSON

Gentlemen:

Subject: Woodcrest Addition
472-76-245-81624
Ritchie Job #33371

I am in receipt of your March 28, 1988, letter requesting additional payment for work done on the referenced project.

The removal of the temporary roadway is covered by General Note No. 11, and no additional payment will be made for this work.

The realignment of the 8' walk was done at the special request of the developer. The City will pay the overrun in quantities at the unit prices bid. Any additional costs encountered due to the realignment should be addressed to the developer, Mr. Jack Ritchie.

Concerning your request for payment for overhaul, the City did not designate a disposal site, and you were allowed to dispose of the dirt at any suitable site of your choosing. Since the City did not direct the waste to be overhauled, no payment will be made for overhaul.

Review of the working days charged on this project should be addressed to Jim Armour, Construction Engineer.

Sincerely,



Larry D. Henry, P.E.
Assistant City Engineer

/dlp

cc: Mike Lindebak, P.E., City Engineer
Jim Armour, P.E., Construction Engineer
Jack Ritchie

- WALK WITHIN WOODLANDS ESTATES CONTRACT
- ===== WALK WITHIN GATEWOOD CONTRACT
- ==== WALK WITHIN AUTUMN CHASE
- WALK WITHIN WOODCREST

LEGEND

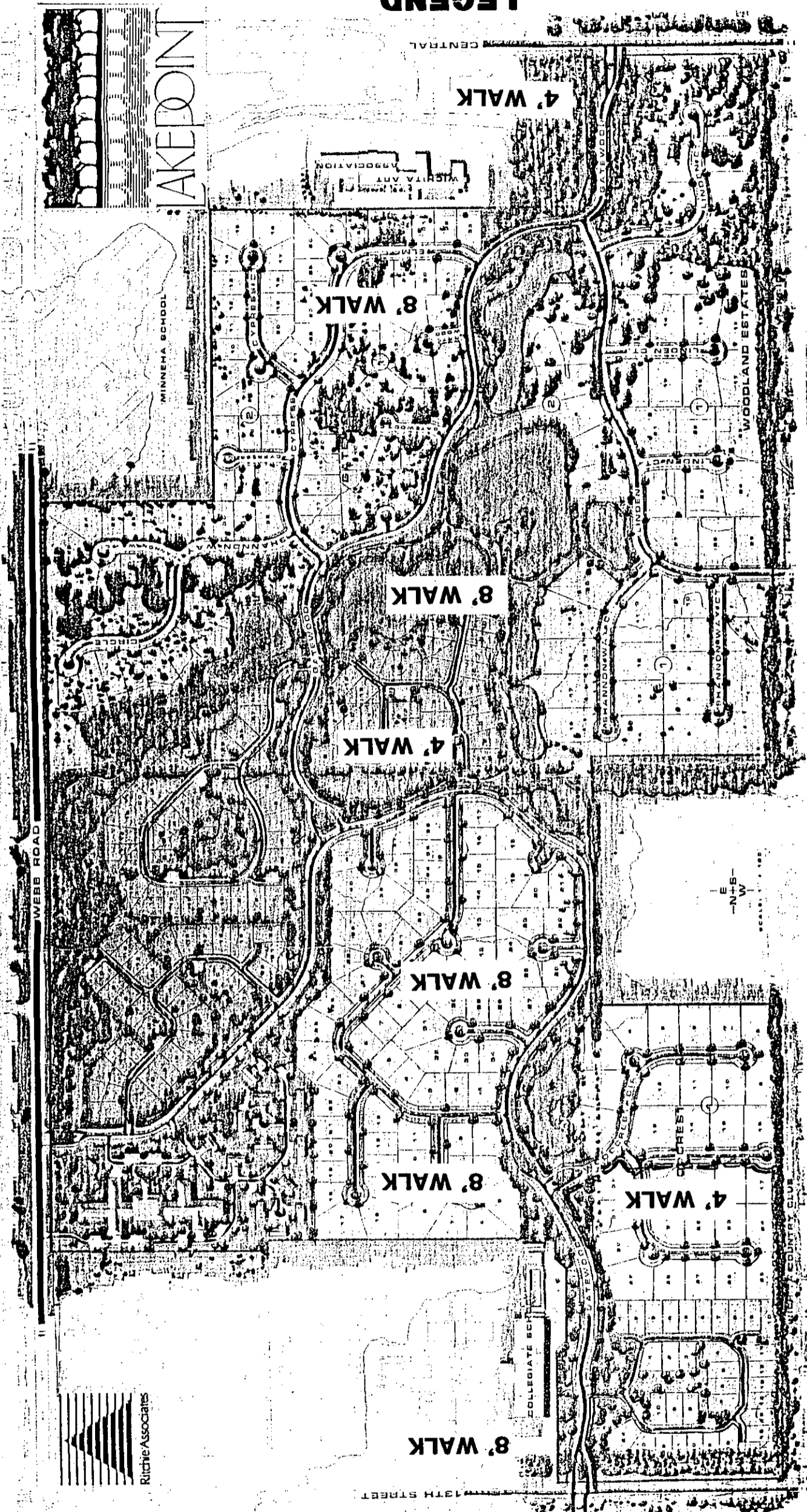

Richie Associates