

S.W. COR. S.E. 1/4 SEC. 14, T27N, R2E
CENTRAL AVE.
508.19'

SCALE: 1" = 100'
CONTOUR INTERVAL = 2'

N
W **E**
S

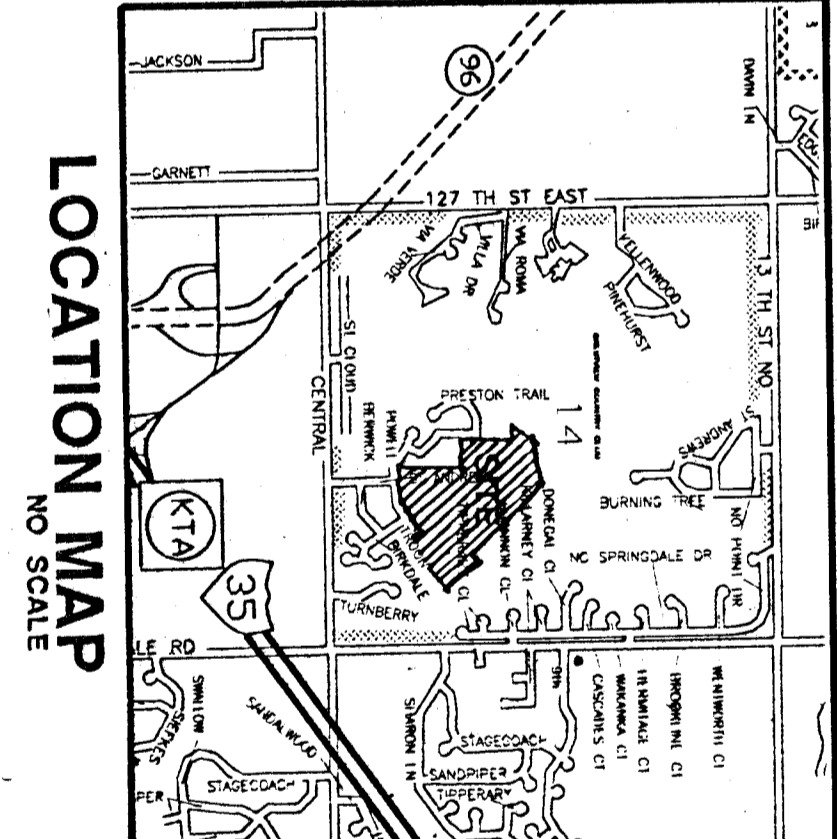

- LEGEND**
- Drainage Basin Boundary
 - Direction - Minor Storm
 - Pop. Storm Water Sewer Inlet
 - Drainage Direction - Major Storm

DRAINAGE CONCEPT 9-20-91

PROFESSIONAL ENGINEERING CONSULTANTS, P.A.		
ENGINEERS WICHITA, KANSAS		
Designed by <i>C. S. Brown</i>	Job No.	Sht. 1 of 1
Drawn by	Date 9-20-91	

THE PINNACLE AT CRESTVIEW

OWNER: RITHIE ASSOCIATES, 8100 E. 22ND ST. NORTH BLDG. 1000, WICHITA, KANSAS 67228 PH:316-684-7300

- NOTES:**
- 1) TOPOGRAPHY OBTAINED AUG. 10, 1991. 2' CONTOUR INTERVALS ARE BASED ON U.S.G.S. DATUM.
 - 2) DRAINAGE CONCEPT PLAN TO BE PREPARED BY P.E.C. AND SUBMITTED TO CITY ENGINEER.
 - 3) RESERVES A.B.C.E.A.F. TO PERMIT ENTRY MONUMENTS, GATES, ENTRY FEATURES, LANDSCAPING, WALKS, DRAINAGE AND UTILITIES CONNECTED TO ESMT'S. RESERVE "P" SHALL ALSO PERMIT ACCESS TO DRAINAGE STRUCTURES, LANDSCAPING, WALKS, GAZEBOS AND DRAINAGE AND UTILITIES CONNECTED TO EASEMENTS. RESERVE "G" TO PERMIT GOLF COURSE ACCESS DRIVE AND LANDSCAPING. RESERVE "E" SHALL ALSO PERMIT ACCESS TO LOTS 24 THRU 27.

SHEET
OF

PROJECT
THE PINNACLE AT CRESTVIEW

SHEET TITLE
PRELIMINARY PLAN

DATE
REV.

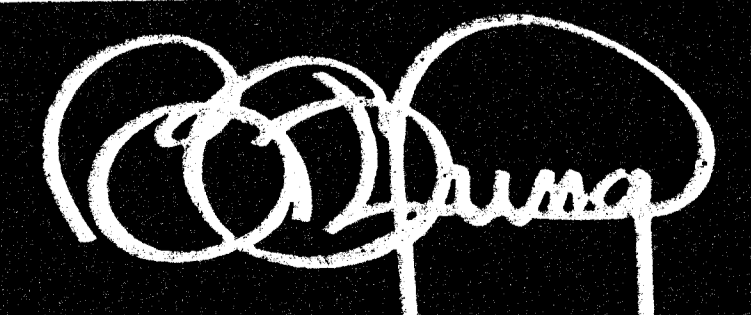

BILL G. YUNG DESIGN
4912 E. 29TH STREET NORTH WICHITA, KS. 67220
316-683-5587 FAX 316-683-9290