

N.E. Cor., Sec. 2,
T28S, R1E

SPENCER GARDENS DRAINAGE PLAN
March 6, 1979

1. Area adjacent to Drainage Dedication to be filled where necessary such that finished ground elevation is at least two feet (2') above Design Water Surface.
2. Lots 1, 2, and 4 to be drained by private storm sewer systems with one outlet per lot into the Drainage Dedication; private storm sewer systems to be approved by the Wichita City Engineer and the Wichita Valley Center Flood Control Office prior to issuance of building permits. Outlet to be located within pilot channel (see Design Channel Cross-Section) and shall include flared end-section.
3. Lot 5 shall be graded to drain to street gutter or existing storm water sewer via drives, flumes, private storm water sewer, and/or other approved drainage facilities; final drainage plan to be approved prior to issuance of building permit.
4. Lot 3 to drain to Drainage Dedication through Lot 4; the right of Lot 3 to drain through Lot 4 will be granted in the text to be shown on the face of the Final Plat.

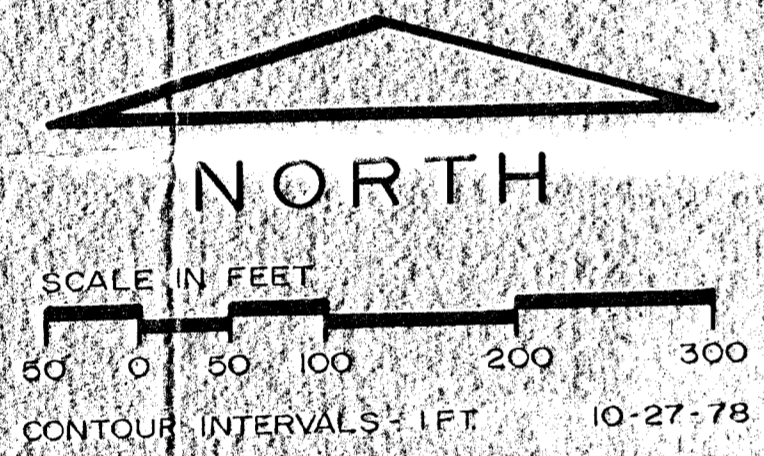

PRELIMINARY PLAT

SPENCER GARDENS

OWNER: Joseph L. Guyot
DEVELOPER: Spencer of Jackson Inc.
2601 S. Oliver, Wichita, Ks.

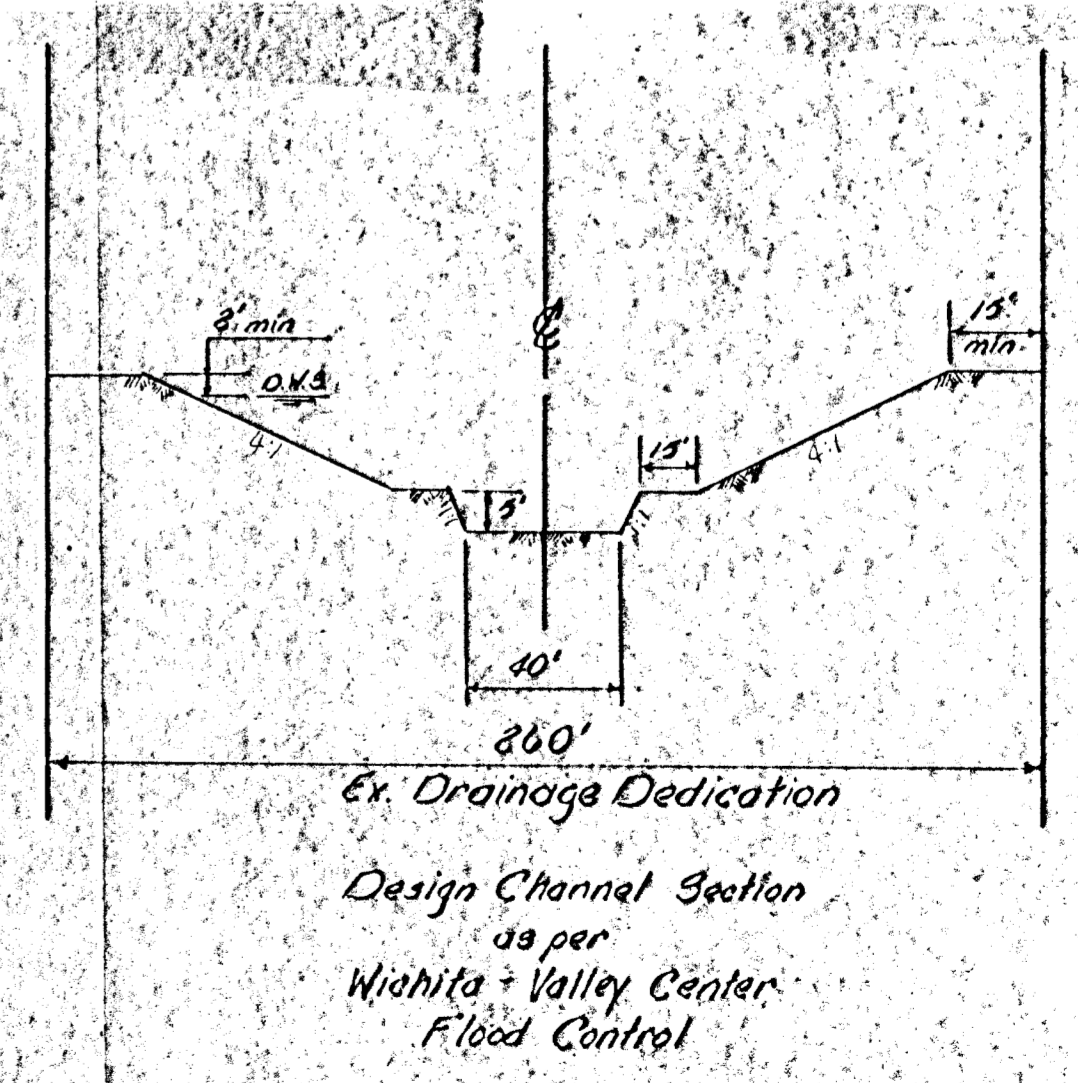
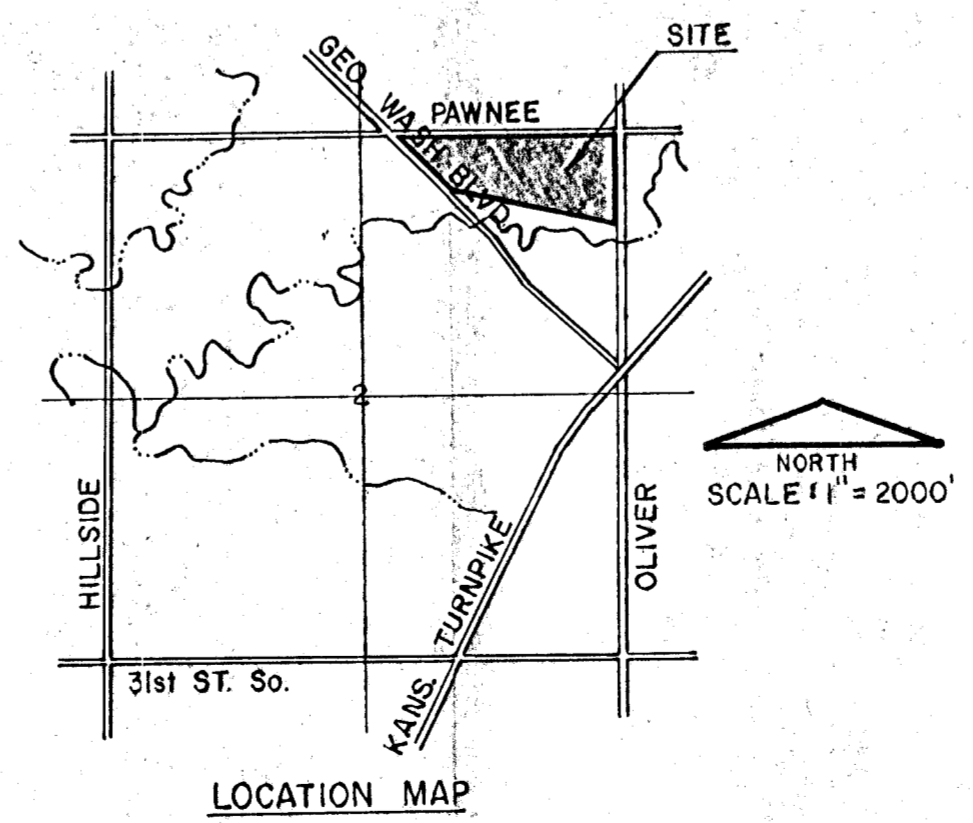

Oliver Bridge
E 96.00
DNB 110.60
Geo. Wash. Bridge
E 92.12
DNB 106.60

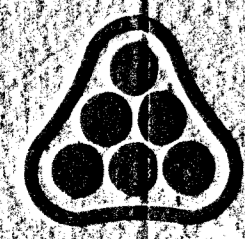

PROFESSIONAL ENGINEERING CONSULTANTS, P.A.
ENGINEERS
WICHITA, KANSAS