

UNPLATTED

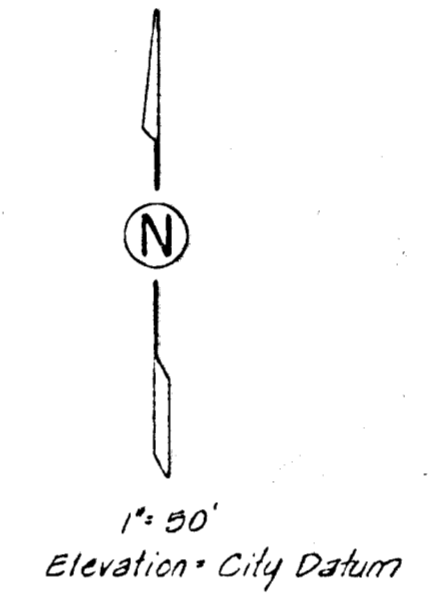

BENCH MARK:
 Broadway & 21st St: Brass rod in concrete
 post at North end and in traffic island N.E. Cor
 22 E. & 41.5 N. of thimble at intersection of
 Section Lines
 Elevation: 12471 City Datum

SKETCH PLAT
SUTHERLAND LUMBER NORTH

PART OF THE S 1/2 OF THE SW 1/4 OF THE SW 1/4 OF
 SEC. 4, TWP. 27-S, R-1-E

SUTHERLAND LUMBER, A KANSAS LIMITED PARTNERSHIP