



Scale: 1" = 60'

MINIMUM BUILDING PAD ELEVATIONS FOR LOWEST OPENING OF STRUCTURE

Lot & Block	Elevation	
	City Datum	M.S.L.
1 - BLK A	141.6	132.0

- = 1/2" REBAR W/ "BAUGHMAN" CAP (FOUND)
- = 1/2" REBAR W/ "BAUGHMAN" CAP (SET)

NOTE: For additional building setbacks see associated C.U.P. DP-134

BENCH MARK: City disc located on the N.E. Corner of Central and Moize in Island. Elev. = 146.00 (city datum)

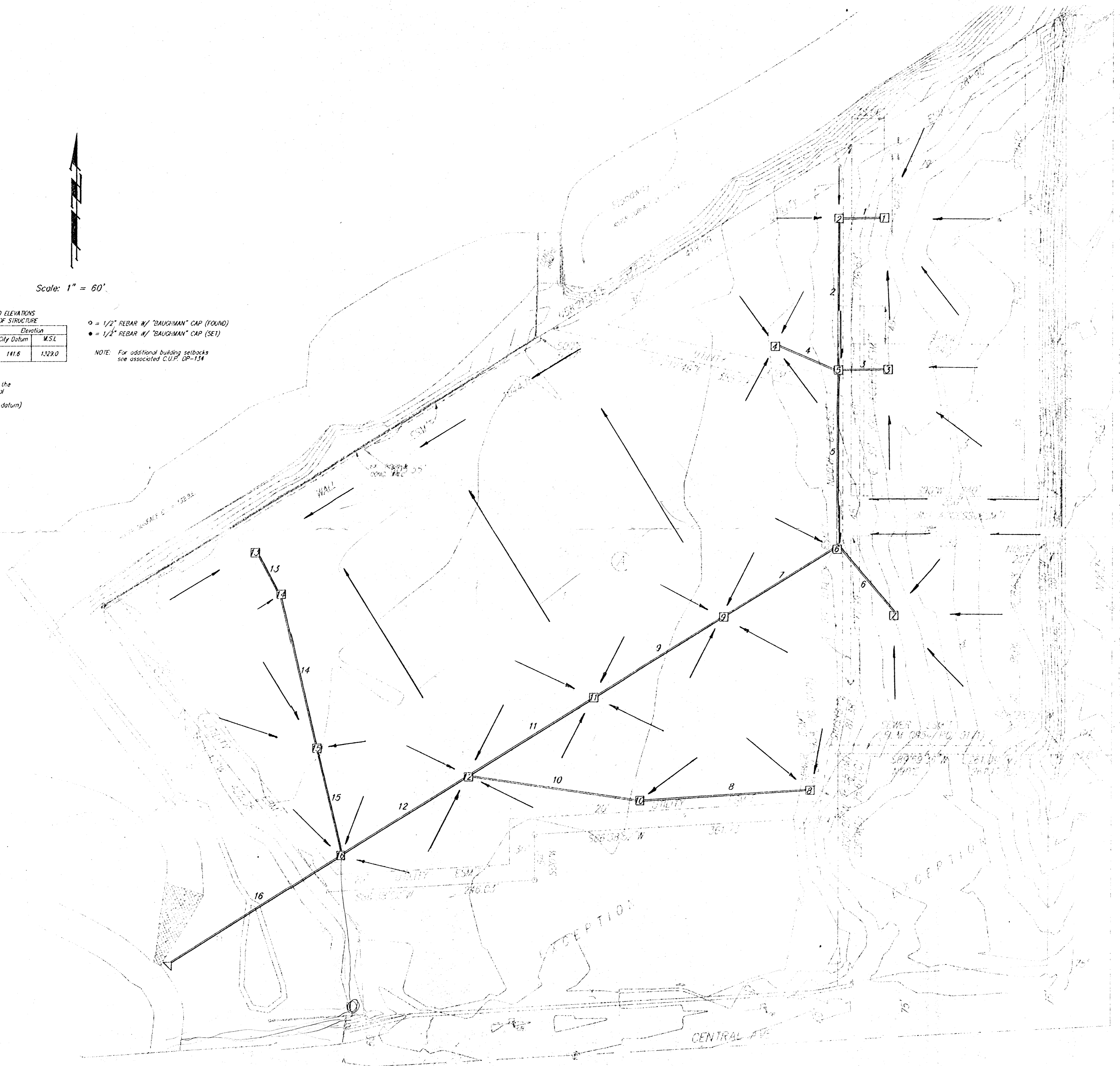

Node	Area (Acres)	Q5 (cfs)	Q100 (cfs)
1	1.94	7.95	12.20
2	0.7	0.41	0.68
3	1.03	4.23	6.83
4	1.38	5.69	9.13
5	0.1	0.41	0.68
6	0.3	1.23	1.98
7	1.49	6.11	9.88
8	0.8	2.05	3.32
9	0.8	2.05	3.32
10	0.8	2.05	3.32
11	0.8	2.05	3.32
12	0.77	3.16	5.11
13	4.28	17.48	28.28
14	0.08	0.21	0.33
15	0.69	2.83	4.58
16	0.28	1.15	1.88

Pipe No.	Q (cfs)	Pipe Size (inches)	A (sq. ft)	R (ft)	Slope (ft/ft)	Length (ft)
1	7.95	21	2.409289	0.4375	0.005018	58
2	7.96	21	2.409289	0.4375	0.004875	180
3	4.23	18	1.227189	0.3125	0.004458	60
4	5.69	30	1.78715	0.375	0.004419	80
5	18.28	30	4.90875	0.825	0.004378	220
6	6.11	18	1.78715	0.375	0.007483	100
7	26.81	36	7.0688	0.75	0.007483	200
8	2.05	15	1.227189	0.3125	0.003268	180
9	27.68	36	7.0688	0.75	0.003799	180
10	4.10	18	1.78715	0.375	0.003911	210
11	29.71	36	7.0688	0.75	0.004383	180
12	38.98	36	7.0688	0.75	0.004787	180
13	17.48	30	4.90875	0.825	0.004012	60
14	17.89	30	4.90875	0.825	0.004107	190
15	20.92	30	4.90875	0.825	0.005927	134
16	68.85	48	12.8684	1	0.003681	248

TIMBER GROVE 2ND ADDITION
DRAINAGE PLAN
WICHITA, SEDGWICK COUNTY, KANSAS

BAUGHMAN COMPANY P. A.
ENGINEERING & SURVEYING
316-282-7271 • 315 ELLIS • WICHITA, KANSAS 67211

PROJECT NUMBER

DESIGN	DRAWN	APPROVED	DATE	SCALE	SHEET
NBH/DS	DS		6-24-94	1"=60'	1 OF 1