

10-1-80
Advised that area will be a residential. Must insure that it is to be a dry hole.

10-2-80
Advised that area will be Highway responsibility of Home Owners Assoc. per G. Wiley.

Discussion with raised medial impairment of flow of traffic.

↓ Corbitt - Objection of planning dept. on having 4 lots with direct access to Rock Road.

PRELIMINARY PLAT OAK KNOLL INDUSTRIAL PARK ADDITION

OWNER/DEVELOPER: AMERICAN LAND DEVELOPMENT CO., INC.
ENGINEER: PROFESSIONAL ENGINEERING CONSULTANTS 1440 English Wichita Ks.
AUGUST, 1980

- Gas - 8" H.P. Gas Main (Gas Service) on south side of Pawnee + going east. 18" H.P. Gas Main (City Service) on Rock Road from Pawnee to McConnell Air Force Base.
- Power - 12.5KV. 3Ø.4 Wire (K.G.F.E.) on East line of Rock Road from Pawnee to McConnell Air Force Complex.
- Water - 12" A.C. Water Main (City of Wichita) 13' W of E 12 up to 1300' S of E of Pawnee.
- San Swr - Proposed
- Telephone - Proposed
- Prelim St. grades - See Drainage Plan

Topo: June 6, 1978, M.S.L.
BM = 188.25 City of Wichita Bench Mark Disc, 62'E + 53' N. E. Rock Road + Oak Knoll Road

Notes: For proposed Street Grades See Drainage Concept.
Area to be annexed to City of Wichita.

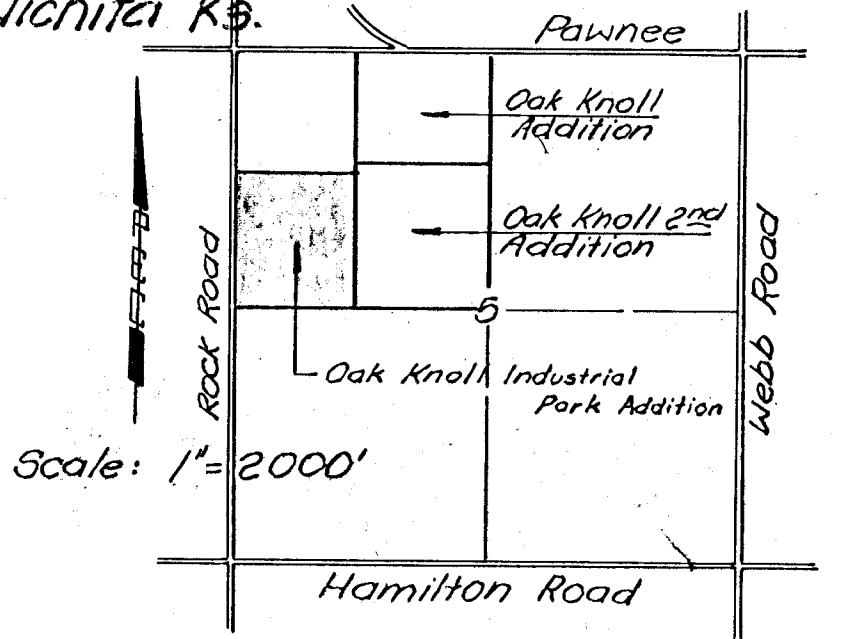

Oak Knoll Industrial Park Addition
Received SEP 2 1980